

Anchorage Association for the Education of Young Children

The Power of Play: Building for the Future

38th Annual Early Childhood Conference



**Conference
Program**

**February 6-9, 2019
Hilton Anchorage Hotel**

aaeyc

Anchorage Association for the
Education of Young Children

www.anchorageaeyc.org



Anchorage Association for the Education of Young Children

Since 1971, Anchorage AEYC has worked to:



Promote Public Support & Policies

- Advocacy
- Outreach
- Public Awareness

Support Excellent Early Education

- Accreditation
- Position Statements
- Professional Development



Build a Profession

- Inclusive
- Leadership Development
- Standards
- Equitable Compensation



Improve Teaching & Learning

- Professional Preparation
- Research
- Resources



Being a member of NAEYC,
gives you the opportunity to be a member of one or all three of the Alaska affiliates.

National

National Association for the Education of Young Children (NAEYC)

PO Box 97156

Washington, DC 20090

Website:

www.naeyc.org



Local Alaskan Affiliates

Anchorage AEYC

E-mail: anchorageaeyc@mtaonline.net

Website: www.anchorageaeyc.org



Northern Interior Alaska AEYC (NIA-AEYC)

Website: www.niaaeyc.org

Email: niaaeyc@gmail.com



Southeast AEYC

E-mail: info@aeyc-sea.org

Website: www.aeyc-sea.org



WELCOME to AAEYC

2018-19 Anchorage AEYC Board of Directors

President: Rachel Ragula

President Emeritus: Chris Jurenka

Secretary: Lynette Cooper

Treasurer: Brandy Graham

Member Coordinator: Cecilia Harmon

Members at Large: Tracy Breimo,
Jessica Gardner

Professional Development: Issa Camahuali

Program Quality: Anna Castillo

Public Policy: Margaret Bauer

Liaisons: Thread—Mildred Parker

For Information on Anchorage AEYC & Services:

Phone: 907-696-5884

E-mail: anchorageaeyc@mtaonline.net

Website: www.anchorageaeyc.org

Facebook: [Facebook.com/AnchorageAEYC](https://www.facebook.com/AnchorageAEYC)

About Us

The Anchorage Association for the Education of Young Children (AAEYC or Anchorage AEYC) is a professional membership organization that works to promote high-quality early learning for all young children, birth through age 8, by connecting early childhood practice, policy, and research. We advance a diverse, dynamic early childhood profession and support all who care for, educate, and work on behalf of young children.

Anchorage AEYC is an affiliate of the National Association for the Education of Young Children (NAEYC). In Alaska, there are three local affiliates—AAEYC (Anchorage AEYC), SEAAEYC (Southeast AEYC) and NIAAEYC (Northern Interior AEYC).



www.naeyc.org/membership

Volunteer Conference Committee Members

Conference Chairs:
Brandy Graham & Anna Castillo

Committee Members:

Alissa Harris
Kayla Hayes
Christy Knight
Neva Lancaster
Bonnie Monson
Mildred Parker
Hilary Seitz
Jen Clark

Conference Coordinators:
C&C Services
Cecilia Harmon & Christie Holshouser

Discover the NAEYC Experience

Get connected and discover what the new NAEYC can do for YOU! Joining NAEYC and your local affiliate (AAEYC, SEAAEYC, NIAAEYC) is about more than just a membership card—it's about being part of something larger. **It's an experience.**

During the 2019 AAEYC Annual Conference, stop by the AAEYC Membership Room (Dillingham) where AAEYC Board & Committee members will be available to answer any questions you may have and discuss how you can get the most from your new and improved membership experience.

Whether you want to learn more about play, take on a leadership role, dive into public policy and advocacy, advance your career through professional development, or connect with NAEYC's new digital Interest Forum platform, Hello, we will be available to discuss how NAEYC can help you advance your professional goals. We can walk you through the suite of membership benefits, including subscriptions to award-winning journals and publications, discounts as a member you will receive and much more! Stop by and say hello.

WELCOME to the conference

The Power of Play: Building for the Future **at Anchorage AEYC's Annual Conference**

Celebrating 38 years of bringing dynamic professional development, keynotes & featured speakers to Alaska.

The Anchorage Association for the Education of Young Children Board (Anchorage AEYC) and Anchorage AEYC Conference Committee would like to welcome you to the 2019 Anchorage AEYC Early Childhood Conference, "The Power of Play: Building for the Future" February 6-9, 2019 at the Hilton Anchorage Hotel. We are thrilled to have you joining us whether it's for one day or the full 4 days of the Conference. The time you dedicate to attending the key notes and workshops demonstrates the commitment that you have to your ongoing professional development and to the children and families in your community.

We'd like to give you an idea of what you can expect and what we hope you gain from this 4-day conference.

- The 2019 guest speakers are Cate Heroman, Ron Mohl, Father Michael Oleska, Dr. Peg Oliveira, Keith Pentz, and Melanie Potock. See their bio's inside this booklet.
- There will be a silent auction on Thursday, Friday & Saturday of the conference. Please check out the auction each day as new materials will be auctioned off. All of the proceeds go to the Anchorage AEYC Early Childhood Education Scholarships Fund. Scholarships are offered semiannually to assist Anchorage AEYC members who are pursuing a degree or certificate in Early Childhood in the state of Alaska as well as to any members who wish to attend an early childhood conference either in Alaska or out of state.
- Another fundraiser for the AAEEYC Scholarship Fund—an Alcohol Ink Painting Party- will be held on Friday, February 8th at the 49th State Brewing Company, 6:00-9:00 pm. Additional Cost \$ 35 plus meal cost.
- There will be a NAEYC members only room during the conference. We will have drawings throughout the day in the members room along with snacks. There will also be information about the Anchorage AEYC Board members/positions and the Conference Committee roles. We are currently recruiting for board and committee members, so please stop by if you are interested in signing up or learning more about the board and committee roles.

Hundreds of Early Childhood Professionals will come together bringing unique backgrounds and different experiences. This collaboration gives us opportunities to make new connections and come away with rich ideas, strategies, and reflection's that will positively impact the work we do with young children and their families within our communities.

We want to thank all of the State-wide Early Childhood Programs in attendance for joining us.
Best wishes to everyone for a memorable, inspiring, and enriching conference!

Anna Castillo and Brandy Graham,
Conference co-chairs

Please remember
to wear your
AAEYC Conference
name badge!

Conference bags provided by:



Download your
Conference photos!

Stay connected,
share photos and
status updates.

#aaeyc2019conference



Sponsoring Partners

Anchorage AEYC Board of Directors and Conference Committee members thank the partnering conference sponsors in recognition of their generous financial support of this event. Please let them know how much their support means to Alaska's children, families, communities and you as an educator.



Anchorage Association for the Education of Young Children

Anchorage Association
for the Education of
Young Children
www.anchorageaeyc.org



State of Alaska Education &
Early Development
www.education.alaska.gov



thread
www.threadalaska.org



The Alaska Mental Health Trust
Authority
www.mhtrust.org



Playful Learning Pediatric
Therapy, LLC
www.playfulllearningtherapy.com



AIR Child Care Training Solutions
www.airchildcare.org



BEST BEGINNINGS
Alaska's Early Childhood Investment

Best Beginnings
www.bestbeginningsalaska.org



Sandbox Software
www.sandboxsoftware.com



Lakeshore
www.lakeshorelearning.com



Kaplan Early Learning Company
www.kaplanco.com



Early Intervention/Infant
Learning Program
www.dhss.alaska.gov

Anchorage AEYC Mission

Anchorage AEYC promotes high-quality early learning for all children, birth through age 8, by connecting practice, policy and research. We advance a diverse, dynamic early childhood profession and support all who care for, educate, and work on behalf of young children.

2019 Schedule of Events

Tuesday, February 5, 2019

6:00 p.m.—7:30 p.m. Registration
6:30 a.m.—7:30 a.m. Volunteer/Host Class

Wednesday, February 6, 2019

7:30 a.m.—5:30 p.m. Registration
9:45 a.m.-11:45 a.m. Seminar Session
11:45 a.m.—1:15 p.m. Lunch On Your Own
1:30 p.m. - 3:00 p.m. Workshop Session
3:15 p.m.—4:45 p.m. Workshop Session

Thursday, February 7, 2019

7:30 a.m.—5:30 p.m. Registration
8:00 a.m.—9:30 a.m. General Session & Keynote: Ron Mohl
9:45 a.m.-11:45 a.m. Seminar Session
11:45 a.m.—1:15 p.m. Lunch on site
1:30 p.m. - 3:00 p.m. Workshop Session
3:15 p.m.—4:45 p.m. Workshop Session
5:00 p.m.—7:00 p.m. Continuing Education Credit Class & Registration - \$79 Additional Class Fee

Friday, February 8, 2019

7:30 a.m.—5:30 p.m. Registration
8:00 a.m.—9:30 a.m. General Session & Keynote: Cate Heroman
9:45 a.m.-11:45 a.m. Seminar Session
11:45 a.m.—1:15 p.m. Lunch on your own
1:30 p.m. - 3:00 p.m. Workshop Session
3:15 p.m.—4:45 p.m. Workshop Session
6:00 p.m.—9:00 p.m. Fundraiser for AAAYC \$35 additional fee
49th State Brewing Co— food at your expense
5:00 p.m.-6:45 p.m. Continuing Education Class Wrap Up

Saturday, February 9, 2019

New Schedule!

7:30 a.m.—1:00 p.m. Registration
8:00 a.m.-10:00 a.m. Seminar Session
10:15 a.m.—12:15 p.m. Seminar Session
12:15 p.m.—2:30 p.m. Lunch on site & Awards Ceremony
2:45 p.m.—4:45 p.m. Seminar Session

Conference Highlights

Keynotes & Featured Speakers



Cate Heroman

Friday Keynote: **Making, Tinkering & Engineering in Early Childhood: It's Serious Play!**
8:00 am-9:30 am General Session & Keynote

Cate Heroman is passionate about helping young children become successful learners and socially competent. She is an early childhood consultant with over 40 years in the field as a teacher, Louisiana state early childhood administrator, trainer, keynote speaker, corporate vice president and author. She has authored numerous early childhood publications including *The Creative Curriculum® for Preschool*, *Teaching Strategies GOLD®*, *Coaching to Fidelity*, *Building Your Baby's Brain*, *Helping Children Rebound* and more. She is especially interested in the maker education movement and is author of NAEYC's best-selling publication, *Making and Tinkering with STEM: Solving Design Challenges with Young Children*. Cate previously served as Board Chair of Knock Knock Children's Museum in Baton Rouge, Louisiana.

Cate will be presenting:

Friday, February 8th
1:30-4:45 **Making, Tinkering & Engineering in Early Childhood: It's Serious Play!**

Saturday, February 9th
8:00-12:15 **Tinker! Make! Innovate! STEM-Rich Learning in Early Childhood**

Brought to you by:



Anchorage Association for the Education of Young Children



Ron Mohl

Thursday Keynote: **Being a Partner in Play**
8:00 am-9:30 am General Session & Keynote

Ron Mohl, holds a B.A. from Florida Atlantic University and brings over 19 years of experience in the education industry to his position of Lead Educational Presenter for Lakeshore Learning Materials. Ron is a CLASS certified classroom observer for both Toddler and Pre-K classrooms. He has also studied at the Environmental Rating Scale Institute for ECERS-3 and ITERS. In this role, Ron has collaborated with school districts to enrich their scope of instruction and summer programs as well as public and private institutions to provide professional development related to curriculum including *Creative Curriculum* and *High Scope*. Ron's experience with Head Start programs spans across the country with keynotes in State, Regional and National Conferences. Ron has contributed educational strategies to military child development centers around the world including London, Italy, South Korea, and Japan.

By focusing on the importance of play in the learning process, Ron's interactive trainings help educators enrich curricula that relates to being a partner in play through authentic experiences with children.

Ron will be presenting:

Thursday, February 7th
1:30-3:00 **A Partner in Play with STEAM**
3:15-4:45 **A Partner in Play with STEAM**
(repeat of earlier session)

Friday, February 8th
9:45-11:45 **Enhancing the Learning Environment Classroom**
1:30-3:00 **A Partner in Play with STEAM**
3:15-4:45 **A Partner in Play with STEAM**
(repeat of earlier session)

Brought to you by:



If you could only sense how important you are to the lives of those you meet; how important you can be to the people you may never even dream of. There is something of yourself that you leave at every meeting with another person.

-Fred Rogers

Your opinion is important to us!

The AAEYC Annual Conference Evaluation will be emailed to all registrants at the end of the conference. We look forward to reviewing your feedback and comments.

Conference Highlights

Featured Speakers



The Reverend Dr. Michael James Oleksa has spent the last 35 years in Alaska, serving as village priest, university professor, consultant on intercultural relations and communications, and authoring several books on Alaska Native cultures and history. A 1969 graduate of Georgetown University and of St. Vladimir's Orthodox Theological Seminary, Father Oleksa earned his doctoral degree in Presov, Slovakia, in 1988. His four-part PBS television series, *Communicating Across Cultures*, has been widely acclaimed. The recipient of numerous awards from local, state and federal agencies, as well as the Alaska Federation of Natives, Father Michael has taught on all three main campuses of the University of Alaska system and at Alaska Pacific University as well. He currently resides in Anchorage with his Yup'ik wife, Xenia, his daughter Anastasia and one of his three grandsons.

Father Michael will be presenting:

Thursday, February 7th

9:45-11:45 *Communicating Across Cultures:
Understanding Your Story*

1:30-3:00 *Communicating Across Cultures: The Iceberg
Metaphor*

Brought to you by:



**The Anchorage AEYC
Board and Conference Committee**

are looking for professionals in the field
who are interested in serving on our board and committees.

Please stop by the Anchorage AEYC Membership
room to talk to a board or committee member
or send an e-mail to anchorageaeyc@mtaonline.net
to see how you can get involved!

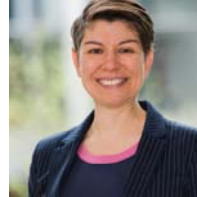

Dr. Peg Oliveira is the Executive Director of the Gesell Institute of Child Development. She is a developmental psychologist with a career in advocacy and social activism, specifically on issues of affordable child care, fair pay and paid

family leave. As a psychology undergraduate Dr. Oliveira worked in a Bridgeport Head Start site, an experience that set her on the path of researching and advocating for essential improvements in the early care and education system. Currently, as the Executive Director of the Gesell Institute of Child Development, Peg designs professional development content and training that have a direct and immediate impact on how educators see and teach children.

Dr. Oliveira received her doctorate from Brandeis University and began her career as a policy fellow with CT Voices for Children. For 17 years Peg has worked with state agencies, nonprofit advocacy coalitions and local initiatives to ensure that all children get a high quality early learning experience.

In addition Dr. Oliveira participates in numerous community initiatives including serving on the Board of Directors of Calvin Hill Day Care Center. Dr. Oliveira is also a beloved yoga teacher in her hometown of New Haven, and founded a non-profit yoga service organization called 108 Monkeys.

Dr. Oliveira will be presenting:

Wednesday, February 6th

1:30-3:00 *Building Brains Playfully*

3:15-4:45 *When to Play and When to Get Out of the Way*

Thursday, February 7th

1:30-3:00 *Building Brains Playfully*

Friday, February 8th

9:45-11:45 *When to Play and When to Get Out of the Way*

Saturday, February 9th

8:00-10:00 *When to Play and When to Get Out of the Way*

10:15-12:15 *Building Brains Playfully*

Brought to you by:



Anchorage Association for the
Education of Young Children

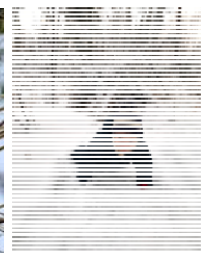

Conference Highlights

Featured Speakers



Keith L. Pentz, National Early Childhood Specialist for Kaplan Early Learning Company, has been in the field of education for almost 39 years. Keith began his career by working in childcare with infants and toddlers. Later, he taught elementary students as well as Kindergarten. Keith spent the remainder of his classroom time teaching PreKindergarten and working specifically with low socio-economic and diverse families as well as inclusion students. Following his experiences in the classroom, Keith moved on to teach at the University of Central Florida in Orlando, Florida, and he also was an Assistant Professor of Early Childhood Education at Gordon College in Wenham, Massachusetts.

With a real passion for quality early childhood education, Keith works for educational reform, creating positive teaching and learning models, and applying best practices, always with the child as the central focus.

Keith has degrees from Messiah College, Grantham, Pennsylvania (BA in Music), the University of Central Florida, Orlando, Florida (MA in Elementary Education), and post-graduate/doctoral studies in early childhood education curriculum and instruction from the University of Central Florida.

Keith will be presenting:

Thursday, February 7th

- 9:45-11:45 Things Every Child with Autism Wishes You Knew
- 1:30-3:00 The Role of Language in Establishing a Foundation for Infant & Toddler Cognitive
- 3:15-4:45 Purposeful Engagements: Supporting Young Learners with Meaningful Interactions & Intentionality

Friday, February 8th

- 9:45-11:45 What To Do When You Don't Know What to Do
- 1:30-3:00 Going Beyond Behavior Management: Prevention vs Intervention
- 3:15-4:45 Making the Body-Brain-Mind Connection In Teaching and Learning

Saturday, February 9th

- 8:00-10:00 Constructively Meeting 10 Challenges of Working with Infant, Toddlers & Two's
- 10:15-12:15 Cuddling, Consciousness & Cognition: The Significance of Emotional Engagement of Development & Learning
- 2:45-4:45 Playful Explorations: Building a Foundation For Development and Learning

Brought to you by:



Anchorage Association for the Education of Young Children



Melanie Potock, MA, CCC-SLP is an international speaker on the topic of feeding babies, toddlers and school-age kids. She is the co-author of the award-winning Raising a Healthy Happy Eater: A Stage-by-Stage Guide to Setting Your Child on the Path to Adventurous Eating (2015) and Baby Self-Feeding: Solutions for Introducing Purees and Solids to Create Lifelong Healthy Eating Habits (2016). The tips in her latest book, Adventures in Veggieland: Help Your Kids Learn to Love Vegetables with 100 Easy Activities and Recipes (2018) are based on the latest research and Melanie's 20 years of success as a pediatric feeding therapist. Melanie's advice has been shared in a variety of television and print media, including The New York Times, CNN.com, Huffington Post and Parents Magazine.

Visit her at www.MelaniePotock.com for more articles, professional tips, and helpful videos to raise your adventurous eater!

Melanie will be presenting:

Wednesday, February 6th

- 8:00-4:45 Parenting in the Kitchen: Home Strategies for Families in Feeding Therapy
(NOTE: EI/ILP folks only/lunch included)

Thursday, February 7th

- 9:45-4:45 The Stacking Model: How Feeding Disorders Develop
(NOTE: EI/ILP folks only)

Brought to you by:



Won't You Be My Neighbor?

In *Won't You Be My Neighbor?*, Academy Award-winning filmmaker Morgan Neville looks back on

the legacy of Fred Rogers, focusing on his radically kind ideas. While the nation changed around him, Fred Rogers stood firm in his beliefs about the importance of protecting childhood. Neville pays tribute to this legacy with the latest in this highly engaging, moving documentary portrait of an essential American artist.

- | | | |
|-------------------------|-----------|--------|
| Wednesday, February 6th | 3:15-4:45 | Katmai |
| Thursday, February 7th | 3:15-4:45 | Aspen |
| Friday, February 8th | 3:15-4:45 | Birch |
| Saturday, February 9th | 2:45-4:45 | Birch |

General Conference Information

General Sessions

All General Sessions will be in the Aleutian/Alaska Ballrooms.

Official Conference Badge/Nametag

Please wear your conference badge at all times, not only as a courtesy to other attendees but also as an indicator that you are registered. Badges must be worn to grant access to sessions and for lunches.

Meals

A breakfast snack with coffee is available each morning 7:30-8:00 am. Lunch on Thursday and Saturday are included in your conference registration. Your name-tag is your ticket for the luncheons.

The Anchorage AEYC Early Childhood Conference strives to:

- ★ Provide educational opportunities and resources to those who work with and on behalf of young children and families.
- ★ Promote inclusive attitudes and practices and to support awareness of diversity issues.
- ★ Support partnerships, networking and collaboration between educators, families, providers, schools, agencies and the community.
- ★ Provide an engaging high quality learning experience with sessions designed for professionals who are emerging; established and experienced.

Program Changes

Workshop changes and cancellations will be posted at the Registration Table. Please check for updates throughout the conference. While we make every effort to minimize these changes, they are unavoidable, and we ask for your understanding.



Emergency/Safety

Should an emergency arise during the course of the conference, we will utilize the approved plan in place at the Hilton Anchorage for security, evacuation and medical purposes.

Conference Tracks

Conference tracks have been identified to assist you in identifying sessions most pertinent to your professional needs or work. Sessions are categorized by their most dominant theme and tracks are organized around the ten standards for quality programs as identified by NAEYC.

They include:

- Relationships
- Curriculum
- Teaching
- Assessment
- Nutrition and Health
- Teaching Staff
- Family Relationships
- Community Relationships & Collaborations
- Physical Environment
- Management

Workshop Titles & Descriptions

Workshop titles & descriptions are written by the workshop presenters. Therefore, they should reflect the content of the session.

While Anchorage AEYC entertains and accepts differences of opinion, we do not necessarily endorse the products or views expressed by speakers. Anchorage AEYC urges conferees to contact individual exhibitors and/or presenters about any concerns and objections they may have about products, services, or practices. The Association also encourages that conferees extend their compliments to presenters/and or exhibitors whom they feel have provided a product or presentation of exceptional quality.

No person shall, on the grounds of race, creed, color, national origin, sex, sexual orientation, marital status or the presence of any sensory, mental or physical handicap, unlawfully be excluded from participation in, be denied the benefits of, or be otherwise subjected to discrimination under any activities performed pursuant to the conference or as an Anchorage AEYC member.

Parking

Parking is limited downtown.

Hotel Parking

- ♦ Overnight Valet for Hotel Guests is available for \$24.00 per day.
- ♦ Day only Valet parking for attendees is available for \$16.00 per day.

Parking charges for guests can be posted to your guest room folio and paid at the end of your stay.

Overflow Parking

Lot 12 located at the corner of E St. and 3rd Ave.

Parking is available at Lot 12 (The Saturday Market Lot) for \$1.00 per hour and can be paid for at the parking kiosk located in the parking lot.

All parking for both the Hilton Valet and Lot 12 are based upon first come first serve basis and subject to availability.

Workshop Capacity

Facility Capacity

We offer a large selection of workshops with plenty of seating during each time slot. Seating for all sessions is on a first come, first serve basis. Seating may be limited due to the desire of the presenter, content of the session and size of the room. Because of this, we suggest selecting two or three workshops per session in the event your first choice is full. Workshop Volunteers/Host will monitor seating capacity and deny entrance once a room reaches maximum capacity. Please honor the Closed Session signs. In compliance with fire code regulations set forth by the Municipality of Anchorage, overflow seating on the floor or in the aisles of meeting rooms or hallways is not permitted. Remember this is for your safety as well as everyone else. We apologize for any lost opportunity.

General Conference Information

Conference Etiquette

With an average of 500 attendees, a successful Anchorage AEYC Annual Conference requires that we extend professionalism and courtesy to one another. The following tips may make for a more pleasant learning environment for all:

- Use this Program to plan your schedule.
- Select an alternate in the event of session being at capacity or a cancelation. Conference Volunteers must close a workshop when all chairs are occupied (full capacity) to conform to fire code regulations.
- Arrive early, but do not block other participants exiting a meeting room.
- Participants are encouraged to share materials (especially folks from the same program) and to refrain from taking more than one copy of handouts (even of the best ideas!).
- Turn off or silence all cell phones.
- If it is necessary to leave a session early, or arrive late, make the interruption as non disruptive as possible.
- It's wonderful to catch up with our colleagues but please not while speakers are addressing the group. Others are trying to hear what is being said.
- We know that infants may need to stay close to their mothers. If your baby becomes inconsolable, we ask you to respect the needs of others and to go to a quiet area to relax until your infant is settled.
- Bring business cards for networking and requesting materials from presenters.
- Extend to others the courtesy you would like to experience.

Dress Code

Temperatures will vary greatly from room to room. No matter what, meeting rooms are always too cold for some and too warm for others. You are strongly encouraged to dress comfortably and in layers to accommodate the sometimes fluctuating facility temperature and your personal thermostats.

Electronic Devices

In order to provide a positive learning environment for participants and as a courtesy to speakers, all cellular and paging devices will need to be set on the silent mode or turned off during the conference.



University of Alaska announces a Continuing Education Credit Class: AAEYC Conference 2019

Where: Prince William Board Room
When: February 6-9, 2019
Cost: \$79.00 in addition to Conference registration fee

Course Requirements:

1. Attend face to face meeting on Thursday, February 7th from 5:00 – 7:00 pm
 - A. Administrative – Register and pay for course (\$79)
 - B. Introductions
 - C. Explanation of course requirements
2. Attend face to face meeting on Friday, February 8th from 5:00 – 6:30 pm
 - A. Reflection – Share, show and tell
3. Documentation of at least 15 contact hours through AAEYC conference – submit copy of conference certificate (= at least two full days of conference and our two face to face meetings)
4. Write a brief summary of each session attended, to include key notes
5. Write an in-depth summary of one session that is at least one page in length and includes:
 - A. The key message(s) you took from the session
 - B. Relate how the Alaska Early Learning Guidelines fits with the content of the session.
 - C. At least one idea that stood out to you from the session and how you can apply it to your program
 - D. Any additional resources you may need to learn more or to assist you to apply the new idea.

\$79 Registration fee is paid directly to UAA either online or at the class on Thursday, February 7th.

On-site Registration will be at the Thursday Evening Class Session or you may register online. For additional information, e-mail Sydney Singer at ssinger@threadalaska.org or visit: www.anchorageaeyc.org.

Credit Course Disclaimer

Conference registration does NOT include credit courses. The credit course registration fee is \$79 and must be paid on Friday during the class or call for student enrollment assistance (Sally or Katie) at 786-1934 or toll-free 1-888-828-8974. Payments can be made by credit card or check (payable to UAA).

UAA is an EQ/AA employer and educational institution.

Alaska Early Learning Guidelines can be found at: www.eed.state.ak.us/publications/EarlyLearningGuidelines.pdf

Certificates of Participation

Each conference attendee has a Certificate of Participation in their conference folder. Credit for attending is granted through the issuance of session stickers (labels). At the conclusion of each session you attend, the presenter (or volunteer) will give you a label. You will need to place this label in the corresponding box on your Certificate of Participation. This certificate becomes your proof of attendance as no other documentation will be provided.

TR, PDR & SEED Information

For information on: Travel Reimbursement (TR) or Professional Development Reimbursement (PDR) and SEED Registry visit www.seedalaska.org and follow instructions carefully.



Denotes presentations that have been pre-approved by the Alaska System for Early Education Development (Alaska SEED).

Anchorage AEYC Early Childhood Education Scholarships



Ms. Lare'

The Anchorage AEYC Scholarships are offered quarterly to assist early childhood educators and providers who are pursuing a degree or certificate in Early Childhood in the state of Alaska as well as to providers who wish to attend any early childhood conference either in Alaska or out of state. Applications for the Anchorage AEYC Early Childhood Education Scholarship are available now on the Anchorage AEYC website:

www.anchorageaeyc.org

Funds from the Silent Auction support this scholarship. There will be items in the Silent Auction for you to bid on each day of the conference as well as items that are bid on until Saturday.

The Early Childhood Education Scholarship began in honor of the late Ms. Lare', a long time public policy advocate on behalf of young children, their families and the individuals who worked with them on a daily basis. She was a past Anchorage AEYC board president & member of the board of directors, member on many NAEYC committees, chair of the Anchorage AEYC conference committee, a mover and shaker for KidPack, sat on the Child Care Alliance committee and a strong supporter of Head Start.

Congratulations 2018 Scholarship Recipient:

Heather Foxworthy



Now in my fourth program year as a home visitor, I have the privilege of joining families in their daily walk through the Parents as Teachers (PAT) program. After leaving the world of accounting, I switched career fields altogether, becoming an elementary music teacher, then a preschool teacher for Kodiak Christian School, and completed my Bachelor's of Arts in 2008. While working for Kodiak Bible Chapel as the director of children's programming I completed my Master's Degree from Wayland Baptist University in 2012. Home visiting has allowed me to take my favorite aspects of my previous positions, blend them with my love of learning, and help families in Kodiak be the best parents they can be. I would like to thank the members of AAEYC for providing scholarships opportunities to attendees like me who would otherwise not be able to travel from more rural areas of Alaska. Together we build healthier families which then build healthier communities.

The Anchorage AEYC Early Childhood Scholarship applications are due:
December 31st, March 31st, June 30th & September 30th.

Selection criteria includes: Successful completion of the application, transcripts, resume, two letters of recommendation, interview, and current membership in Anchorage AEYC.

The Anchorage AEYC Early Childhood Scholarship can be downloaded from the Anchorage AEYC website:

www.anchorageaeyc.org

In Remembrance—Betty Robards



Betty Robards

January 7, 1961-
May 19, 2018

Being a mom and grandma were her favorite roles in this life and she could not have done them better. She loved her children and grandchildren to the moon and back; her love was contagious and she lives on through that love.

Her life's work was to help people in a way that enriched each individual way of being healthy and happy, while advancing overall well-being. Betty was a member of the American Psychological Association, Alaska Psychological Association, Association for Play Therapy

and a life member of National Association for the Education of Young Children. She graduated with a Bachelor of Science in Psychology and Master of Science in Clinical Psychology from University of Alaska Anchorage.

Born in Corvallis, Ore., Betty grew up in Juneau, Alaska. She graduated from Juneau Douglas High School in 1979. In the early 80s, she attended Spokane Community College and Lower Columbia College, studying early childhood education, as well as home and family life.

In December 1990, a single mom, she moved the family to Anchorage. For 25 years, she directed early childhood care and educational centers both in Anchorage (Anchor Luther-

an School) and for Tautle Lake School District in Washington state. She was a life member of NAEYC and very active in the Anchorage Director's group. She then became Director of Alaska and New Mexico Medicaid Behavioral Health Services and started a private practice where she provided mental health services.



She enjoyed working hard to play hard. This included weekend trips in "Towanda" (the family's 1995 Winnebago Warrior motorhome) to find quiet lakes where they could spend the day; trips to Hawaii to hang out with her children, the Sarbers, and the sea turtles; entertaining guests for long evenings of playing cards; baking in her new kitchen; and the occasional family trip to the casino.

Wednesday, February 6, 2019

AGENDA IN DETAIL

7:00-5:00	REGISTRATION/CHECK IN/INFORMATION DESK OPEN	Promenade
9:30-5:00	NAEYC/LOCAL ALASKA AFFILIATES MEMBER LOUNGE	Dillingham
	For NAEYC members—their very own member lounge! Become a member now and join us! Members are able to grab a snack, relax & network, have access to special giveaways and speak with Anchorage AEYC board & conference members. Convince a friend to become a member and receive an extra door prize ticket!	
8:00-4:30	EARLY INTERVENTION/INFANT LEARNING PROGRAM SESSION—EI & ILP folks only	
9:45-11:45	SEMINAR SESSIONS	
11:45-1:15	LUNCH ON OWN	
1:30-3:00	WORKSHOP SESSIONS	
3:15-4:45	WORKSHOP SESSIONS	
5:00-7:00	CONTINUING EDUCATION CREDIT CLASS AND REGISTRATION	Prince William
	Class requirements listed on page 10. Additional fee of \$79 for credit class.	

Wednesday: Sessions at a Glance

NAEYC STANDARD	LEVEL	AGE GROUP	WORKSHOP TITLE & DESCRIPTION	PRESENTER(S)	CAPACITY	ROOM
Wednesday, February 6, 2019 8:00–4:30						
Health	Across Levels	Birth-3	Parenting in the Kitchen: Home Strategies for Families in Feeding Therapy This seminar is jam-packed with the tools that professionals need to help parents. So often, kids learn to eat well in the therapy setting, but parents cannot achieve carry-over at home. Learn counseling techniques and specific tools that set parents up for success. Lack of carry-over is reported to be the #1 frustration for both parents and professionals! As one audience member put it, “Coach Mel is in the trenches, treating kids and teaching. She understands what it takes to support families who have difficulty generalizing clinical strategies to the home.”	Melanie Potock, MA, CCC-SLP Author, International Speaker, Pediatric Feeding Therapist, My Munch Bug, LLC, Longmont, Colorado	135	Aleutian/ Alaska
Wednesday, February 6, 2019 9:45–11:45						
Leadership & Management 	Across Levels	Birth-3 3-5 5-8 School-Age	Learn and Grow—Level 1 This training will provide an introduction to Learn and Grow and what this means for you and your program. This session will review the quality standards, how your programs can move through the various levels of quality and what supports are available for you and your program. Recommended for program administrators/directors.	Vanessa Plourde-Smith, Professional Development Associate thread, Anchorage, Alaska vsmith@threadalaska.org	50	Katmai
Teaching 	Across Levels	Birth-3	That Bites! Teething and Biting Biting is a typical behavior of infants and toddlers who use their mouth and teeth to explore the world that is new to them. This session will address some of the reasons young children bite and review strategies to decrease biting in the classroom.	Sarah Wright, Professional Development Specialist thread, Anchorage, Alaska swright@threadalaska.org Sydney Singer, Professional Development Specialist thread, Anchorage, Alaska ssinger@threadalaskas.org	40	Aspen

Please Be Courteous

Shhhhhh!

It's wonderful to catch up with colleagues but please not while speakers are addressing the group.



Wednesday: Sessions at a Glance

NAEYC STANDARD	LEVEL	AGE GROUP	WORKSHOP TITLE & DESCRIPTION	PRESENTER(S)	CAPACITY	ROOM
Wednesday, February 6, 2019 9:45-11:45						
Curriculum	Emerging	3-5	Make it, Take it: Literacy & Math Activities for Young Children Come engage in a café style round table discussion on Literacy & Math in Early Childhood. You'll make literacy activities that can be used to help preschool and kindergarten children gain the language and literacy skills necessary to become readers and writers. You will also make a mathematical activity that can be used to help children gain mathematical thinking skills and other math related skills. Be prepared to reflect on ways that the activities can be implemented within your classroom setting.	Anna Castillo, Site Manager, CU1 Little 1's Learning Center, Anchorage, Alaska castilla@cu1.org Kayla Hayes, Lead Mentor Teacher, CU1 Little 1's Learning Center, Anchorage, Alaska Hayesk@cu1.org	25	Spruce
Teaching	Across Levels	Adult Learners	Playing with Sounds and Word: Utilizing Culturally Responsive Practices Come play with sounds and words as you deepen your understanding of the developmental levels of phonological awareness: word, syllable, onset-rime, and phoneme. During this interactive workshop you will have the opportunity to develop culturally responsive activities that will boost your students phonological awareness, while we explore Alaska Children's Literature and utilize responsive Alaska themed alphabet cards.	Esther Pepin, Early Learning Coordinator, Bristol Bay Borough School District, Naknek, Alaska epopin@bbbsd.net	40	Birch
Wednesday, February 6, 2019 1:30-3:00						
Curriculum	Across Levels	Across Age/Grade Spans	FREE STEM KITS to Promote Learning Learn how to enhance a child's mind with any of the 15 FREE STEM kits Civil Air Patrol Offers. Participants will learn how to obtain FREE STEM kits and curriculum as well as what new programs are available to youth. During the workshop we will have STEM make and takes to share with your students. This workshop is repeated on Saturday, 2:45-4:45 in the Katmai/King Salmon Room.	Lynda MacPherson, Director of Aerospace Education/STEM, AK Civil Air Patrol, Wasilla, Alaska Lynda.macpherson@akwg.cap.gov	50	Katmai
Teaching	Across Levels	Across Age/Grade Spans	Building Brains Playfully How is brain development and ultimately learning impacted by play? This workshop unpacks the latest science on the relationship between play and brain growth. Importantly, we will investigate the undeniable importance of pretend play in the growth and development of young children, in multiple domains, including executive function. This workshop is repeated: Thursday, 1:30-3:00, Birch Room and Saturday, 10:15-12:15, Katmai/King Salmon room.	Peg Oliveira, PhD, Executive Director, Gesell Institute of Child Development New Haven, CT peg@gesellinstitute.org	100	King Salmon, Iliamna
Curriculum	Across Levels	3-5	Leveraging Play in Informal Learning Environments to Support Early Childhood Development Come get an inside look at how the Anchorage Museum structures its toddler offerings to best leverage play in an informal learning environment for early childhood development goals. Try out four of the museum's hands-on activities designed for children ages 18 months to 5 years. Each activity is centered on a specific skill set important for young learners including sensory development, fine motor, and early math skills. We will also discuss how informal learning environments support soft skills in addition to curriculum content such as inquiry, socialization, comfort with new environments, and sensory exploration.	Grace Graham, Science Educator, Anchorage Museum, Anchorage, AK ggraham@anchagemuseum.org Christine Cassidy, Educator, Anchorage Museum, Anchorage, AK ccassidy@anchagemuseum.org	40	Spruce

Wednesday: Sessions at a Glance

NAEYC STANDARD	LEVEL	AGE GROUP	WORKSHOP TITLE & DESCRIPTION	PRESENTER(S)	CAPACITY	ROOM
Wednesday, February 6, 2019 1:30-4:45						
Teaching	Across Levels	5-8	Phonological Awareness if Child's Play Phonological awareness instructional routines. Phonological awareness basics and how to incorporate playful explicit and implicit phonological awareness instructional strategies during the instructional day.	Glenda Egli, Retired, Naknek, AK pebblesnnk@gmail.com	40	Birch
Wednesday, February 6, 2019 3:15-4:45						
Teaching	Across Levels	Across Age/Grade Spans	When to Play and When to Get Out of the Way Not all play is created equal. While unfettered exploration is essential to allowing children to grow important skills, so is adult-directed guidance and scaffolding. In this workshop we will describe the difference in play depending on the level and kind of adult involvement. Importantly, we will consider when adult initiated play is helpful to learning, and when it's time for adults to step back. This session is repeated: Friday, 9:45-11:45, Aleutian Room Saturday, 8:00-10:00, Aleutian Room	Peg Oliveira, PhD, Executive Director, Gesell Institute of Child Development New Haven, CT peg@gesellinstitute.org	100	King Salmon, Iliamna
Community Relationships	Across Levels	All	WON'T YOU BE MY NEIGHBOR? You're invited to re-discover the joy of Mister Rogers, and to screen the acclaimed film Won't You Be My Neighbor? for your community to help build connections between people and evoke Mister Rogers' values of compassion and kindness. In Won't You Be My Neighbor?, Academy Award-winning filmmaker Morgan Neville looks back on the legacy of Fred Rogers, focusing on his radically kind ideas. While the nation changed around him, Fred Rogers stood firm in his beliefs about the importance of protecting childhood. Neville pays tribute to this legacy with the latest in this highly engaging, moving documentary portrait of an essential American artist.	Facilitator: Anchorage AEYC Board or Conference Committee	50	Katmai



Five Best Toys of All Time

On the wired.com website, a staff writer explains a post about the 5 best toys of all time. "I understand that as parents we all have limited budgets and we sometimes need help narrowing down our wish lists. So to help you out, I've worked really hard to narrow down this list to five items that no kid should be without. All five should fit easily within any budget, and are appropriate for a wide age range so you get the most play out of each one. These are time-tested and kid-approved! And as a bonus, these five can be combined for extra-super-happy-fun-time."

Here are the five toys recommended as "best"

1. Stick
2. Box
3. String
4. Cardboard tube
5. Dirt



Source: <https://www.wired.com/2012/12/the-5-best-toys-of-all-time-2/>

Thursday, February 7, 2019



AGENDA IN DETAIL

7:30-5:00	REGISTRATION/CHECK IN/INFORMATION DESK OPEN	Promenade
7:30-2:55	SILENT AUCTION.....	Lobby down from Registration
	Participate in the silent auction. Not only will you come away with terrific items, you will be giving someone else the opportunity to attend the conference in the future. Proceeds support Anchorage AEYC scholarships fund.	
7:30-8:00	CONTINENTAL BREAKFAST	Alaska
7:30-4:45	VISIT THE EXHIBITORS	
8:00-9:30	OPENING GENERAL SESSION	Aleutian/Alaska
	KEYNOTE: Ron Mohl "Being a Partner in Play"	
	What intentional choices can we make with children to support their learning while being a partner in play? We will look at specific strategies that enrich being a partner in play through opportunities for discover, and actively participating in their play. As responsive partners in play, we will address the growth of the whole child while respecting them and their play.	
	Please remain seated until the session concludes. Premature departures disturb closing remarks and announcements considered important to other attendees. No workshop session will begin until the general session is over.	
9:30-5:00	NAEYC/LOCAL ALASKA AFFILIATES MEMBER LOUNGE	Dillingham
	For NAEYC members—their very own member lounge! Become a member now and join us! Members are able to grab a snack, relax & network, have access to special giveaways and speak with Anchorage AEYC board & conference members.	
9:45-11:45	SEMINAR SESSIONS	
11:45-1:15	LUNCH ON SITE	Alaska
1:30-3:00	WORKSHOP SESSIONS	
3:15-4:45	WORKSHOP SESSIONS	
5:00-7:00	CONTINUING EDUCATION CREDIT CLASS AND REGISTRATION	Prince William
	Class requirements listed on page 10. Additional fee of \$79 for credit class.	

Thursday: Sessions at a Glance

NAEYC STANDARD	LEVEL	AGE GROUP	WORKSHOP TITLE & DESCRIPTION	PRESENTER(S)	CAPACITY	ROOM
Wednesday, February 6, 2019 8:00-4:30						
Health	Across Levels	Birth-3	The Stacking Model: How Feeding Disorders Develop Often called the "mini" version of Mel's popular two day course, this 6 hour seminar is ideal for a mix of professionals and parents. Understand how feeding disorders can develop at any age when medical, sensory and motor challenges influence behavior. Learn practical tips to help toddlers to teens learn to enjoy a variety of food!	Melanie Potock, MA, CCC-SLP Author, International Speaker, Pediatric Feeding Therapist, My Munch Bug, LLC, Longmont, Colorado	100	King Salmon Iliamna
Thursday, February 7, 2019 9:45-11:45						
Relationships	Across Levels	All	Communicating Across Cultures: Understanding Your Story Cultures are "ways of seeing." Rev. Dr. Michael Oleksa's presentations are devoted to a discussion of cultures and how they affect us all, how our own culture focuses on certain aspects of reality and neglects others. In this workshop, he will speak about culture using three metaphors: "the way you see the world," "the game of life as you understand and play it," and finally at "the story into which you were born." Fr. Oleksa helps his audience perceive and honor their own cultural heritage while respecting and exploring the cultural background of others.	Reverend Dr. Michael Oleksa, Retired, St. Innocent Cathedral Diocese of Alaska, Anchorage, Alaska	100	Denali
Teaching	Established	3-5	Things Every Child with Autism Wishes You Knew The diagnoses, symptoms, and conditions surrounding children placed under the autism spectrum umbrella of identifying markers often seem to remove the "child" from the picture. While the medical and research communities continue to debate and investigate the definitions and causal factors related to autism, classroom teachers and parents struggle with how to best work with and promote the learning of children found to exhibit the characteristics of one (or more) of the many identified autism markers. This session will address specific strategies to be used with children who have been identified and placed under the autism spectrum. These strategies will address and focus on the individual child, verbal language, emotions, communication, sensory stimuli, and personal skills and abilities.	Keith L. Pentz, National Early Childhood Specialist, Kaplan Early Learning Company kpentz@kaplanco.com	50	Katmai

Thursday: Sessions at a Glance

NAEYC STANDARD	LEVEL	AGE GROUP	WORKSHOP TITLE & DESCRIPTION	PRESENTER(S)	CAPACITY	ROOM
Thursday, February 7, 2019 9:45–11:45						
Teaching 	Across Levels	Birth-3	That's Mine! Positively Guiding Toddler Behavior Toddlers have big emotions and behaviors! Positively supporting and guiding toddler's play/interactions shapes future learning capacities, behaviors, problem solving skills, sense of self, and emotional wellbeing. It also sets the stage for future relationships. As Early Childhood Professionals, we need to be experts in teaching children to resolve conflicts, using positive guidance strategies. This session will not instantly change your toddler's behavior but we will work on: our self-awareness and beliefs as early educators; making distinctions between personal and professional guidance; examining the common reasons toddlers engage in conflict; learning/reviewing toddler stages of play and developing personal/classroom plans of action.	Sydney Singer, Professional Development Specialist thread, Anchorage, Alaska ssinger@threadalaskas.org Sarah Wright, Professional Development Specialist thread, Anchorage, Alaska swright@threadalaska.org	40	Aspen
Leadership & Management 	Established & Experienced	Adult Learners	Get By with a Little Help From Your Friends—Find out About Peer Learning Networks in Alaska Is it lonely at the top? Are you looking for opportunities for your own professional development? Want to network with other early care and learning leaders? Then join us to find out about Peer Learning Networks and how to participate in one. In our session, you will: share your current needs and challenges; meet other early care and learning leaders; and gain knowledge about Peer Learning Networks and how they can support the work you are doing.	Donna Wade, Director of Outreach & Program Expansion, thread, Anchorage, Alaska dwade@threadalaskas.org Jen Clark, Director of Consultation thread, Anchorage, Alaska jclark@threadalaska.org	40	Lupine
Physical Environment	Across Levels	3-5	Can I Learn Here? Building Inclusive Learning Environments What does a child learn about your classroom when they first walk in? What is at their level? Is it safe and nurturing? Are they learning something new? Is it safe to explore? Is it predictable? We will discuss these questions and many more. Come ready to share about your space and brainstorm new ways to honor the children in your classroom, their developing brains and make an inclusive, predictable and learning focused environment. There will be a focus on meeting the needs of students with autism and other low-incidence disabilities, setting up for inclusive interactions with peers.	Aimee Smith, M.A. Autism Resource Specialist, Special Education Service Agency (SESA) Anchorage, Alaska asmith@sesa.org	40	Birch
			Networking/Collaboration Rooms If you would like to reserve either of these rooms to use for networking or collaboration please see Christie at the upstairs Registration Desk.		18	Prince William & Cook Inlet
Curriculum	Experienced	3-5	Creating Embedded Learning Opportunities in Play: We Can Make this Work This session focuses on understanding and applying the use of the evidence-based practice, Embedded Learning Opportunities, to support children with disabilities in inclusive preschool settings. Embedded learning opportunities (ELOs) are short teaching episodes that teachers set up within the context of everyday activities, routines, and transitions that address specific learning goals. In this session, you will learn how to identify specific instructional goals and begin plan for embedded instructions within their classroom setting.	Hattie Harvey, PhD Assistant Professor, University of Alaska, Anchorage Anchorage, AK haharvey@alaska.edu Beth Craig, Early Intervention Services Center, Anchorage School District, Anchorage, AK Craig_beth@alaska.edu Kimmer Ball, Preschool Instructional Coach, Anchorage School District, Anchorage, AK Ball_kimberly@asdk12.org	40	Spruce

Thursday: Sessions at a Glance

NAEYC STANDARD	LEVEL	AGE GROUP	WORKSHOP TITLE & DESCRIPTION	PRESENTER(S)	CAPACITY	ROOM
Thursday, February 7, 2019 9:45-11:45						
Assessment of Child Progress	Across Levels	Birth-3, 3-5	Talking About Development: Resources for Understanding Developmental Milestones and Talking with Parents You see children in your classroom demonstrating developmental milestone every day. In this session, you will learn about free resources to help you understand and talk with parents about their child's development by utilizing materials from the U.S. Center for Disease Control and Prevention's "Learn the Signs. Act Early" campaign. Participants will elave the session with example materials from the campaign, instructions for how to access more resources for free, a template for integrating them into their center or home care and access to a free online continuing education training for early childhood educators.	Carmen Wenger, Help Me Grow Alaska Program Director, Help Me Grow Alaska, All Alaska Pediatric Partnership, & CDC's Ambassador to Alaska for the Learn the Signs, Act Early Campaign Anchorage, AK carmen@helpmegrowak.org	50	Willow
Thursday, February 7, 2019 1:30-4:45						
Curriculum 	Across Levels	3-5	Guiding Children's Learning Through Play For children, play is the heart of early understanding about the natural world, mathematical concepts, literacy and social and emotional competency. We will be defining play and learning environments, exploring teachers' role in the learning process and how reflection plays a key role in children learning.	Vanessa Plourde-Smith Professional Development Specialist thread, Anchorage, Alaska vsmith@threadalaskas.org	40	Spruce
Thursday, February 7, 2019 1:30-3:00						
Leadership & Management	Established	3-5	Pre-Elementary Working Session This session is open to state-funded pre-elementary programs and partners. This opportunity is open to current and prospective state-funded school district pre-elementary programs and their Head Start and Child Care mixed-delivery partners. Participants will: Hear updates from the Dept. of Education and Early Development (DEED) on the status of funding opportunities; receive important information on guidelines for applying for pre-elementary funding; have opportunities for sharing successes, strategies, and barriers with other pre-elementary grantees; hear a presentation from Lern and Grow, Alaska's Quality Recognition and Improvement System on the alignment of standards across early learning sections.	Carol Prentice, Consultant, Prentice Consulting, Juneau, Alaska carol@cprenticeconsulting.com Supanika Ackerman, Education Specialist II Dept of Education & Early Development, Juneau, AK Supanika.ackerman@alaska.gov Kristen Spencer,	75	Chart
Teaching	Across Level	Across Age/ Grade Spans	Language, Cognitive, and Movement, Oh My! Learning through Music Come learn how music promotes learning in every domain of development for every age. Learn how to incorporate music into daily routines and to help teach concepts in a fun, engaging way.	Hailee Jensen, Early Head Start Home Visitor, CCS Early Learning, Chugiak, AK hjensen@ccsalaska.org Naomi Kerce, Early Head Start Home Visitor, CCS Early Learning, Wasilla, AK nkerce@ccsalaska.org	50	Denali
Teaching	Emerging	Birth-3	The Role of Language in Establishing a Foundation for Infant & Toddler Cognitive Development As language and communication abilities develop with an increasing understanding and use of vocabulary and other means of sharing information, infants and toddlers begin to create neural and cognitive links that lead to concept and memory formation, self-control, empathy, a sense of self, and other critical information retention. By providing infants and toddlers with lots of verbal stimulation through books, songs, stories, fingerplays, rhymes, games, and other interactions and communication along with eye gaze, cuddling/holding, noticing, etc., the very young child can and will become proficient in processing information and ultimately learn about his or her world, the environment, relationships, and other significant aspects of life.	Keith L. Pentz, National Early Childhood Specialist, Kaplan Early Learning Company kpentz@kaplanco.com	40	Katmai

Thursday: Sessions at a Glance

NAEYC STANDARD	LEVEL	AGE GROUP	WORKSHOP TITLE & DESCRIPTION	PRESENTER(S)	CAPACITY	ROOM
Thursday, February 7, 2019 1:30-3:00						
Relationships	Across Levels	All	Communicating Across Cultures: The Iceberg Metaphor In this workshop, Rev. Dr. Michael Oleksa continues his discussion of cultures and communication through the metaphor of an iceberg. As two people communicate, they often only show a small piece of who they are, with their attitudes and beliefs hidden under water. He will explore how our early experiences are influential in forming these attitudes and beliefs and how those later influence our communications. Rev. Dr. Michael Oleksa explores how understanding and valuing our own experiences while seeking to understand and value experiences of others will facilitate valuable conversations in our work.	Reverend Dr. Michael Oleksa, Retired, St. Innocent Cathedral Diocese of Alaska, Anchorage, Alaska	40	Aleutian
Teaching	Emerging	Birth-3 3-5	Wowing Your Kiddo Crowd with Reading Aloud Join this interactive and hands-on workshop where you will learn and practice multiple strategies to increase engagement of children birth through age 5 during read-a-loud time.	Tabatha Peterson, Professional Development Specialist, CCS Early Learning, Wasilla, AK tpeterson@ccsalaska.org	40	Aspen
Teaching	Across Levels	Across Age/ Grade Spans	Building Brains Playfully How is brain development and ultimately learning impacted by play? This workshop unpacks the latest science on the relationship between play and brain growth. Importantly, we will investigate the undeniable importance of pretend play in the growth and development of young children, in multiple domains, including executive function. This session is a repeat of Wednesdays session and is repeated on Saturday, 10:15-12:15, Katmai/King Salmon Room.	Peg Oliveira, PhD, Executive Director, Gesell Institute of Child Development New Haven, CT peg@gesellinstitute.org	40	Birch
Health	Established	Birth-3	Baby See, Baby Do Come join us for an interactive, fun exploration of vision development and vision issues in infants and toddlers. We will look at early identification and detection to statewide contacts for vision related medical and related educational needs. We are here to work with you and assist you in all your vision needs and questions.	Jacinda Danner, M.ED, TVI, COMS Teacher of the Blind & Visually Impaired, Matanuska Borough School District & AVISION, LLC Anchorage, AK kimaladay@gmail.com Kim Mix, M.A. Special Education, State of AK Early Intervention/Infant Learning Program Manager, Anchorage, AK kim.mix@alaska.gov	50	Willow
Teaching	Emerging	3-5	A Partner in Play with STEAM During this interactive journey, we will discuss developmentally appropriate activities for S.T.E.A.M. (Science, Technology, Engineering, Art and Mathematics). We will define each component and explore how they can be integrated in centers and throughout the learning environment. We will look at our partnership during a child's play to enhance their natural curiosity and get the most out of their learning environment. This session is repeated: Thursday, 3:15-4:45, Fireweed Room Friday, 1:30-3:00, Katmai Room Friday, 3:15-4:45, Katmai Room	Ron Mohl, Lead Educational Presenter, Lakeshore Learning Materials, rmohl@lakeshorelearning.com	40	Fireweed
Community Relationships	Emerging	All	Equal Access Child Care: Financial Assistance for the Future of All Children Is your facility financially accessible to all children? Stay current with the requirement rules for Child Care Assistance authorizations. If you're a provider and want to learn what you can do to help children in financially struggling homes gain access to the building blocks for their future, come and find out what's new. We will also share information for AK IN! and special needs children, as well as the new authorization standards, to guarantee proper reimbursement to meet the financial needs of distressed families, and your facility.	Colleen Vague, Local Administrator, Child Care Assistance Program, Anchorage, AK colleen@akafs.org Brittany Ford, ET, Provider Specialist Child Care Assistance Program, Anchorage, AK Brittany@akafs.org	50	Lupine

Thursday: Sessions at a Glance

NAEYC STANDARD	LEVEL	AGE GROUP	WORKSHOP TITLE & DESCRIPTION	PRESENTER(S)	CAPACITY	ROOM
Thursday, February 7, 2019 3:15-4:45						
Curriculum	Across Levels	All	Every Day We PLAY is a Way to Say: Hey! PLAY is Power! Our goals are healthy children in families, schools, cultures and communities. Our mission is to help young ones use sounds, stories and movements to develop their potential with play to act in our world. Music, dance and storytelling help kids connect to parent/teacher role models with life lessons to share. Play begins at home and education begins with family activities. We use percussion instruments and performing arts techniques to engage children in collaborative skits. These have lessons about taking care of ourselves, friends and family. Ideas, topics and themes are woven into a tale that has movement and music/sound components. The story concludes with a group resolution to the plot situation. We spark the hearts and minds of little ones and they return that creative energy tenfold! No experience necessary! Your heartbeat and smile is all we need! Join us to share common ground that nurtures amazing kids! This is an active, hands-on workshop and your age may flow from preschool to where you are now! Good humor is an integral part of what we do. This presentation is repeated on Saturday, 8:00-10:00, Aleutian.	Eddie Wood, Performing Artist/Education Consultant, Homer, AK rumbalaska@yahoo.com	50	Aleutian
Health	Across Levels	3-5	Learning Through Movement This workshop is to explain the "why" and importance behind large motor movement, in the learning process of preschoolers. Concepts from the I'm Moving, I'm Learning Curriculum will be discussed, along with ways to incorporate materials you already have. Come prepared to move and to discuss solutions to improve transitions. This session is repeated on Saturday, 2:45-4:45, Aleutian.	Linda Duke, Early Childhood Associate Educator, CCS Early Learning, Wasilla, AK lduke@ccsalaska.org Summer Frank Early Childhood Associate Educator, CCS Early Learning, Wasilla, AK sfrank@ccsalaska.org	50	Denali
Curriculum	Established	Birth-3, 3-5	Purposeful Engagements: Supporting Young Learners with Meaningful Interactions and Intentionality This session addresses working with all infants and toddlers (both typically and atypically developing) by using specific interactions and program decisions that directly impact and relate to creating relationships, meet any curriculum/program goals and objectives (STEM/STEAM), work in any schedule, support innovative practice, and demonstrate how to "get it all done" in a busy day. Lots of brain-compatible learning strategies.	Keith L. Pentz, National Early Childhood Specialist, Kaplan Early Learning Company kpentz@kaplanco.com	50	Katmai
Health	Established	Birth-3	Infants/Toddlers & Hearing—the Importance of Early Detection & Knowing the Options We will answer your questions on everything hearing! Parents & professionals will gather together to answer your questions through their perspectives and experience. Why is early hearing detection important? What service options are there for children experiencing hearing loss throughout Alaska? What should Infant Learning Program Providers know when working with families with hearing loss? What state-wide resources are available?	Andrea Samuel, Speech Therapist, Private Practice, Anchorage, Alaska a.samuel.slp@gmail.com Annette Callies, Early Hearing Detection & Intervention Program Manager, State of Alaska, Anchorage, AK Annette.callies@alaska.gov Kim Mix, M.A. Special Education, State of AK Early Intervention/Infant Learning Program Manager, Anchorage, AK kim.mix@alaska.gov	50	Willow

Thursday: Sessions at a Glance

NAEYC STANDARD	LEVEL	AGE GROUP	WORKSHOP TITLE & DESCRIPTION	PRESENTER(S)	CAPACITY	ROOM
Thursday, February 7, 2019 3:15-4:45						
Teaching	Emerging	3-5	A Partner in Play with STEAM During this interactive journey, we will discuss developmentally appropriate activities for S.T.E.A.M. (Science, Technology, Engineering, Art and Mathematics). We will define each component and explore how they can be integrated in centers and throughout the learning environment. We will look at our partnership during a child's play to enhance their natural curiosity and get the most out of their learning environment. This session is a repeat of Thursdays, 1:30-3:00 session & is repeated: Friday, 1:30-3:00, Denali Room Friday, 3:15-4:45, Denali Room	Ron Mohl, Lead Educational Presenter, Lakeshore Learning Materials, rmohl@lakeshorelearning.com	50	Fireweed
Leadership & Management 	Emerging	Adult Learners	Building My Future: What Could I Do with \$3,000? What does your future look like in the field of early childhood? What would you do if you had \$3,000 for professional development? Learn about professional development funding opportunities through the System for Early Education Development (SEED). Create your professional development plan that is tied to the Alaska SEED Career Ladder and the Core Knowledge and Competencies.	Panu Lucier, SEED Director, thread, Anchorage, AK plucier@threadalaska.org Rachel Steiner, Professional Development Associate, thread, Anchorage, AK rsteiner@threadalaska.org	40	Lupine
Community Relationships	Across Levels	Across Age/ Grade Spans	Building Cultural Connections This workshop will spend time talking about ways to implement more cultural relevant information into early childhood educational settings.	Jennifer Russell, Education & Disabilities Coordinator, TCC Prenatal to Five Head Start, Fairbanks, AK JLRussell2@alaska.edu	40	Birch
			Networking/Collaboration Room If you would like to reserve either of these rooms to use for networking or collaboration please see Christie at the upstairs Registration Desk.		18	Prince William Or Cook Inlet
Community Relationships	Across Levels	All	WON'T YOU BE MY NEIGHBOR? You're invited to re-discover the joy of Mister Rogers, and to screen the acclaimed film Won't You Be My Neighbor? for your community to help build connections between people and evoke Mister Rogers' values of compassion and kindness. In Won't You Be My Neighbor?, Academy Award-winning filmmaker Morgan Neville looks back on the legacy of Fred Rogers, focusing on his radically kind ideas. While the nation changed around him, Fred Rogers stood firm in his beliefs about the importance of protecting childhood. Neville pays tribute to this legacy with the latest in this highly engaging, moving documentary portrait of an essential American artist. This session is a repeat of Wednesday's session and is repeated: Friday, 3:15-4:45, Birch Saturday, 2:45-4:45, Birch	Facilitator: Anchorage AEYC Board or Conference Committee	50	Aspen



2019 NAEYC Annual Conference

November 20-23, 2019 | Nashville, TN



Anchorage Association for the Education of Young Children

2020 AAEYC Annual Conference

One, Two, Buckle My Shoe...

Three, Four, Let's Explore!

February 6-8, 2020 | Anchorage, AK



To all the Exhibitors
who joined us this year.

AAEYC appreciates your support.

Conference Events



NAEYC/Local Alaska Affiliates Members Lounge

Dillingham Room—Thursday-Friday-Saturday

NAEYC members—their very own member lounge! Members are able to learn what's new in NAEYC membership, grab snacks, have access to special giveaways, and chat with Anchorage AEYC Board & Committee Members. We look forward to seeing you there!



Silent Auction

Thursday-Saturday
9:00 a.m.—2:55 p.m.

Bid on your favorite items. The Anchorage AEYC annual Silent Auction supports funds for Anchorage AEYC Early Childhood Education Scholarships. 100% of funds go toward the scholarships.
New items each day.



Alcohol Ink Painting Party!

Come Join the Fun!
It's fun! It's easy.

Friday, February 8th
6:00-9:00 pm

49th State Brewing Company
Special Conference Rate: \$30

Limited to 25

Enjoy step by step instructions in a relaxed atmosphere. This will be held at the 49th State Brewing Company where you will be able to order food/drinks (at your own cost). You will find yourself getting lost in the moment as you create your own unique masterpiece. We provide everything you need. Walk away with an artwork to be proud of and an experience to remember. Invite your friends too! You do not have to be registered for the conference to attend! Visit the Registration desk to register or for more info contact:

Anna at handsoff73@hotmail.com

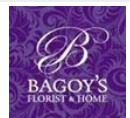

1. Amazon

* Go to <http://smile.amazon.com/> to start your Amazon Shopping process. Enter "Anchorage Association for the Education of Young Children" in the "pick your own charitable organization" space to choose Anchorage AEYC.

2. Bagoy's Florist Helping Hands

* Through Bagoy's Helping Hands program, you can elect to have \$5.00 of each online purchase donated to Anchorage AEYC by selecting it from the Helping Hands menu on the order page. Visit: www.bagoys.com

3. Fred Meyers

* Help Anchorage AEYC Earn Donations Just By Shopping with Your Fred Meyer rewards Card! You must sign up annually! Here's how the program works:
1. Sign up for the Community Rewards program linking your Fred Meyer Rewards Card to Anchorage Assn. for the Education of Young Children at www.fredmeyer.com/communityrewards. You can search for us by our name or by our non-profit number #YN444.

Thanks for supporting Anchorage AEYC!

naeyc
WEEK of the YOUNG CHILD™
April 6-13, 2019

The Week of the Young Child is an annual celebration hosted by the National Association for the Education of Young Children (NAEYC) celebrating early learning, young children, their teachers and families.



Music Monday! April 8, 2019

Sing, dance, celebrate, and learn

Through music, children develop math, language, and literacy skills—All while having fun and being active! Make up and record your own unique version of a song or write your own, and share it on NAEYC's Facebook page or post to Twitter using the hashtag #woyc19.

Try this: Find the beat to connect music, movement and math. Practice clapping, drumming, or stomping to the beat of the music while counting.



Tasty Tuesday April 9, 2019

Healthy eating and fitness at home and school

This fun, food-themed day is more than just cheese and crackers. Cooking together connects math with literacy skills, science, and more. With the rise in childhood obesity, you can encourage healthy nutrition and fitness habits at home and in the classroom. Create your own healthy snacks and share the recipes and photos of your creations on NAEYC's Facebook page or post to Twitter using the hashtag #woyc19.

Try this: Measure your ingredients while making your snacks! Ask children if they'd like the same or different amount of each ingredient.



Work Together Wednesday April 10, 2019

Work together, build together, learn together

When children build together they explore math and science concepts and develop their social and early literacy skills. Children can use any building materials — from a fort of branches on the playground to a block city in the classroom, or a hideaway made from couch pillows at home. Build and share pictures of children's creations on NAEYC's Facebook page or post to Twitter using the hashtag #woyc19.

Try this: Practice organizing blocks by size! Try building a block tower with large blocks on the bottom and little blocks on top!



Artsy Thursday April 11, 2019

Think, problem solve, create

Children develop creativity, social skills and fine muscles with open-ended art projects where they can make choices, use their imaginations and create with their hands. On Artsy Thursday celebrate the joy and learning children experience when engaged in creative art making. Use any materials—from crayons to paint, clay to crafts! Create and share photos of your children's creations on NAEYC's Facebook page or post to Twitter using the hashtag #woyc19.

Try this: Bring art outdoors! Offer dark and light paper, chalk and pastels, and suggest children create their own versions of the day and night sky.



Family Friday April 12, 2019

Sharing family stories

Engaging and celebrating families is at the heart of supporting our youngest learners. NAEYC applauds family members' role as young children's first and most important teachers. Share pictures and stories about your family on NAEYC's Facebook page or post to Twitter using the hashtag #woyc19 as we celebrate the unique role families play in their children's learning and development.

Try this: Invite parents for a Family Friday breakfast, where children can prepare and share breakfast treats with their families!

Friday, February 8, 2019

AGENDA IN DETAIL

7:30-5:00	REGISTRATION/CHECK IN/INFORMATION DESK OPEN	Promenade
7:30-2:55	SILENT AUCTION.....	Lobby down from Registration
	Participate in the silent auction. Not only will you come away with terrific items, you will be giving someone else the opportunity to attend the conference in the future. Proceeds support Anchorage AEYC scholarships fund.	
7:30-4:45	VISIT THE EXHIBITORS	
7:30-8:00	CONTINENTAL BREAKFAST	Alaska
8:00-9:30	OPENING GENERAL SESSION	Aleutian/Alaska
	KEYNOTE: Cate Heroman Think back to your earliest memory of making something, tinkering, or inventing something to solve a problem. What did you do? Did you build a fort? Take apart an old toy and try to put it back together again? Tape boxes together to create a cool car? Invent a gizmo to lift things into a tree house? This is what tinkering, making, and engineering look like in early childhood! When children are actively involved in these STEM-rich experiences, they are deeply engaged in learning about the world around them, how things work and how to make our world a better place for everyone. It is not jointly inspirational And playful, but important! We don't know what problems children will confront in the future, but the knowledge, skills and dispositions they acquire through making, tinkering, and engineering experiences in the early years will help them become competent and confident program solvers for tomorrow. Please remain seated until the session concludes. Premature departures disturb closing remarks and announcements considered important to other attendees. No workshop session will begin until the general session is over.	
9:30-5:00	NAEYC/LOCAL ALASKA AFFILIATES MEMBER LOUNGE	Dillingham
	For NAEYC members—their very own member lounge! Become a member now and join us! Members are able to grab a snack, relax & network, have access to special giveaways and speak with Anchorage AEYC board & conference members. Convince a friend to become a member and receive an extra door prize ticket!	
9:45-11:45	SEMINAR SESSIONS	
11:45-1:15	LUNCH ON YOUR OWN	
1:30-3:00	WORKSHOP SESSIONS	
3:15-4:45	WORKSHOP SESSIONS	
6:00-9:00	SPECIAL EVENT: ANCHORAGE AEYC ALCOHOL INK PAINTING PARTY.....	49th State Brewing Company
	Join us for a painting party. Cost is \$35 which includes all painting materials and canvas. A portion of the proceeds will go towards Anchorage AEYC Scholarship Fund. RSVP and pay at the Registration Desk.	
5:00-7:00	CONTINUING EDUCATION CREDIT CLASS REFLECTION & WRAPUP.....	Prince William Board Room

Friday: Session at a Glance

NAEYC STANDARD	LEVEL	AGE GROUP	WORKSHOP TITLE & DESCRIPTION	PRESENTER(S)	CAPACITY	ROOM
Friday, February 8th 9:45-11:45						
Teaching	Across Levels	Across Age/ Grade Spans	When to Play and When to Get Out of the Way Not all play is created equal. While unfettered exploration is essential to allowing children to grow important skills, so is adult-directed guidance and scaffolding. In this workshop we will describe the difference in play depending on the level and kind of adult involvement. Importantly, we will consider when adult initiated play is helpful to learning, and when it's time for adults to step back. This session is a repeat of Thursdays session & is repeated: Saturday, 8:00-10:00, Aleutian Room	Peg Oliveira, PhD, Executive Director, Gesell Institute of Child Development New Haven, CT peg@gesellinstitute.org	100	Denali
Curriculum	Established	3-5	What To Do When You Don't Know What To Do This practical, hands-on, interactive, and engaging session provides a variety of strategies to use immediately with young children for group times, transitions, instruction, one-on-one, and will also support and nurture social, emotional, and positive mental health development. The techniques and practical suggestions draw upon ideas and activities that appeal to young children and at the same time promote skills and concept learning.	Keith L. Pentz, National Early Childhood Specialist, Kaplan Early Learning Company kpentz@kaplanco.com	100	Aleutian

Friday: Session at a Glance

NAEYC STANDARD	LEVEL	AGE GROUP	WORKSHOP TITLE & DESCRIPTION	PRESENTER(S)	CAPACITY	ROOM
Friday, February 8th 9:45-11:45						
Relationships	Emerging	3-5	Enhancing the Learning Environment: Classroom Management Strategies We will use classroom routines, setup, and daily activities to manage the learning environment with positive and engaging teacher-student interactions with transitions and teachable moments. Come enhance your knowledge by learning new strategies to employ in the learning environment that facilitate and model classroom organization that empowers children to take ownership of their own classroom and behavior management.	Ron Mohl, Lead Educational Presenter, Lakeshore Learning Materials, rmohl@lakeshorelearning.com	100	Katmai
Teaching	Across Levels	3-5, 5-8	Smoooshables and Mooshables Come and join the fun. This will be an interactive workshop so come prepared to have fun, as we make many different kinds of playdough, goop, gak and much, much more! Plus you will get a packet with all the fun recipes to take back to your center so you can continue to have fun with the world of sensory.	Bonnie Monson, Center Coordinator, CCS Early Learning (Chugiak) Chugiak, AK bmonson@ccsalaska.org Helen Bohn, Family Educator, CCS Early Learning (Chugiak) Chugiak, AK hbohn@ccsalaska.org	50	King Salmon
Families	Established Experienced	Birth-3, 3-5	Assistive Technology for Children Ages Birth to age Five Join our panel conversation about Assistive Technology (AT) available to children ages birth to five in Alaska. We explore questions such as: What is AT and what does it look like with infants and toddlers?; Who uses AT?; What are some available resources to access AT?; A parent, specialized librarian with a statewide AT loan program, speech-language pathologist, occupational therapist, and physical therapist will share their experiences with use of AT with very young children. Information about Mini grant resources to potentially fund AT will also be provided.	Anne Freitag, Librarian Special Education Service Area (SESA) afreitag@sesa.org Maria Del Rosario, Parent, Health Manager, State of Alaska Senior & Disabilities Maria.delrosario@alaska.gov Julie Peters, CCC-SLP, Developmental Specialist, REACH Infant Learning Program, Juneau, AK jpeters@reachak.org Kathleen Hansen, OTR D/OTR L, Developmental Specialist, REACH Infant Learning Program, Juneau, AK khansen@reachak.org Theresa Rosso, MAT, Med, ATACP Health Program Manager, Early Intervention/Infant Learning Part C Program, Alaska Theresa.rosso@alaska.gov	50	Iliamna
Leadership & Management	Established	3-5	Pre-Elementary Strategic Planning Working Session (open to state-funded pre-elementary programs & partners) This opportunity is open to current and prospective state-funded district pre-elementary programs and their Head Start and Child Care mixed-delivery partners. Participants will receive important information on guidelines for applying for pre-elementary funding and have the opportunity to work together on the application process for FY20 pre-elementary programs.	Carol Prentice, Consultant, Prentice Consulting, Juneau, AK carol@cprenticeconsulting.com	50	Willow

Friday: Session at a Glance

NAEYC STANDARD	LEVEL	AGE GROUP	WORKSHOP TITLE & DESCRIPTION	PRESENTER(S)	CAPACITY	ROOM
Friday, February 8th 9:45-11:45						
Health 	Across Levels	Birth-3	SIDS/SBS Come learn how to create a safe sleeping environment to reduce the risk of sleeping related deaths, as well as identify startling statistics on Shaken Baby Syndrome (SBS) and how to prevent and reduce the number of SBS victims.	Vanessa Plourde-Smith, Professional Development Specialist, thread, Anchorage, AK vsmith@threadalaska.org	40	Aspen
Leadership & Management 	Across Levels	Adult Learners	Powering Up for Play: Teacher Stress and Wellness, Impact on Teacher-Child Relationships and Decisions to Expel or Suspend a Child Positive relationships are key to anyone's growth and learning. Teacher-child relationships are critical to fostering social emotional development of young children, however, research has identified some links between teacher stress, skills and knowledge, access to supports in relationships to expulsion and suspension practices. This session will highlight the national and local research and begin to discuss strategies to reduce teacher stress and increase wellness. This session is repeated on Saturday, 10:15-12:15, Willow.	Meghan Johnson, Learn and Grow Director, thread/Learn and Grow, Anchorage, AK mjohnson@threadalaska.org Sarah Wright, Professional Development Specialist, thread, Anchorage, AK swright@threadalaska.org Jennifer Clark, Director of Consultation, thread, Anchorage, AK jclark@threadalaska.org	40	Spruce
Curriculum	Across Levels	Across Age/ Grade Spans	But They're Just Playing! Nope, They're Learning. Confidence to Learn (and Teach) Outside of School Get the dirt on playing and learning outside! Design learning opportunities for young children's fine and gross motor skills in the outdoors through exploration; the basis of inquiry. Help kids grow physical confidence and capacity in the outdoor classroom. It's time playing got the respect it deserves!	Brenda Duty, Project WILD/Youth Ed Coordinator, Alaska Dept Fish & Game, Anchorage, AK Brenda.duty@alaska.gov Ellen Grover, Region II Wildlife Educator, Alaska Dept. Fish & Game, Anchorage, AK Ellen.grover@alaska.gov	40	Birch
Curriculum	Across Levels	5-8	My Place: Connecting Young Children to Their Place The My Place project helps to connect young children to their environment and local context. This is a Place-Based Art-Rich Curriculum where children, families and teachers work together to identify a place and build community together.	Hilary Seitz, Professor of Early Childhood, UAA, Anchorage, AK Hkseitz@alaska.edu Suzanne Callander, Student, UAA secallander@alaska.edu Emily Longlet, Student, UAA E.longlet@hotmail.com Suzanne Snyder, Student, UAA smsnyder2@alaska.edu Amy Nalesnik, Student, UAA aanalesnik@alaska.edu Kelsey Hernandez, Student, UAA Hernandez.kelsey@gmail.com Emilia Brown, Student, UAA emiliabrown99@gmail.com	40	Lupine

Friday: Session at a Glance

NAEYC STANDARD	LEVEL	AGE GROUP	WORKSHOP TITLE & DESCRIPTION	PRESENTER(S)	CAPACITY	ROOM
Friday, February 8th 9:45-11:45						
Relationships	Across Levels	5-8	Conscious Discipline and Play Based Relationships We will look to the powers, skills and structures of Conscious Discipline to support the relationships in our classrooms and work places. We will play with these ideas and practice using our brilliance.	Kimmer Ball, Pre-K Coach, Anchorage School District, Anchorage, AK Ball_Kimberly@asdk12.org	50	Fireweed
Friday, February 8th 1:30-4:45						
Physical Environment	Emerging	3-5, 5-8	Tinker! Make! Innovate! STEM-Rich Learning in Early Childhood Participate in STEM-rich tinkering, making and engineering experiences and explore new tools and technologies. Explore strategies for planning and organizing a learning environment conducive to problem solving and creative thinking. Examine a new resource from NAEYC that uses problems in children's picture books as a springboard for tinkering, making, and designing engineering activities. This session is repeated Saturday, 8:00-12:15, Denali Room.	Cate Heroman, Author, Independent Early Childhood Consultant, Baton Rouge, Louisiana CateHeroman@mac.com	50	Denali
Families	Emerging, Established	Birth-3	Supporting Family Engagement through a Neurodevelopmental Framework Lens This workshop will support you in recognizing that challenging behaviors in young children can have multiple causes. You will be able to recognize toxic stress patterns in children, families and themselves. Concepts of "bottom up and top down" interventions will be introduced. Developmentally appropriate expectations for emotion control in very young children will be explored. We will "connect the dots" between stress reduction and the ability to modulate emotions so that young children are ready to learn. The need for collaboration among all systems of care will be highlighted.	Christy McMurren, MSW Infant Mental Health Specialist, Program Manager at PIC, Programs for Infants & Children, Inc. Anchorage, AK christym907@gmail.com	50	Iliamna
Health	Established	Birth-3, 3-5	Using Developmental Screening in Early Care & Learning Settings Do you want to use a developmental screening tool in your program but aren't sure how to get started? This 3-hour session will provide information on the Ages & Stages questionnaire (ASQ-3), a 5-domain, parent-normed screening tool. Topics include 1) An overview of developmental screening and features of the ASQ-3; 2) Introducing the screening tool to parent; 3) Discussing results with parents; 4) Using the web-based ASQ Online. The session will include interactive exercises and opportunity for questions and discussion. Workshop leaders are certified in ASQ-3 training and/or have early childhood special education backgrounds.	Kristen Spencer, Education Specialist II, Dept. of Education & Early Development, Juneau, AK Kristen.spencer@alaska.gov Carol Prentice, Consultant, Prentice Consulting, Juneau, AK carol@cprenticeconsulting.com	40	Aspen
Friday, February 8th 1:30-3:00						
Teaching	Established	3-5	Going Beyond Behavior Management: Prevention vs. Intervention Classroom management is often identified as the number one issue facing teachers. Due to a variety of factors, children may or may not respond to expectations in a learning environment. If teachers understand that preventive strategies related to behaviors can be put in place to negate the need for interventions, the cause for "control" is no longer necessary. In order for preventive strategies to be effective, simple, and yet profound, guidelines must be taken into consideration: child development, brain/cognitive development, lighting, color, sensory stimuli, task assignment, choices/options, prior knowledge base, language proficiency and vocabulary, number of items to comprehend, instructional design, and positive/negative influences. By establishing a learning environment that does not promote but prevents inappropriate behaviors from occurring, academic, social and emotional expectations, curricular results, and other goals can be more readily achieved.	Keith L. Pentz, National Early Childhood Specialist, Kaplan Early Learning Company kpentz@kaplanco.com	100	Aleutian

Friday: Session at a Glance

NAEYC STANDARD	LEVEL	AGE GROUP	WORKSHOP TITLE & DESCRIPTION	PRESENTER(S)	CAPACITY	ROOM
Friday, February 8th 1:30-3:00						
Teaching	Emerging	3-5	A Partner in Play with STEAM During this interactive journey, we will discuss developmentally appropriate activities for S.T.E.A.M. (Science, Technology, Engineering, Art and Mathematics). We will define each component and explore how they can be integrated in centers and throughout the learning environment. We will look at our partnership during a child's play to enhance their natural curiosity and get the most out of their learning environment. This session is a repeat of Thursdays, 1:30-3:00 & 3:15-4:45 sessions & is repeated: Friday, 3:15-4:45, Katmai Room	Ron Mohl, Lead Educational Presenter, Lakeshore Learning Materials, rmohl@lakeshorelearning.com	50	Katmai
Health	Across Levels	All	Disaster Preparedness, for Rookies! Building Your Plan for the Unexpected Future Are you prepared for a disaster? This workshop will help you to think of some of the basic things that you, your center or home care may need in the event that disaster strikes. We will delve deeper into some of the not so common things to think of as well as get you better prepared for a disaster that may strike. This workshop will be interactive so please come prepared to participate and get some ideas from your fellow conference attendees.	Kayla Hayes, Lead Mentor Teacher, Credit Union 1 Little 1's Learning Center, Anchorage, AK hayesk@cu1.org	50	King Salmon
Families	Across Levels	5-8	Playful Learning Approach Connecting School, Family and Community One of the best ways for families to support their children's learning is to encourage them to think, talk and explore like scientists. This hands-on play workshop includes group activities using FREE mobile apps and interactive games supporting investigation, observation, data collection, and analysis. Children learn science while having creative fun. These FREE Ready to Learn resources provide opportunities for families to share their knowledge, skills and culture with family and other community members. Perfect for caring adults and educators looking to develop a home learning environment utilizing FREE PBS KIDS created media.	Stephanie McFadden, Community Engagement Assoc. Alaska Public Media, Anchorage, AK smcfadden@alaskapublic.org Elizabeth Nicolai, Youth Services Coordinator, Anchorage Public Library Anchorage, AK NicolaiEL@ci.anchorage.ak.us	40	Spruce
Teaching	Emerging	5-8	Creating Inclusive Early Learning Groups: Supporting Early Learners with Special Needs Are you an educator looking for practical strategies to create an inclusive learning community? If so, this session is for you. Social supports, visual supports, communication supports, physical structure, and suggestions to make instruction meaningful for a variety of young learners, including those with special needs, will be covered in this 90-minute session. And, if you are a fan of "Make & Take" materials, you won't be disappointed! Materials will be provided to make a variety of visual supports that we talk about during the session. Come for the strategies, leave with the knowledge and materials to make groups meaningful.	Tara Maltby, Program Coordinator, Alaska Autism Resource Center/ Special Education Service Agency, (SESA) Anchorage, AK tmaltby@sesa.org	40	Birch
Relationships	Across Levels	3-5	Dramatic Play and Early Literacy: Connecting Imagination to Future Reading Success Dramatic play, also called pretend play, is a way that preschoolers learn about their world and their place in it. Dramatic play supports a child's early literacy development by teaching them a variety of skills. This session will teach more about the early literacy benefits of dramatic play and how you as a caregiver can more easily support the children in your care to grow and thrive.	Samantha Blanquart, Early Literacy Outreach Librarian, Read to Read Resource Center, Anchorage, AK Samantha.blanquart@anchorageak.gov	50	Willow

Friday: Session at a Glance

NAEYC STANDARD	LEVEL	AGE GROUP	WORKSHOP TITLE & DESCRIPTION	PRESENTER(S)	CAPACITY	ROOM
Friday, February 8th 1:30-3:00						
Teachers 	Across Levels	Birth-3, 5-8	Expand Your Knowledge of thread's Toolkit Do you have all the tools you need as an early childhood educator? This workshop is designed to expand your knowledge of thread's services to educators and the programs they serve. Take an interactive walk through thread's new website and learn valuable opportunities in training, grant and funding support, onsite services, marketing, and technical assistance, and designed to meet your professional needs so you are ready to provide the best possible care for Alaska's children. Feedback from participants will be encouraged and there will be a chance to win fun prizes as well!	JJ Harrier, Director of Marketing, thread, Anchorage, AK jharrier@threadalaska.org	50	Fireweed
Leadership & Management	Across Levels	All	Advocates in Action—Speaking up for Young Children You are a voice for children, you are an early childhood advocate! This session will give you tips and tools for how to engage in advocacy. Whether beginning or advanced, become a stronger early childhood advocate! Come hear about the latest work of the Alaska Early Childhood Advocacy Group and Public Policy priorities for the 2019 Legislative session. Role play how a bill becomes a law, learn more about how you can engage in the Legislative process, and interactively map out actions—both big and small you can take part in. You have the power to create change for children, families and early educators. Presenters include representatives for the Alaska Early Childhood Advocacy Group including thread, Best Beginnings, AEYC affiliates in Alaska, All Alaska Pediatric Partnership, Alaska Head Start Association, Alaska Infant Learning Program Association, Parents as Teachers State Office.	Stephanie Berglund, CEO, thread, Alaska's Child Care Resource & Referral Network, Anchorage, AK sberglund@threadalaska.org Margaret Bauer, Public Policy Chair, Anchorage AEYC Board & Shareholder Development Manager, Chenega Future, Inc. Anchorage, AK mbauer@chenegafuture.com	40	Lupine
			Networking/Collaboration Rooms If you would like to reserve either of these room to use for networking or collaboration please see Christie at the upstairs Registration Desk.		18	Prince William & Cook Inlet
Friday, February 8th 3:15-4:45						
Curriculum	Emerging	Birth-3, 3-5	Making the Body-Brain-Mind Connection in Teaching and Learning This informative and practical session will provide a current perspective on teaching and learning by examining cognitive processes, explore the interconnectedness of the physical body with the brain and mind, relate how play is central to the learning process, suggest a variety of brain-compatible strategies to implement immediately that prevent behavior issues, and offer resources for further study.	Keith L. Pentz, National Early Childhood Specialist, Kaplan Early Learning Company kpentz@kaplanco.com	100	Aleutian
Teaching	Emerging	3-5	A Partner in Play with STEAM During this interactive journey, we will discuss developmentally appropriate activities for S.T.E.A.M. (Science, Technology, Engineering, Art and Mathematics). We will define each component and explore how they can be integrated in centers and throughout the learning environment. We will look at our partnership during a child's play to enhance their natural curiosity and get the most out of their learning environment. This session is a repeat of Thursdays, 1:30-3:00 & 3:15-4:45 sessions & Friday's, 1:30-3:00 session.	Ron Mohl, Lead Educational Presenter, Lakeshore Learning Materials, rmohl@lakeshorelearning.com	50	Katmai
Leadership & Management	Across Levels	All	Statewide Childcare Licensing Updates Please join us for information on statewide childcare licensing updates.	Staci Collier, Licensing Program Manager, Child Care Program Office, Anchorage, AK Staci.Collier@alaska.gov	40	Lupine

Friday: Session at a Glance

NAEYC STANDARD	LEVEL	AGE GROUP	WORKSHOP TITLE & DESCRIPTION	PRESENTER(S)	CAPACITY	ROOM
Friday, February 8th 3:15-4:45						
Teaching	Across Levels	3-5	Learning at Large Group Large-Group Time presents unique challenges in any classroom. Join us to learn a variety of techniques to engage students during Large-Group Time to enrich learning opportunities, while maintaining an exciting and fun atmosphere for multiple learning styles and behaviors. This approach to Large-Group Time support community building through exploration and experiential learning with techniques such as name recognition, charting, songs, file folder stories, books, felt stories, science and much more, creating an enjoyable part of the day for teachers and students alike.	Emily Casey, Family Educator/Lead Preschool Teacher, CCS Early Learning (Chugiak), Chugiak, AK ecasey@ccsalaska.org Serena Outhier, Family Educator/Lead Preschool Teacher, CCS Early Learning (Chugiak), Chugiak, AK Southier@ccsalaska.org	40	Spruce
Assessment Of Child Progress	Established	Birth-3, 3-5	Alaska CLIMBS Data Bootcamp For programs currently using Teaching Strategies as their child assessment tool, this workshop will focus on the reports and data linkage that is possible. We will examine how to organize your data and how you can generate different graphics to illustrate your programs story using your data. This session will also look at the Alaska CLIMBS framework on how you can use this data to start conversations within your programs to work towards continuous quality improvement.	Supanika Ackerman, Education Specialist II, DEED, Juneau, AK Supanika.ackerman@alaska.gov	50	King Salmon
Leadership & Management 	Across Levels	Birth-3, 3-5, 5-8	Introduction to Alaska Core Knowledge and Competencies & Early Learning Guidelines The Alaska's Early Childhood Core Knowledge and Competencies (AK ECCCKC) are designed to assist ECL educators develop the many skills needed to provide quality programs for children. This session will provide an introduction to AK ECCCKC, how they are organized, and how they connect to and support the professional development of ECL educators. This training is required for advancement to Level 2 in Learn and Grow: Administrators must complete this session as part of achieving the "Alaska Early Childhood Administrator Credential". Lead teachers must complete this session as part of "Level 2: Moving into Higher Quality Training." For more information about Learn and Grow and the various pathways to complete these training requirements please visit www.aklearnandgrow.org This session is repeated Saturday, 8:00-10:00, Willow.	Pili Queja, Professional Development Specialist, thread, Anchorage, AK pqueja@threadalaska.org	50	Willow
			Networking/Collaboration Rooms If you would like to reserve either of these room to use for networking or collaboration please see Christie at the upstairs Registration Desk.		18	Prince William & Cook Inlet
Community Relationships	Across Levels	All	WON'T YOU BE MY NEIGHBOR? You're invited to re-discover the joy of Mister Rogers, and to screen the acclaimed film Won't You Be My Neighbor? for your community to help build connections between people and evoke Mister Rogers' values of compassion and kindness. In Won't You Be My Neighbor?, Academy Award-winning filmmaker Morgan Neville looks back on the legacy of Fred Rogers, focusing on his radically kind ideas. While the nation changed around him, Fred Rogers stood firm in his beliefs about the importance of protecting childhood. Neville pays tribute to this legacy with the latest in this highly engaging, moving documentary portrait of an essential American artist. This session is a repeat of Wednesday's & Thursday's session and is repeated: Saturday, 2:45-4:45, Birch	Facilitator: Anchorage AEYC Board or Conference Committee	50	Birch

New products are waiting at the Lakeshore booth!



To learn more, contact
Brian Kenneweg, Regional Manager
(425) 736-7505 • bkenneweg@lakeshorelearning.com

©2019 Lakeshore 1199194

Lakeshore®
LakeshoreLearning.com



Saturday, February 9, 2019

AGENDA IN DETAIL

7:30-1:00	REGISTRATION/INFORMATION DESK OPEN	Promenade
7:30-5:00	NAEYC/LOCAL ALASKA AFFILIATES MEMBER LOUNGE	Dillingham
	For NAEYC members—their very own member lounge! Become a member now and join us! Members are able to grab a snack, relax & network, have access to special giveaways and speak with Anchorage AEYC board & conference members. Convince a friend to become a member and receive an extra door prize ticket!	
7:30-2:55	SILENT AUCTION.....	Lobby down from Registration
	Participate in the silent auction. Not only will you come away with terrific items, you will be giving someone else the opportunity to attend the conference in the future. Proceeds support Anchorage AEYC scholarships fund.	
7:30-8:00	CONTINENTAL BREAKFAST	Alaska
7:30-4:45	VISIT THE EXHIBITORS	
8:00-10:00	SEMINAR SESSION	
10:15-12:15	SEMINAR SESSION	
12:15-1:30	LUNCH ON SITE.....	Aleutian/Alaska
1:30-2:30	CLOSING CELEBRATION, AWARDS & KEYNOTE	Aleutian/Alaska
2:45-4:45	SEMINAR SESSION	

Saturday: Sessions at a Glance

NAEYC STANDARD	LEVEL	AGE GROUP	WORKSHOP TITLE & DESCRIPTION	PRESENTER(S)	CAPACITY	ROOM
Saturday, February 9th 8:00-12:15						
Physical Environment	Emerging	3-5, 5-8	Tinker! Make! Innovate! STEM-Rich Learning in Early Childhood Participate in STEM-rich tinkering, making and engineering experiences and explore new tools and technologies. Explore strategies for planning and organizing a learning environment conducive to problem solving and creative thinking. Examine a new resource from NAEYC that uses problems in children's picture books as a springboard for tinkering, making, and designing engineering activities. This session is a repeat of Friday's 1:30-4:45 session.	Cate Heroman, Author, Independent Early Childhood Consultant, Baton Rouge, Louisiana CateHeroman@mac.com	50	Denali
Community Relationships	Across Levels	All	History and Hope: Adverse Childhood Experiences, Resilience and Trauma-Informed Education The "History & Hope" training introduces the audience to the adverse childhood experiences study, and addresses the question "Why are adverse childhood experiences so adverse, and what can we do about it?" Bringing together Alaska Native ancestral knowledge of trauma and resilience; the sciences of neurobiology, physiology, and epigenetics; data on social and economic stressors affecting Alaskan families; simple brain-body healing exercises; and promising practices in education and early childhood settings, this presentation provides an introduction to how trauma-informed, culturally-responsive approaches in healthcare and education can help shift our most pressing health and social problems.	Deb Ward, Ed.S., NCSP Nationally Certified School Psychologist, Ward Educational Consultation & Coaching, Anchorage, AK Sch.psych.ward@gmail.com Sue Armstrong, UAA Center for Human Development, Outreach Clinic and Family Coordinator, Anchorage, AK	50	Fireweed

Saturday: Sessions at a Glance

NAEYC STANDARD	LEVEL	AGE GROUP	WORKSHOP TITLE & DESCRIPTION	PRESENTER(S)	CAPACITY	ROOM
Saturday, February 9th 8:00-10:00						
Curriculum	Across Levels	All	Every Day We PLAY is a Way to Say: Hey! PLAY is Power! Our goals are healthy children in families, schools, cultures and communities. Our mission is to help young ones use sounds, stories and movements to develop their potential with play to act in our world. Music, dance and storytelling help kids connect to parent/teacher role models with life lessons to share. Play begins at home and education begins with family activities. We use percussion instruments and performing arts techniques to engage children in collaborative skits. These have lessons about taking care of ourselves, friends and family. Ideas, topics and themes are woven into a tale that has movement and music/sound components. The story concludes with a group resolution to the plot situation. We spark the hearts and minds of little ones and they return that creative energy tenfold! No experience necessary! Your heartbeat and smile is all we need! Join us to share common ground that nurtures amazing kids! This is an active, hands-on workshop and your age may flow from preschool to where you are now! Good humor is an integral part of what we do. This session is a repeat of Thursday's 3:15-4:45 presentation.	Eddie Wood, Performing Artist, Education Consultant, Homer, AK rumbalaska@yahoo.com	50	Aleutian
Teaching	Across Levels	Across Age/ Grade Spans	When to Play and When to Get Out of the Way Not all play is created equal. While unfettered exploration is essential to allowing children to grow important skills, so is adult-directed guidance and scaffolding. In this workshop we will describe the difference in play depending on the level and kind of adult involvement. Importantly, we will consider when adult initiated play is helpful to learning, and when it's time for adults to step back. This session is a repeat of Thursday's & Friday's presentations.	Peg Oliveira, PhD, Executive Director, Gesell Institute of Child Development New Haven, CT peg@gesellinstitute.org	100	Katmai/ King Salm-on
Relationships	Established	Birth-3	Constructively Meeting 10 Challenges of Working with Infants, Toddlers and Twos The challenges faced by caregivers and other adults while spending time with little ones can oftentimes seem at odds with creating bonds. These challenges include maintaining a safe environment, communication, emotional development, tantrums, and biting—to name a few. By approaching the challenges as opportunities, the adults in a setting can begin to build relationships and have interactions that will truly benefit a child's development cognitively, physically, socially and emotionally.	Keith L. Pentz, National Early Childhood Specialist, Kaplan Early Learning Company kpentz@kaplanco.com	50	Iliamna
Teaching 	Emerging, Established	3-5	Developing Fine Motor through Play Join us to learn fun and different ways to develop fine motor. Fine motor is an important piece in pre-writing. Fine motor is small muscle movement that occurs in the fingers and involves coordination with the eyes. During this workshop we will be exploring the general eye, finger and hand manipulative skills that it takes to develop strong fine motor skills.	Bonnie Monson, Center Coordinator, CCS Early Learning, Chugiak, AK bmonson@ccsalaska.org Neva Lancaster, Center Coordinator, CCS Early Learning, Wasilla, AK nlanaster@ccsalaska.org	40	Spruce
Teaching	Across Levels	3-5	Engaging Exploring and Curiosity through Sensory Play Do you remember what it was like to have that child-like curiosity? To explore without inhibition and learn from experiencing? This session will discuss our sensory system, sensory-processing difficulties that some students with autism or low incidence disabilities may have, and ways to incorporate sensory play into your every day classroom. This session will have some hands-on sensory activities and a few sensory ideas and materials to take back to your classroom for immediate implementation!	Aimee Smith, M.A. Autism Resource Specialist, Special Education Service Agency (SESA) Anchorage, Alaska asmith@sesa.org	40	Birch

Saturday: Sessions at a Glance

NAEYC STANDARD	LEVEL	AGE GROUP	WORKSHOP TITLE & DESCRIPTION	PRESENTER(S)	CAPACITY	ROOM
Saturday, February 9th 8:00-10:00						
Leadership & Management 	Across Levels	Birth-3, 3-5, 5-8	<p>Introduction to Alaska Core Knowledge and Competencies & Early Learning Guidelines The Alaska's Early Childhood Core Knowledge and Competencies (AK ECCCKC) are designed to assist ECL educators develop the many skills needed to provide quality programs for children. This session will provide an introduction to AK ECCCKC, how they are organized, and how they connect to and support the professional development of ECL educators.</p> <p>This training is required for advancement to Level 2 in Learn and Grow: Administrators must complete this session as part of achieving the "Alaska Early Childhood Administrator Credential". Lead teachers must complete this session as part of "Level 2: Moving into Higher Quality Training." For more information about Learn and Grow and the various pathways to complete these training requirements please visit www.aklearnandgrow.org</p> <p>This session is a repeat of Friday's 3:15-4:45 presentation.</p>	Pili Queja, Professional Development Specialist, thread, Anchorage, AK pqueja@threadalaska.org	50	Willow
Saturday, February 9th 10:15-12:15						
Teaching	Across Levels	Across Age/ Grade Spans	<p>Building Brains Playfully How is brain development and ultimately learning impacted by play? This workshop unpacks the latest science on the relationship between play and brain growth. Importantly, we will investigate the undeniable importance of pretend play in the growth and development of young children, in multiple domains, including executive function.</p> <p>This workshop is a repeat of Wednesday & Thursday's Presentation.</p>	Peg Oliveira, PhD, Executive Director, Gesell Institute of Child Development New Haven, CT peg@gesellinstitute.org	100	Katmai/ King Salmon
Relationships	Emerging	Birth-3	<p>Cuddling, Consciousness, and Cognition: The Significance of Emotional Engagement on Development and Learning Emotional engagement that stems from loving and caring interactions, the creation of relationships, and a stimulating environment has a direct and significant impact on a young child's development and learning. The shaping of a "mind" and how the child will respond to life events is forever guided by the touches, gazes, caresses, cuddling, language, songs, and playful experiences during the first years of life. The society of tomorrow is being held in our arms today!</p>	Keith L. Pentz, National Early Childhood Specialist, Kaplan Early Learning Company kpentz@kaplanco.com	50	Iliamna
Assessment of Child Progress 	Across Levels	Birth-3, 3-5	<p>Haga corer sus miedos y frustraciones cuando es tiempo que los niños aprendan a usar el toilet We face many challenges when it's time to toilet learn. As teachers your job is not to potty train but to support your students where they are in their development. We will learn tips to identify developmental signs of readiness for toilet learning, tips for toilet learning, resources to support this transition and how to support parents in this process. Come join me for some potty talk.</p> <p>This presentation will be presented in Spanish.</p>	Zuleika Sanchez, Bilingual Professional Development Specialist, thread, Anchorage, AK zsanchez@threadalaska.org	40	Aspen
Leadership & Management 	Across Levels	Adult Learners	<p>Professional Development Plans—Drivers of Program Quality & Success Come join our discussion about Professional Development plans, and how they provide a pathway to program growth, staff wellness and a higher quality overall.</p>	Veronica Plumb, ECE Faculty, University of Alaska Fairbanks Fairbanks, AK vmplumb@alaska.edu Rixa Evershed, Director, Foundation Health Partners Child Development Center, Fairbanks, AK Rixa.Evershed@foundationhealth.org	40	Birch

Saturday: Sessions at a Glance

NAEYC STANDARD	LEVEL	AGE GROUP	WORKSHOP TITLE & DESCRIPTION	PRESENTER(S)	CAPACITY	ROOM
Saturday, February 9th 10:15-12:15						
Leadership & Management 	Across Levels	Adult Learners	Powering Up for Play: Teacher Stress and Wellness, Impact on Teacher-Child Relationships and Decisions to Expel or Suspend a Child Positive relationships are key to anyone's growth and learning. Teacher-child relationships are critical to fostering social emotional development of young children, however, research has identified some links between teacher stress, skills and knowledge, access to supports in relationships to expulsion and suspension practices. This session will highlight the national and local research and begin to discuss strategies to reduce teacher stress and increase wellness. This session is repeated of Friday's session.	Meghan Johnson, Learn and Grow Director, thread/Learn and Grow, Anchorage, AK mjohnson@threadalaska.org Sarah Wright, Professional Development Specialist, thread, Anchorage, AK swright@threadalaska.org Jennifer Clark, Director of Consultation, thread, Anchorage, AK jclark@threadalaska.org	50	Willow
Saturday, February 9th 1:30-2:30						

JOIN THE CELEBRATION

1:30-2:30



Don't ever give up on yourself or your dreams. You're worthwhile, and always will be, no matter what. Just remember to always be who you are, because that person is very special.

There's no person in the whole world like you. And I like you just the way you are.

Recognize your colleagues by filling out the ballot included in your conference packet!



Celebrating Your Achievements & Milestones

Let's **Celebrate You!**

Saturday: Sessions at a Glance

NAEYC STANDARD	LEVEL	AGE GROUP	WORKSHOP TITLE & DESCRIPTION	PRESENTER(S)	CAPACITY	ROOM
Saturday, February 9th 2:45-4:45						
Relationships	Across Levels	3-5	This is Me: Building Resiliency & Creativity through the Arts Vulnerability is necessary in the classroom to promote authenticity, relationship-building, creativity, academic risk-taking, and all of the other necessary things required to learn effectively and become productive citizens in society. How can we, as teachers/providers, embrace vulnerability and build an environment that is safe for students to express themselves and learn to be resilient and innovative thinkers. Brene Brown said, "Vulnerability is the birthplace of innovation, creativity, and change." If we want to build lifelong learners and innovators, we must encourage healthy vulnerability and build critical thinkers and constructive evaluators. This session will explore how to build resiliency, vulnerability and creativity through the arts. Come prepared to discuss and create together!	Aimee Smith, M.A. Autism Resource Specialist, Special Education Service Agency (SESA) Anchorage, Alaska asmith@sesa.org	50	Denali
Curriculum	Across Levels	Across Age/ Grade Spans	FREE STEM KITS to Promote Learning Learn how to enhance a child's mind with any of the 15 FREE STEM kits Civil Air Patrol Offers. Participants will learn how to obtain FREE STEM kits and curriculum as well as what new programs are available to youth. During the workshop we will have STEM make and takes to share with your students. This workshop is a repeat of Wednesday's session.	Lynda MacPherson, Director of Aerospace Education/STEM, AK Civil Air Patrol, Wasilla, Alaska Lynda.macpherson@akwg.cap.gov	50	Katmai/ King Salmon
Curriculum	Emerging	Birth-3, 3-5	Playful Explorations: Building a Foundation for Development and Learning This session looks specifically at play as a strategy to facilitate and be used as a vehicle for learning any content area (science, technology, engineering, arts, math) in the infant and toddler classroom as well as encourages and promotes building a "community of learners." Lots of information on how to enhance brain and cognitive development in infants and toddlers.	Keith L. Pentz, National Early Childhood Specialist, Kaplan Early Learning Company kpentz@kaplanco.com	50	Iliamna
Curriculum	Across Levels	5-8	Design Challenge: Create a Puppet that Represents Your Inner Self Puppets have many benefits with young children. Come and explore a variety of materials to make a puppet that represents you!	Hilary Seitz, Professor of Early Childhood, UAA, Anchorage, AK Hjseitz@alaska.edu Suzanne Callander, Student, UAA secallander@alaska.edu Emily Longlet, Student, UAA E.longlet@hotmail.com Suzanne Snyder, Student, UAA smsnyder2@alaska.edu Amy Nalesnik, Student, UAA aanalesnik@alaska.edu Kelsey Hernandez, Student, UAA Hernandez.kelsey@gmail.com Emilia Brown, Student, UAA emiliabrown99@gmail.com	50	Willow

Saturday: Sessions at a Glance

NAEYC STANDARD	LEVEL	AGE GROUP	WORKSHOP TITLE & DESCRIPTION	PRESENTER(S)	CAPACITY	ROOM
Saturday, February 9th 2:45-4:45						
Health	Across Levels	3-5	Learning Through Movement This workshop is to explain the “why” and importance behind large motor movement, in the learning process of preschoolers. Concepts from the I’m Moving, I’m Learning Curriculum will be discussed, along with ways to incorporate materials you already have. Come prepared to move and to discuss solutions to improve transitions. This session is a repeat from Thursday’s 3:15-4:45 presentation.	Linda Duke, Early Childhood Associate Educator, CCS Early Learning, Wasilla, AK lduke@ccsalaska.org Summer Frank Early Childhood Associate Educator, CCS Early Learning, Wasilla, AK sfrank@ccsalaska.org	50	Aleutian
Teaching	Emerging	3-5	Fun with Stories, Language and Literacy—Ages 3-5 Join me for some entertaining draw-n-tell stories, and them based stories. Learn how to create felt board stories and make books too.	Tracy Breimo, Associate Administrator, Anchorage Head Start Family Advocate, RurAL CAP Child Development Center, Anchorage, AK tbreimo@ruralcap.com	40	Spruce
Community Relationships	Emerging	Birth-3	Childcare and the Infant Learning Program Working Together to Support Early Learning and Development Child care provider’s play an important role in supporting children in their learning and development each day. They also play an important role in supporting children with developmental delays and disabilities each day. This workshop will familiarize providers with the supports and services available through Early Intervention/Infant Learning Program and how to locate and build partnerships with their local Infant Learning Program to continue these supports in a child care setting and optimize child development. This presentation will also familiarize providers with information about developmental screens, their importance, and how to talk to caregivers about results from these screens.	Kim Mix, M.A. Special Education, State of AK Early Intervention/Infant Learning Program Manager, Anchorage, AK kim.mix@alaska.gov Jessica Gardner, Developmental Specialist, Program for Infants & Toddlers, Anchorage, AK jgardner@picak.org	40	Aspen
Community Relationships	Across Levels	All	WON'T YOU BE MY NEIGHBOR? You’re invited to re-discover the joy of Mister Rogers, and to screen the acclaimed film Won’t You Be My Neighbor? for your community to help build connections between people and evoke Mister Rogers’ values of compassion and kindness. In Won’t You Be My Neighbor?, Academy Award-winning filmmaker Morgan Neville looks back on the legacy of Fred Rogers, focusing on his radically kind ideas. While the nation changed around him, Fred Rogers stood firm in his beliefs about the importance of protecting childhood. Neville pays tribute to this legacy with the latest in this highly engaging, moving documentary portrait of an essential American artist. This session is a repeat of Wednesday’s, Thursday’s & Friday’s presentation.	Facilitator: Anchorage AEYC Board or Conference Committee	50	Birch



Conference Evaluation Questionnaire

Please remember to complete the
2019 Conference Evaluation Questionnaire
 which will be sent to you
ELECTRONICALLY
 immediately following the conference.



2020 AAEYC Annual Conference

One, Two, Buckle My Shoe...

Three, Four, Let's Explore!

February 6-8, 2020 | Anchorage, AK

Exhibitors

7:30-4:45 Thursday-Friday—Saturday

Anchorage AEYC

Rachel Ragula, President

Phone: (907) 696-5884

Email: anchorageaeyc@mtaonline.net

Web Site: www.anchorageaeyc.org



Anchorage Association for the
Education of Young Children

Eddie Wood Performing Artist/Education Consultant

Eddie Wood

Phone: (907) 235-6160

E-mail: rumbalaska@yahoo.com

AIR Child Care Training Solutions

Amie Brock

Phone: (330) 635-0586

Email: amie@aircpr.com

Web Site: www.airchildcare.com



Grand Canyon University

Roger Porter

Phone: (602) 639-8217

Email: Roger.Porter@GCU.edu

Website: www.gcu.edu/udc/roger.porter



AK DHSS Obesity Prevention & Control Program

Diane Peck

Phone: (907)

E-mail:

Web Site: www



Kaplan

Pam Tester

Phone: (800) 334-2014, ext 6122

E-mail: ptester@kaplanco.com

Web Site: www.kaplanco.com



Alaska Education & Recreational Products, LLC

Kit Wilson

Phone: (907) 229-1655

E-mail: kitw@akedproducts.com

Web Site: www.akschoolfurn.com



Lakeshore

Brian Kenneweg

Phone: 1-800-421-5354

Email: bkenneweg@lakeshorelearning.com

Web Site: www.lakeshorelearning.com



Alaska Autism Resource Center

Tara Maltby & Christine Collier

Email: tmaltby@sesa.org or ccollier@sesa.org

Phone: (907) 334-1300

Website: www.alaskaarc.org



Playful Learnings Pediatric Therapy

Kyle Thacker

Phone: (907) 317-9349

E-mail: kylethacker85@gmail.com

Website:



Alaska Civil Air Patrol

Lynda MacPherson

Phone: (907) 240-7888

Email: Lynda.macpherson@akwgc.cap.gov

Website:

www.gocivilairpatrol.com/programs/aerospace-education/for-educators/

Sandbox Software

Jamie Krzyzak

Phone: (800) 385-7930

Email: Jamie@sandboxsoftware.com

Web Site: www.sandboxsoftware.com



Best Beginnings

Abbe Hensley, Executive Director

Phone: (907) 297-3300

E-mail: info@bestbeginningsalaska.org

Web Site: BestBeginningsAlaska.org



thread

Stephanie Berglund, CEO

Phone: (907) 265-3100

Email: info@threadalaska.org

Web Site: www.threadalaska.org



Clare Swan Early Learning Center

Carrie Hackett

Phone: (907) 793-3254

E-mail: clhackett@cswan.org

Web Site: www.citi.org/partners-events/clare-swan-early-learning-center

UAA School of Education

Holly Johanknecht

Phone: (907) 786-4402

Web Site: www.uaa.alaska.edu/academics/school-of-education





Name: _____

Hilton Anchorage—Main Level



*Don't leave home
without this program &
your name badge!*

*Your name badge
allows you into sessions and
lunch!*

LOBBY LEVEL

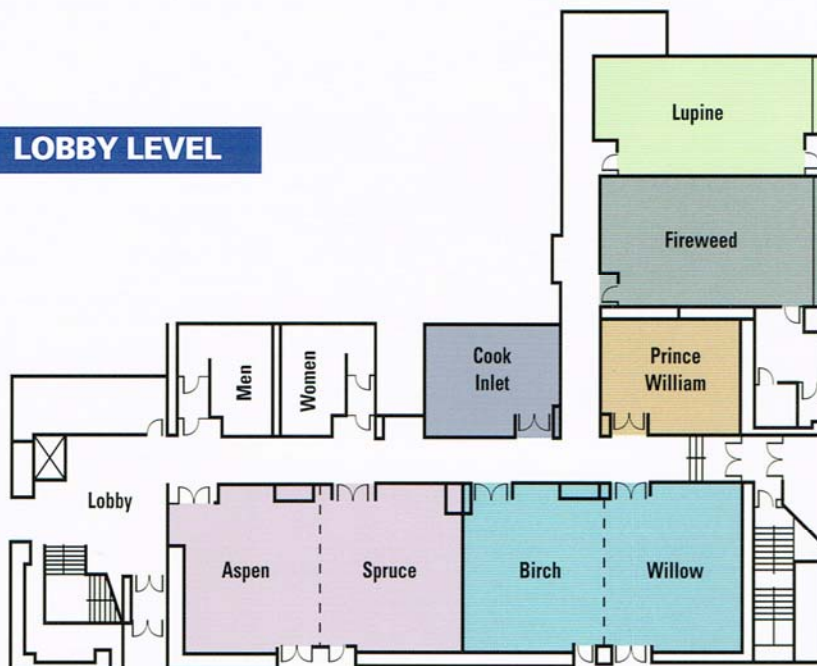

West Tower

SECOND FLOOR

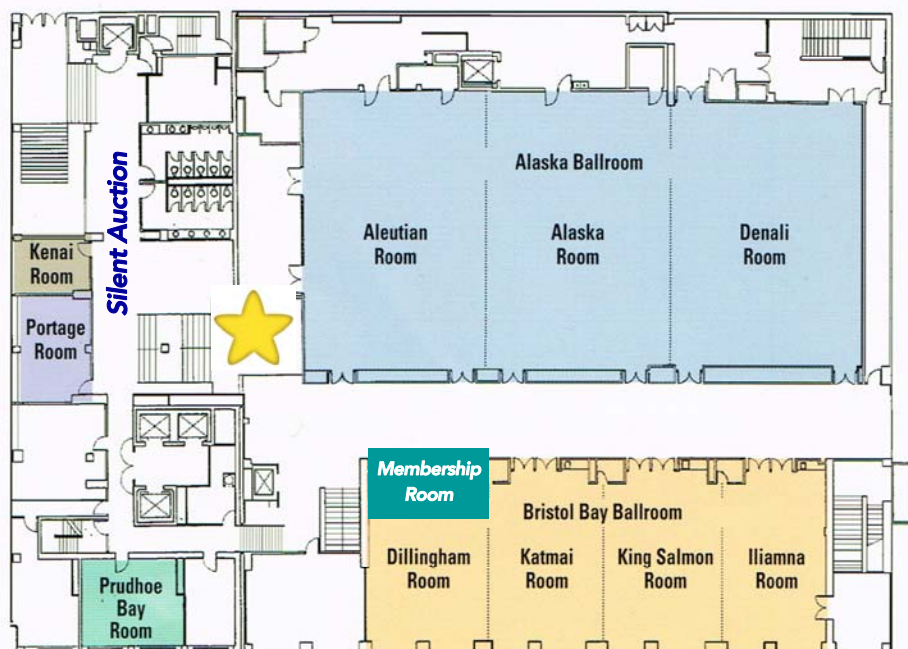

NOTICE

Out Of Respect
For Other Patrons
Please Be Sure
Your Cell
Phone
Is On Quiet
Or Vibrate



FIFTEENTH FLOOR



Registration Desk