

Anchorage Association for the Education of Young Children

Best Practices in the Face of Change

36th Annual Early Childhood Conference



Conference Program

**January 25-28, 2017
Hilton Anchorage Hotel**

WELCOME

Best Practices in the Face of Change at Anchorage AEYC's Annual Conference

Celebrating 36 years of bringing dynamic professional development, keynotes & featured speakers to Alaska.

On behalf of the Anchorage Association for the Education of Young Children Board (Anchorage AEYC) and Anchorage AEYC Conference Committee, we would like to welcome you to the 2017 Anchorage AEYC Early Childhood Conference, "Best Practice in the Face of Change" in Anchorage Alaska. The Anchorage AEYC Early Childhood Conference is an opportunity for professional and personal growth and for networking with professionals in the field. We are excited that you have chosen to join us for Anchorage AEYC 36th annual Early Childhood Conference.

Throughout the 4 day conference, you will have opportunities to attend a variety of sessions offered by renowned Speakers and Early Childhood Professionals. You will also have opportunities to make new connections, become inspired, and come away with rich ideas, strategies, and reflections that will positively impact the work you do every day with young

children within your communities.

This year, Anchorage AEYC will host a member only room with raffles and refreshments, if you are currently not a member of NAEYC and Anchorage AEYC, there will be opportunities to join during the conference. There will be a "painting night" fundraiser on Friday, January 27, 2016 5pm-7pm in the chart room. The cost is \$30.00 and all are welcome. A portion of the proceed from the painting party will go to Anchorage AEYC Scholarship Fund. There will be a silent auction on each day of the conference. Please make sure to check each day as new items will be placed out for the auction.

Each year, the conference committee strives to improve the conference. We value the feedback that you provide on the Conference Evaluation Questionnaire. Conference evaluation questionnaire are sent to you electronically

based on the e-mail address provided during registration. Please let us know of any improvements or suggestions that might help make this Early Childhood Conference a MUST to attend!

The Anchorage AEYC Board and Conference Committee are looking for professionals in the field who are interested in serving on our board and committees. Please send an e-mail to anchorageaeyc@mtaonline.net if you are interested.

We would like to commend and thank you for your commitment to working with and advocating for the children and families within your communities.

Sincerely,
Anna Castillo, Mary Gibson, &
Rachel Ragula
Anchorage AEYC Conference Chairs.

Board & Committee Members Needed

Anchorage AEYC Board of Directors is looking for our next wave of leaders on the Anchorage AEYC Board , Board Committees and 2018 Conference Planning Committee.

This is a wonderful opportunity to get involved in the largest organization of early care and education professionals in Alaska.

Stop by the Anchorage AEYC Membership Lounge (Dillingham Room) to speak to a current board or conference committee member to find out how you can become involved today!



Check us Out



Plan to Car Pool NOW!

PLEASE NOTE:

- ☐ There is a fee to park.
- ☐ Parking is limited downtown.
- ☐ Valet parking is available for \$16 day or \$24 for overnight guest.

We recommend you car pool with other colleagues.

Let's Carpool!



Sponsoring Partners

Anchorage AEYC Board of Directors and Conference Committee members thank the partnering conference sponsors in recognition of their generous financial support of this event. Please send them know how much their support means to Alaska's children, families, communities and you as an educator.



Anchorage Association for the Education of Young Children
www.anchorageaeyc.org



State of Alaska Education & Early Development
www.education.alaska.gov



Alaska Department of Health and Social Services, Obesity Prevention and Control Program
www.hss.state.ak.us/dph/chronic/obesity



thread
www.threadalaska.org



Kaplan Early Learning Company
www.kaplanco.com



Lakeshore
www.lakeshorelearning.com



The Alaska Mental Health Trust Authority
www.mhtrust.org



The University of Alaska College Savings Plan
www.UACollegeSavings.com



Best Beginnings
www.bestbeginningsalaska.org

Anchorage AEYC

strives to meet it's mission

Anchorage AEYC promotes high-quality early learning for all children, birth through age 8, by connecting practice, policy and research. We advance a diverse, dynamic early childhood profession and support all who care for, educate, and work on behalf of young children.

2017 SCHEDULE OF EVENTS

Wednesday, January 25, 2017

- 7:30 a.m.—5:30 p.m. Registration
- 8:00 a.m.—9:30 a.m. General Session & Keynote: Keira Oeroff
- 9:45 a.m. - 11:45 a.m. Seminar Session
- 11:45 a.m. - 1:15 p.m. Lunch On Your Own
- 1:30 p.m. - 3:00 p.m. Workshop Session
- 3:15 p.m.—4:45 p.m. Workshop Session

Thursday, January 26, 2017

- 7:30 a.m.—5:30 p.m. Registration
- 8:00 a.m.—9:30 a.m. General Session & Keynote: Heather Kinzie
- 9:45 a.m.- 11:45 a.m. Seminar Session
- 11:45 a.m.—1:15 p.m. Lunch on site
- 1:30 p.m. - 3:00 p.m. Workshop Session
- 3:15 p.m.—4:45 p.m. Workshop Session
- 5:30 p.m.—7:30 p.m. Continuing Education Credit Class & Registration Additional Charge \$74

Friday, January 27, 2017

- 7:30 a.m.—5:30 p.m. Registration
- 8:00 a.m.—9:30 a.m. General Session & Keynote: Holly Elissa Bruno
- 9:45 a.m.- 11:45 a.m. Seminar Session
- 11:45 a.m.—1:15 p.m. Lunch on your own
- 1:30 p.m. - 3:00 p.m. Workshop Session
- 3:15 p.m.—4:45 p.m. Workshop Session
- 5:00 p.m.—7:00 p.m. Painting Party, Chart Room, Fundraiser for AAEYC \$30 Additional Charge
- 6:00 p.m.-7:45 p.m. Continuing Education Class Wrap Up

Saturday, January 28, 2017

- 7:30 a.m.—1:00 p.m. Registration
- 8:00 a.m.—9:30 a.m. General Session & Keynote: Holly Elissa Bruno
- 9:45 a.m.- 11:45 a.m. Seminar Session
- 11:45 a.m.—1:15 p.m. Lunch on site
- 1:30 p.m. - 3:00 p.m. Workshop Session
- 3:15 p.m.—4:45 p.m. Workshop Session

Conference Highlights

Keynote & Featured Speakers

Wednesday, January 25th



Keynote: The Feeding Relationship: An Introduction to the Possibilities

Keira Oseroff, MSW, LCSW is a Licensed Clinical Social Worker. Working with individuals, couples, families and

groups, she specializes in the treatment of those struggling with disordered eating (Anorexia Nervosa, Bulimia Nervosa and Binge Eating Disorder), including childhood feeding issues and dual diagnosis. Since being introduced to the Satter Feeding Dynamics and Eating Competence Models in 2002, she has utilized them in the assessment and treatment of the individuals and families with whom she has worked. She is passionate about the important distinction between treating people, not disorders, and guiding people of all ages toward a healthy relationship with food. To learn more visit: www.Keiraoserooff.com

Brought to you by:



Patti Jo Wilson, is a key member of Lakeshore's Professional Services Group. She draws on her extensive background in early childhood and elementary education to provide the most effective strategies for supporting children in a variety of different learning environments. She is a

board member of the New York Head Start Association, and has served children and families in multiple Head Start programs, and provided direct oversight in both Universal Pre-K and Early Learn Child Care settings. In addition, her two decades of teaching in the Northeast region provide Patti Jo with clear insight into the practical needs of educators in the classroom. Certified in K-12 literacy instruction, Patti Jo holds a B.S. degree in Behavioral Science and a master's degree in Literacy. Her administrative background also includes policy & procedure development, ensuring program accountability, and coordinating with multiple agencies at the local, state and federal levels.

Brought to you by:



Thursday, January 26th



Keynote: Leading the Children of Tomorrow

Heather Kinzie has been a student of leadership for over 25 years; she doesn't believe she will ever quit being a student in that regard. As a 20 year professional, she's had the pleasure of observing, coaching, mentoring and presenting to a variety of leaders.

Adding to Heather's commitment to leadership in the corporate setting is her commitment to developing outstanding communities. This, of course, starts as early as developing our children. As a parent of two youngens and a quasi-aunt to numerous others, Heather knows very well that children are watching us. They come to us directly for instruction and help but moreover, they indirectly observe and gather guidance and insight about attitude, behavior, and values.

To that end, Heather is excited about speaking to us as we are in the spotlight when it comes to leading the youngens! Specifically, she'll speak to our responsibility of encouraging and "leading" through change. Many are watching us, leaning on us and, indeed, depending on us. Heather believes we are prepared to respond to this call to action, and hopes to inspire and encourage us accordingly. To learn more visit: www.aleadingsolution.com

Brought to you by:



Dr. Rebecca Berlin is the Chief Strategy Officer at Teachstone and in this role works with states and school districts to implement the CLASS system and sets Teachstone's strategic direction. Rebecca has worn many hats in her professional life. She has worked in public and private schools

as an early interventionist, an early childhood teacher, an early childhood special education teacher, an autism specialist, and a school administrator. She holds a PhD in Research, Policy, and Administration from the University of Virginia and has worked at UVA as a teacher preparation faculty member and researcher. Rebecca is a frequent presenter at national and international conferences speaking on improving teacher child interactions and the quality of birth to five education.

Conference Highlights Keynote & Featured Speakers

Thursday, Friday & Saturday January 26th-28th



Cathy Cole began her career as a preschool teacher and had the opportunity to work with infants, toddlers, and school-age children in private programs and in Head Start, Migrant Head Start, and California State Preschool

programs. Cathy became a Head Start Delegate Director, a Head Start Grantee Interim Director, a National Head Start Consultant, and a Head Start Federal Reviewer. She is a certified facilitator for Dr. Stephen Covey's 7 Habits of Highly Effective People and 4 Roles of Leadership. Cathy joined us in 2015 and we are excited that she's returning!

Brought to you by:



Friday & Saturday, January 27th-28th



Keynotes:

Friday—Partnering with Change:
We Have to Do What!

Saturday—Learning from the
Bumps in the Road: Turning
Potholes into Grand Possibilities

Holly Elissa Bruno is an educator, best selling author, international keynote speaker, online radio host, "recovering" attorney and team builder. Her keynotes have received acclaim around the world, from New Zealand to Hungary and in 47 of the United States. Her keynotes are interactive: you will be invited to actively participate or sit back, learn and enjoy. The choice is yours. Expect to be challenged, inspired, laugh heartily and come away with practical tips on how you alone can make a difference. Holly Elissa joined us in 2011 and we are thrilled she's back! To learn more visit: www.hollyelissabruno.com

Brought to you by:



2016-17 Anchorage AEYC Board of Directors

Co-President: Wade Bertrand & Jessica Gardner

President Emeritus: Kyle Gardner

Secretary/Historian: Rachel Ragula

Treasurer: Tracey Breimo

Member Coordinator: Cecilia Harmon

Members at Large: Issa Camahuali

Program Quality: Anna Castillo

Public Policy: Anna Castillo

Liaisons: Thread—Mildred Parker

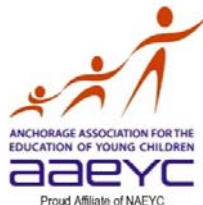

For Information on Anchorage AEYC & Services:

Phone: 907-696-5884

E-mail: Anchorageaeyc@mtaonline.net

Website: www.anchorageaeyc.org

Facebook: [Facebook.com/AnchorageAEYC](https://www.facebook.com/AnchorageAEYC)

Volunteer Conference Committee Members

Conference Chairs:

Anna Castillo, Mary Gibson,
Rachel Ragula

Committee Members:

Issa Camahuali
Anna Castillo
Kayla Hayes
Debbie Houseman
Neva Lancaster
Bonny Monson
Mildred Parker
Jane Parkhurst

Conference Coordinators:

C&C Services
Cecilia Harmon & Christie Holshouser

General Conference Information

General Sessions

All General Sessions will be in the Aleutian/Alaska Ballrooms.

Conference Identification

Please wear your conference name badge for admission to all workshop sessions, exhibits and special events.

Meals

A breakfast snack with coffee is available each morning 7:30-8:00 am. Lunch on Thursday and Saturday are included in your conference registration. Your name-tag is your ticket for the luncheons.

The Anchorage AEYC Early Childhood Conference strives to:

- ★ Provide educational opportunities and resources to those who work with and on behalf of young children and families.
- ★ Promote inclusive attitudes and practices and to support awareness of diversity issues.
- ★ Support partnerships, networking and collaboration between educators, families, providers, schools, agencies and the community.
- ★ Provide an engaging high quality Learning experience with sessions designed for professionals who are emerging; established and experienced.

Program Changes

Workshop changes and cancellations will be posted at the Registration Table. Please check for updates throughout the conference. While we make every effort to minimize these changes, they are unavoidable, and we ask for your understanding.

Emergency/Safety

Should an emergency arise during the course of the conference, we will utilize the approved plan in place at the Hilton Anchorage for security, evacuation and medical purposes.

Conference Tracks

Conference tracks have been identified to assist you in identifying sessions most pertinent to your professional needs or work. Sessions are categorized by their most dominant theme and tracks are organized around the ten standards for quality programs as identified by NAEYC.

They include:

- Relationships
- Curriculum
- Teaching
- Assessment
- Nutrition and Health
- Teaching Staff
- Family Relationships
- Community Relationships & Collaborations
- Physical Environment
- Management

Workshop Titles & Descriptions

Workshop titles & descriptions are written by the workshop presenters. Therefore, they should reflect the content of the session.

While Anchorage AEYC entertains and accepts differences of opinion, we do not necessarily endorse the products or views expressed by speakers. Anchorage AEYC urges conferees to contact individual exhibitors and/or presenters about any concerns and objections they may have about products, services, or practices. The Association also encourages that conferees extend their compliments to presenters/and or exhibitors whom they feel have provided a product or presentation of exceptional quality.

No person shall, on the grounds of race, creed, color, national origin, sex, sexual orientation, marital status or the presence of any sensory, mental or physical handicap, unlawfully be excluded from participation in, be denied the benefits of, or be otherwise subjected to discrimination under any activities performed pursuant to the conference or as an Anchorage AEYC member.

Parking

Parking is limited downtown.

Hotel Parking

- ♦ Overnight Valet for Hotel Guests is available for \$24.00 per day.
- ♦ Day only Valet parking for attendees is available for \$16.00 per day.

Parking charges for guests can be posted to your guest room folio and paid at the end of your stay.

Overflow Parking

Lot 12 located at the corner of E St. and 3rd Ave.

Parking is available at Lot 12 (The Saturday Market Lot) for \$1.00 per hour and can be paid for at the parking kiosk located in the parking lot.

All parking for both the Hilton Valet and Lot 12 are based upon first come first serve basis and subject to availability.

Workshop Capacity Facility Capacity

We offer a large selection of workshops with plenty of seating during each time slot. Seating for all sessions is on a first come, first serve basis. Seating may be limited due to the desire of the presenter, content of the session and size of the room. Because of this, we suggest selecting two or three workshops per session in the event your first choice is full. Workshop Volunteers/Host will monitor seating capacity and deny entrance once a room reaches maximum capacity. Please honor the Closed Session signs. In compliance with fire code regulations set forth by the Municipality of Anchorage, overflow seating on the floor or in the aisles of meeting rooms or hallways is not permitted. Remember this is for your safety as well as everyone else. We apologize for any lost opportunity.

General Conference Information

Conference Etiquette

With an average of 600 attendees, a successful Anchorage AEYC Annual Conference requires that we extend professionalism and courtesy to one another. The following tips may make for a more pleasant learning environment for all:

- Use this Program to plan your schedule.
- Select an alternate in the event of session being at capacity or a cancellation. Conference Volunteers must close a workshop when all chairs are occupied (full capacity) to conform to fire code regulations.
- Arrive early, but do not block other participants exiting a meeting room.
- Participants are encouraged to share materials (especially folks from the same program) and to refrain from taking more than one copy of handouts (even of the best ideas!).
- Turn off all cell phones.
- If it is necessary to leave a session early, or arrive late, make the interruption as non disruptive as possible.
- It's wonderful to catch up with our colleagues but please not while speakers are addressing the group. Others are trying to hear what is being said.
- We know that infants may need to stay close to their mothers. If your baby becomes inconsolable, we ask you to respect the needs of others and to go to a quiet area to relax until your infant is settled.
- Extend to others the courtesy you would like to experience.

Dress Code

Temperatures will vary greatly from room to room. No matter what, meeting rooms are always too cold for some and too warm for others. You are strongly encouraged to dress comfortably and in layers to accommodate the sometimes fluctuating facility temperature and your personal thermostats.

Electronic Devices

In order to provide a positive learning environment for participants and as a courtesy to speakers, all cellular and paging devices will need to be set on the silent mode or turned off during the conference.

Continuing Education Class

**ECD A 591 101: 1 Credit
AAEYC CONFERENCE 2017**

University of Alaska announces a Continuing Education Credit class:
AAEYC Conference 2017

Where: Prince William Board Rm
When: January 25-28, 2017
Cost: \$74.00 in addition to
Conference registration fee

Course Requirements:

1. Attend face to face meeting on
Thursday, January 26th from
5:30 – 7:30 pm
 - A. Administrative – Register and pay for course (\$74)
 - B. Introductions
 - C. Explanation of course requirements
2. Attend face to face meeting on
Friday, January 27th from 4:45 – 6:15 pm
 - A. Reflection – Share, show and tell
3. Documentation of at least 15 contact hours through AAEYC conference – submit copy of conference certificate (= at least two full days of conference and our two face to face meetings);
4. Write a brief summary of each session attended, to include key notes;
5. Write an in-depth summary of one session that is at least one page in length and includes:
 - A. The key message(s) you took from the session
 - B. Relate how the Alaska Early Learning Guidelines fits with the content of the session.
 - C. At least one idea that stood out to you from the session and how you can apply it to your program
 - D. Any additional resources you may need to learn more or to assist you to apply the new idea.

Alaska Early Learning Guidelines can be found at:
www.eed.state.ak.us/publications/EarlyLearningGuidelines.pdf

\$74 Registration fee is paid directly to UAA either online or at the class on Thursday, January 27th.

On-site Registration will be at the Thursday Evening Class Session or you may register online. For additional information, e-mail Mildred Parker, class instructor, at mparker@threadalaska.org, (907) 265-3116. or visit: www.anchorageaeyc.org.

Credit Course Disclaimer

Conference registration does NOT include credit courses. The credit course registration fee is \$74 and must be paid on Friday during the class or call for student enrollment assistance (Sally or Katie) at 786-1934 or toll-free 1-888-828-8974. Payments can be made by credit card or check (payable to UAA). UAA is an EQ/AA employer and educational institution.

Certificates of Participation

Each conference attendee has a Certificate of Participation in their conference folder. A total of 25.75 hour (6.5 per day) can be earned should you attend all sessions on Wednesday/Thursday/Friday/Saturday of the conference (including the keynote addresses). Credit for attending is granted through the issuance of session stickers (labels). At the conclusion of each session you attend, the presenter (or volunteer) will give you a label. You will need to place this label in the corresponding box on your Certificate of Participation. This certificate becomes your proof of attendance as no other documentation will be provided.



CDA Professional Development Track

thread is providing a training tract for individuals interested in achieving formal clock hours towards a Child Development Associate (CDA) credential. In order to receive CDA credit, participants must attend the entire session and complete a retrospective evaluation. For more information about the CDA, available training or advising please call thread's main line (907) 265-3100 or visit www.threadalaska.org.

TR, PDR & SEED Information

For information on:
Travel Reimbursement (TR) or Professional Development Reimbursement (PDR) and SEED Registry applications visit: www.threadalaska.org or call: 907-265-3194 or toll-free: 1-855-265-7333 or E-mail: info@seedalaska.org

Anchorage AEYC Early Childhood Education Scholarships



Ms. Lare'

The Anchorage AEYC Scholarships are offered quarterly to assist early childhood educators and providers who are pursuing a degree or certificate in Early Childhood in the state of Alaska as well as to providers who wish to attend any early childhood conference either in Alaska or out of state. Applications for the Anchorage AEYC Early Childhood Education Scholarship are available now on the Anchorage AEYC website: www.anchorageaeyc.org

Funds from the Silent Auction support this scholarship. There will be items in the Silent Auction for you to bid on each day of the conference as well as items that are bid on until Saturday.

The Early Childhood Education Scholarship began in honor of the late Ms. Lare', a long time public policy advocate on behalf of young children, their families and the individuals who worked with them on a daily basis. She was a past Anchorage AEYC board president & member of the board of directors, member on many NAEYC committees, chair of the Anchorage AEYC conference committee, a mover and shaker for KidPack, sat on the Child Care Alliance committee and a strong supporter of Head Start.

The Anchorage AEYC Early Childhood Scholarship applications are due:
December 31st, March 31st, June 30th & September 30th.

Selection criteria includes: Successful completion of the application, transcripts, resume, two letters of recommendation, interview, and current membership in Anchorage AEYC.

The Anchorage AEYC Early Childhood Scholarship can be downloaded from the Anchorage AEYC website:
www.anchorageaeyc.org

Congratulation 2017 Scholarship Recipients: Janell Streeter & Anna Castillo



Janell Streeter

I am currently a mother, wife and early interventionist with Programs for Infants and children in addition to being an Anchorage AEYC member. After working in Real Estate for 10 years, I made the tran-

sition to PIC two years ago after I finished my bachelors degree with the University of Alaska Anchorage. I always knew I would eventually seek out a Masters degree, but after working at PIC for a short time it didn't take long for me to decide I would receive my Masters in Special Education. I placed an emphasis on early child hood and also received a graduate certificate in Autism Spectrum Disorder. I completed my internships at PIC and one of our very own Part B preschool's through the Anchorage School District. I truly feel I have found my professional home at PIC. It has been a great opportunity for me to grow as a person and a professional.

Anna Castillo

November 2, 2016- November 5, 2016, I had the opportunity to attend the National Association for the Education of Young Children (NAEYC) Conference in Los Angeles, California. The scholarship I received from Anchorage AEYC helped pay for my airfare and conference fee. Attending the conference was valuable for me as it helped me grow both personally and professionally. I had the opportunity to attend the Affiliate Leadership Day and work with other Affiliate Leaders throughout the states. I attended multiple workshops that provided valuable information in building my skills as a leader in the field. I also had the opportunity to network with other professionals around the world that work with young children.



In regard to the growth of the mind, we should set our goals very, very high, because we know that most people are capable of more than they do or are.

-Seymour B. Sarason, Yale University

Wednesday, January 25, 2017

AGENDA IN DETAIL

7:30-5:30	REGISTRATION/CHECK IN/INFORMATION DESK OPEN	Promenade
7:30-8:00	CONTINENTAL BREAKFAST	Alaska
	Menu: Fresh muffins, fruit, juice, coffee, tea, hot chocolate	
8:00-9:30	OPENING GENERAL SESSION	Alaska
	KEYNOTE: Keira Oseroff, MSW, LCSW The Feeding Relationship: An Introduction to the Possibilities An appropriate feeding relationship supports children's developmental tasks at every age and every level of capability and allows children to eat the right amount of the proper food to be healthy and grow well. Childcare, educators, and health professionals are in a key position to help parents learn to effectively feed their children. Maintaining a positive feeding relationship demands a division of responsibility: The parent is responsible for what the child is offered to eat and (once the child becomes a toddler), for when and where it is offered; the child is responsible for how much and whether he or she eats.	
9:45-11:45	SEMINAR SESSIONS	
11:45-1:15	LUNCH ON YOUR OWN	
1:30-3:00	WORKSHOP SESSIONS	
3:15-4:45	WORKSHOP SESSIONS	



WEDNESDAY: SESSIONS-AT-A-GLANCE

NAEYC STANDARD	LEVEL	AGE GROUP	WORKSHOP TITLE & DESCRIPTION	PRESENTER(S)	CAPACITY	ROOM
Wednesday, January 25th 9:45-11:45						
Health	Established Professionals	All	Children and Weight: Helping without Harming Early childhood educators are in a powerful position to prevent child overweight, from birth, by supporting parents in raising competent eaters. When parents follow Satter's division of responsibility in feeding, children develop eating competence and are protected against developing obesity in later life. However, families must be protected from interference by being supported in accepting their child's consistent and constitutionally determined growth patterns, even when those patterns are above conventionally accepted cutoff points. This persuasive, research-based and practical presentation, addresses powerful approaches that child care professionals are uniquely qualified in resolving the dilemma of child overweight	Keira Oseroff, MSW, LCSW Faculty, Elynn Satter Institute Madison, WI keira@ellynsatterinstitute.org	100	Aleutian
Leadership & Management	Valuable to All	Adults	How to Inspire Grass Roots Leadership Do you strive to develop yourself as a leader and/or encourage and mentor others in their quest for leadership? Join us as we engage in the exploration of practical, fun and high energy techniques for tapping the best thinking of a team or group. In this session you will: Learn how to create the space in which grass-roots leadership can emerge; Understand how to expose, understand and appreciate divergent points of view; and understand how to help enable your work teams to break the ice, unlock thinking, generate original ideas and build consensus.	Tim Pearson, Owner Pearson Consulting On behalf of The Strive Group Anchorage, AK timpearson@gmail.com	100	Denali
Teaching	Valuable to All	Birth-3	Language & Literacy for Infants & Toddlers: Setting the Foundation The foundation of language and literacy are acquired before children actually begin to talk and read. This session will take a look at how language and literacy skills are developed in infants and toddlers. We will engage in hands-on activities that highlight how to differentiate the learning activities for all children. * This session is a pre-requisite for this afternoons sessions: Infant & Toddler Language & Literacy Throughout the Classroom AND Infant & Toddler Language & Literacy Working with Parents.	Patti Jo Wilson Professional Development Specialist Lakeshore Learning Materials Yonkers, New York PJWilson@lakeshorelearning.com	50	Katmai

WEDNESDAY: SESSIONS-AT-A-GLANCE

NAEYC STANDARD	LEVEL	AGE GROUP	WORKSHOP TITLE & DESCRIPTION	PRESENTER(S)	CAPACITY	ROOM
Wednesday, January 25th 1:30-3:00						
Health	Established Professionals	All	Ask the Feeding Expert What do I do to get children to eat well and how do I talk to parents to support children at home? This session is short on the theoretical and long on the practical and applied. We'll address the application of the Satter Feeding Dynamics Model (fdSatter) using your everyday challenging experiences with feeding children. Bring your puzzling, real world situations for an engaging discussion focused on empowering children to eat and grow well and empowering parents to feed well at home.	Keira Oseroff, MSW, LCSW Faculty, Ellyn Satter Institute Madison, WI keira@ellynsatterinstitute.org	100	Aleutian
Leadership & Management	Valuable to All	Adults	Leadership & The Change Challenge: Best Practices when Facing a Change Are you dealing with and/or expected to manage change? This session will highlight the need for leadership to effectively plan for and manage change, and will address the subsequent challenges that follow change in the workplace. You will: Increase your knowledge of the human relationship with change; Learn how to guide children, teams, programs, organizations (and yourself!) through a change; Participate in a fun, engaging, experiential change activity; Address the most common change challenge: resistance; and learn how to implement five key practices when dealing with any type of change in this session.	Karen Kirk, Owner Synergistic Solutions On behalf of The Strive Group Anchorage, AK KarenKirk@gci.net	100	Denali
Teaching	Valuable to All	Birth-3	Infant & Toddler Language & Literacy Throughout the Classroom Language & Literacy in Math sounds much different than language and literacy in dramatic play. We will explore language and literacy in all areas of the classroom. Not only how it looks but how it sounds as well. We will use hands-on and small group activities as a means of examining best practices. Language & Literacy for Infants & Toddlers: Setting the Foundation is a <u>pre-requisite</u> for this afternoon's session.	Patti Jo Wilson Professional Development Specialist Lakeshore Learning Materials Yonkers, New York PJWilson@lakeshorelearning.com	80	Katmai
Physical Environment	Valuable to All	All	Building a Child's Community Through Inclusive Play Leah Boltz, the founder of Parks for All, Alaska's grassroots inclusive play movement, will tell the story of Alaska's changing play-scape. When this mother of a child with spina bifida realized there were no places for her daughter to play and learn with her peers, she engaged her community and helped build Alaska's first fully inclusive Boundless Playground. Through her hometown stories, perspective-changing scenarios, and workshop activities, this session will define inclusive play, identify the difference between ADA requirements and inclusive playgrounds, explain why inclusiveness is important to learning environments, highlight the importance of community relationship building in a child's education, and outline the critical role early educators have in inclusive play and education.	Leah Boltz, Founder Parks for All Anchorage, AK lboltz@bettisworthnorth.com	80	King Salmon
Physical Environment	Emerging Professionals	3-5	Creative Learning Environments We'll take a look at how classroom environment affects children's learning. By using the CLASS (Classroom Assessment Scoring System) and coaching to fidelity checklist to better understand positive climate. Make-It-Take-It for classroom and outdoor environment included.	Maria Sicurella, & Debbie Weber, Center Directors Kids' Corp, Inc. Anchorage, AK Msicurella@kcialaska.org dweber@kcialaska.org	50	Iliamna

Laugh at yourself and children will learn to laugh at their own mistakes.
 A role model is a very powerful thing.

Gigi Taylor Schweikert
 From her book, Teacher Tips

WEDNESDAY: SESSIONS-AT-A-GLANCE

NAEYC STANDARD	LEVEL	AGE GROUP	WORKSHOP TITLE & DESCRIPTION	PRESENTER(S)	CAPACITY	ROOM
Wednesday, January 25th 3:15-4:45						
Health	Established Professionals	All	Let's Move! Child Care Let's help the youngest Alaskan's grow up at a healthy weight. The national Let's Move! Child Care program encourages and supports ECE providers to make positive changes in their programs around healthy food and beverages, physical activity, screen time and infant feeding. We'll explore best practices, tips and resources to help you become a Recognized Let's Move Child Care Provider and help your kids eat, play, grow and develop healthy habits for life.	Diane Peck, MPH, RDN ECE Obesity Prevention Coordinator AK Dept. of Health & Social Services Anchorage, Alaska Diane.peck@alaska.gov	100	Aleutian
Leadership & Management	Valuable to All	Adults	Soft Skills Deficiency in the Emerging Labor Market Interested in expanding and developing your workforce or in preparing your customer's for success in their future endeavors? This presentation will give your information regarding the emerging soft skills deficiency in the labor market and the subsequent workplace consequences or challenges that result. In this presentation you will gain an understanding of: Growing trend of soft skills gap and its impact on the economy; The impact of incessant technology use, and tips on managing it; A pragmatic and working definition of Emotional Intelligence (EI) and how it impacts interpersonal relationships at work and at home; and How to improve our EI acumen.	Jeff Lincoln, Owner Lincoln Consulting On behalf of The Strive Group Anchorage, AK jeff@lincolnconsulting.biz	100	Denali
Teaching	Valuable to All	Birth-3	Infant & Toddler Language & Literacy Working with Parents Parents are children's lifelong teachers. Let's work together to bridge the learning between school and home. We will discuss ways that parents and teachers can support each other in the language and literacy development of children. We will play with manipulatives that aid in the learning as well as share ideas of engaging parents in the learning process. Language & Literacy for Infants & Toddlers: Setting the Foundation is a <u>pre-requisite</u> for this afternoons session.	Patti Jo Wilson Professional Development Specialist Lakeshore Learning Materials Yonkers, New York PJWilson@lakeshorelearning.com	80	Katmai
Physical Environment	Emerging Professionals	3-5	Use Your Words, but be Selective when Dealing with Attachment Disorder This presentation will be about how to use the environment to prevent anxiety in children. We will focus more on preventing anxiety in children whose home lives are stressful. During our presentation we will discuss physical environments and appropriate room arrangement for continuity throughout a center or school.	Qiana Coleman, Mentor/Coach Steffi Redhead, Center Director Kids' Corp, Inc. Anchorage, AK Qiana.Coleman@kcialaska.org	50	Iliamna



Friday, Jan. 27th 5:00-7:00 A Painting Party— Chart Room \$30

Come Join the Fun! Special Fundraiser for Anchorage AEYC A Painting Party

Join Anchorage AEYC on Friday night, upstairs in the Chart Room, for a fun, fun, time at a Painting Party! Cost is \$30— to be paid at the conference. We'll be painting the Northern Lights! There will be a trunk sale of previous art. Funds raised by these two events will go towards the Anchorage AEYC Early Childhood Education Scholarships.



Invite your friends too!

You do not have to be registered at the conference to attend.
Sign up at the Registration Desk by Thursday afternoon!

Thursday January 26, 2017

AGENDA IN DETAIL

7:30-5:30	REGISTRATION/CHECK IN/INFORMATION DESK OPEN	Promenade
9:30-5:30	NAEYC/LOCAL ALASKA AFFILIATES MEMBER LOUNGE	Dillingham
	This year's conference features a brand-new perk for NAEYC members—their very own member lounge! Members are able to grab a snack, relax & network, have access to special giveaways and speak with Anchorage AEYC board & conference members. Convince a friend to become a member and receive an extra door prize ticket!	
7:30-8:00	CONTINENTAL BREAKFAST	Alaska
	Menu: Fresh pastries, fruit, juice, coffee, tea, hot chocolate	
8:00-9:45	OPENING GENERAL SESSION	Aleutian/Alaska
	KEYNOTE: Heather Kinzie Leading the Children of Tomorrow	
	Join us for this inspiring general session in which Heather will offer her thoughts and insights about positively managing change, whether it be in the playroom, the classroom, or the boardroom. Resilience is a competency Heather believes is needed for ultimate success. To that end, this session will highlight six different ways we, as leaders, can develop our own resilience and that of those we lead, educate and inspire.	
9:00-2:55	SILENT AUCTION.....	Lobby down from Registration
	Participate in the silent auction. 100% Proceeds support Anchorage AEYC Scholarship Fund.	
9:45-11:45	SEMINAR SESSIONS	
11:45-1:15	LUNCH ON SITE—Lunch included in Conference Registration Fee	Aleutian/Alaska
	Menu: Cold Lunch Buffet Fresh Green salad, potato salad, vegetable salad & fresh fruit salad, tomatoes, assorted cheeses, grilled vegetable wraps, turkey, ham, assorted bread, desserts, coffee/tea.	
1:30-3:00	WORKSHOP SESSIONS	
3:15-4:45	WORKSHOP SESSIONS	
5:00-7:00	CONTINUING EDUCATION CREDIT CLASS AND REGISTRATION	Prince William
	Class requirements listed on page 7. Additional fee of \$74 for credit class.	

THURSDAY: SESSIONS-AT-A-GLANCE

NAEYC STANDARD	LEVEL	AGE GROUP	WORKSHOP TITLE & DESCRIPTION	PRESENTER(S)	CAPACITY	ROOM
Thursday, January 26th 9:45-11:45						
Teachers	Valuable to All	Adults	Lowering Stress and Maintaining Motivation Developing effective stress management skills can go a long way toward improving the work environment and can also have a significant positive impact on maintaining staff motivation. Working with Aesop's fable "The Goose with the Golden Eggs", you'll learn techniques staff can implement to lower stress and maintain both physical and mental health. This session is repeated on Friday, 9:45-11:45 in the Aspen/Spruce Room.	Cathy Cole, Early Care & Education Consultation Riddle, Oregon Colamare1@aol.com	100	Denali
Health	Valuable to All	Birth-3	Sleep Baby SAFE This session will raise awareness about the problem of Alaska infants dying in a sleep environment, and risk reduction strategies to promote infant safe sleep. We'll identify trends related to infant death in Alaska; practices that reduce the risk of SIDS & sleep related death (safe sleep practices) and practices that increase the risk of SIDS and sleep related death (unsafe sleep practices).	Abigail Newby-Kew, Epidemiology Specialist Sabra Anckner, RN, BSN Perinatal Nurse Consultant Women's, Children's & Family Health, State of AK DHSS Anchorage, Alaska Abigail.newby-kew@alaska.gov Sabra.ankner@direct.dhss.akhie.com	80	Katmai
Leadership & Management	Valuable to All	All	State of Alaska & Municipality of Anchorage Child Care Licensing Updates Child Care Licensing is child focused, family friendly and fair to providers. During this session, Licensing Managers from the State of AK & Municipality of Anchorage Child Care Licensing Programs will discuss updates for licensing regulation and code, review new information and share statewide licensing statistics and trends. Come join us!	Staci Collier, Licensing Program Manager State of Alaska Child Care Licensing Kathy Lynch, MoA Child Care Supervisor Anchorage, Alaska Staci.collier@alaska.gov Lynchkm@muni.org	50	Iliamna

THURSDAY: SESSIONS-AT-A-GLANCE

NAEYC STANDARD	LEVEL	AGE GROUP	WORKSHOP TITLE & DESCRIPTION	PRESENTER(S)	CAPACITY	ROOM
Thursday, January 26th 9:45-11:45						
Families	Experienced Professionals	Birth-3, 3-5, Adults	<p>Flourishing Families: Exploring Service Components for Children Exposed to Intimate Partner Violence</p> <p>A growing body of research describes the prevalent scope and profound impacts of exposure to intimate partner violence (IPV) during early childhood. For a number of reasons, younger children in Alaska have elevated risk and greater vulnerability to IPV exposures. Early Childhood programs often lack the capacity to meet the intensive needs of these families, resulting in unfavorable outcomes, but are there service components that could be adapted to help them? The presentation will dissect this problem into two parts. In the first part, participants will increase their understanding of the phenomenology of IPV in Alaska, and will expand their awareness of the special challenges and opportunities it presents in early education settings. In the second part, participants will be introduced to a model of a multi-partner early childhood IPV intervention program that the presenter is involved in, followed by exercises that allow participants to practice engaging in creative thinking, discussion, and planning around adapting service components and empirically-based principles into their own professional practices. The presentation will cross-reference IPV and ACES statistics for Alaska, and will assume that participants have a working background in two or more of the following early childhood content areas; developmental impacts of trauma, behavioral intervention modalities and techniques, cultural considerations, identifying and fostering resiliencies, family engagement strategies, interdisciplinary collaboration, reflective practices, and practical adaptations of service components into diverse settings (e.g., building trauma-informed classrooms, inter-agency coordination of services, etc.).</p> <p>This session is repeated on Saturday, 9:45-11:45 in the King Salmon Room.</p>	<p>Randy R. Ashford, MS, LPC Clinician/Consultant Alaska Child Trauma Center Anchorage, Alaska</p> <p>rashford@acmhs.com</p>	80	King Salmon
Curriculum	Established Professionals	3-5	<p>Using Place-Based Books in Science: Lessons from Rural Alaska</p> <p>Place-based approaches promote a relationship with the natural environment and allow for educators to embed Indigenous culture and knowledge into the classroom. This presentation will enhance your understanding of the importance of using place-based approaches, in conjunction with trade books, in teaching science. We will share examples of specific trade books and complimentary lesson plans that extend young children's understanding of science concepts within and beyond the classroom that also acknowledge and reinforce cultural ways of knowing. Opportunities for you to share examples and ideas of trade books and science lessons that have been successful in your classroom.</p>	<p>Akram Didari, Teacher LKSD Early Learning Program Bethel, Alaska</p> <p>Dr. Kathryn Ohle, Asst. Professor UAA, Anchorage, Alaska</p> <p>adidari@alaska.edu kohle@alaska.edu</p>	60	Aspen
Curriculum	Emerging Professionals	3-5	<p>Process vs. Product: Providing Meaningful Art Experiences for Preschoolers</p> <p>Young children are natural artists! Art in the early childhood classroom should support these budding artists by promoting art that allows them to explore, discover, and challenge their creativity. In this hands-on workshop we will discuss how to provide these experiences by using commonly found art materials. Come prepared to get creative and explore several activities that you can take back to your classroom.</p>	<p>Jennifer Wagner, Lead Teacher & Program Director, Anchorage Montessori School Anchorage, Alaska</p> <p>Fireweed @anchagemontessorischool.org</p>	50	Spruce

THURSDAY: SESSIONS-AT-A-GLANCE

NAEYC STANDARD	LEVEL	AGE GROUP	WORKSHOP TITLE & DESCRIPTION	PRESENTER(S)	CAPACITY	ROOM
Thursday, January 26th 9:45-11:45						
Leadership & Management	Established Professionals	All	Introduction to Learn & Grow: Alaska's Quality Recognition & Improvement System (QRIS) Learn & Grow is Alaska's Quality Recognition & Improvement System. This Level 1 Training is a requirement of Level 1 Quality standards. This session will provide you with an overview of Learn & Grow; Program Requirements; Personnel Requirements; What supports and other resources are available for programs to stay actively engaged in continuous quality improvement. This session is repeated on Saturday, 9:45-11:45, in the Fireweed room.	Vanessa Plurde-Smith, Professional Development Specialist, thread Sarah Wright, Professional Development Specialist, thread Anchorage, Alaska vsmith@threadalaska.org swright@threadalaska.org	50	Birch
Teachers	Established Professionals	All	Introduction to Alaska Early Care and Learning Core Knowledge and Competencies Come learn the purpose of the Early Care and Learning Core Knowledge and Competencies; How they are structured and how they can be used to support your ongoing professional development. This training is required of lead teachers and administrators who are working on achieving Level 2 requirements of Learn & Grow. This session is repeated on Saturday, 9:45-11:45, in the Lupine room.	Meghan Johnson Learn & Grow: Alaska's Quality Recognition & Improvement Director, thread Anchorage, Alaska mjohnson@threadalaska.org	50	Willow
			Networking Room		18	Prince William

thread is here to support you



Stop by **thread's** table to learn about all the ways we can support you year round, including:

- technical assistance
- 10 free hours of consultation
- assistance for CDA fees
- support for professional development
- travel reimbursements
- information on Learn & Grow
- and much more

Don't miss the presentation of the 2017 Cindy Harrington Heart & Mind Award and the new Quality Improvement Program of the Year during the Friday morning general session!

thread connecting early care & education to alaska

PROFESSIONAL DEVELOPMENT AND CONSULTATION
800.278.3723 www.threadalaska.org

licensed. safe. healthy. playful.



THURSDAY: SESSIONS-AT-A-GLANCE

NAEYC STANDARD	LEVEL	AGE GROUP	WORKSHOP TITLE & DESCRIPTION	PRESENTER(S)	CAPACITY	ROOM
Thursday, January 26th 1:30-3:00						
Teachers	All	Adults	Working with Challenging People Do you work with challenging people? Then this workshop is for you! Information will be provided in developing effective communication skills, responding proactively and understanding levels of maturity. You will gain insights that will be of immediate, practical use in your everyday working life, regardless of your personal approach and educational background.	Cathy Cole, Early Care & Education Consultation Riddle, Oregon Colamare1@aol.com	100	Denali
Teaching	Emerging Professionals	3-5	Literacy in Early Years: How to Help Foster a Love of Reading When reading a book, is there no interest from the children? Do the books go untouched for days? Is there a child struggling with communication? Are you trying to find ways to incorporate books with activities? There is an answer and it revolves around literacy. Literacy is a developmental building block. It helps with verbal communication, written language, and the ability to understand others. As educators and parents, we can help build up a child's language and foster a love of reading. Come learn about the importance of literacy for young children and some new techniques and ideas for incorporating books at home and in the classroom. This session is repeated on Saturday, 1:30-3:00 in the Iliamna Room.	Heather Plumb, Home Visitor CCS Early Learning Wasilla, Alaska hplumb@ccsalaska.org	50	Katmai
Leadership & Management	Emerging Professionals	Adults	Child Care Assistance Program Changes The State of Alaska, Child Care Program Office will be presenting changes within the Child Care Assistance Program due to the revised federal and state laws. Learn about the changes impacting provider and family participation in the Child Care Assistance Program and how they will affect your child care business.	Janice Braden, Program Coordinator II State of Alaska, Child Care Program Office Anchorage, Alaska janice.braden@alaska.gov	50	Iliamna
Assessment Of Child Progress	Experienced Professionals	5-8	Using Authentic Assessment in the Early Childhood Classroom Authentic assessment describes a process of gathering information that is then used to help teachers make instructional decisions. It is ongoing, occurs in a naturalistic setting, emphasizes what children know, keeps the whole child in mind, and helps teachers plan, measure progress, work with families, and differentiate curriculum. In this session, learners will reflect on what their assessment practices look like now, review practices related to good authentic assessment, and practice linking authentic assessment practices to their instructional planning. This approach can help guide decision making that will lead to more inclusive, engaging, and developmentally appropriate classroom practices. This session is repeated on Friday, 1:30-3:00 in the Birch room.	Kathryn Ohle, Assistant Professor of Early Childhood, University of Alaska, Anchorage & Hattie Harvey, Assistant Professor of Early Childhood, University of Alaska, Anchorage Anchorage, Alaska kohle@alaska.edu haharvey@alaska.edu	60	Aspen



THURSDAY: SESSIONS-AT-A-GLANCE

NAEYC STANDARD	LEVEL	AGE GROUP	WORKSHOP TITLE & DESCRIPTION	PRESENTER(S)	CAPACITY	ROOM
Thursday, January 26th 1:30-3:00						
Teaching	Emerging Professionals	3-5	Using Daily Transitions as a Learning Opportunity During this workshop, using daily transitions as a learning Opportunity, you will gain knowledge, skills, strategies, and materials on making transitions a learning opportunity through discussions, hands-on opportunities and make-it-take-it projects.	Sarah Stout, Mentor Coach Coordinator Rebecca Larson, Child Development Asst. Kids' Corp, Inc Anchorage, Alaska sarah.stout@kcialaska.org rebecca.larson@kcialaska.org	50	Spruce
Relationships	Established Professionals	Birth-3 3-5 5-8	Sense of Belonging and Academic Success: Research & Promising Practices for Children Come hear up-to-date research findings and participate in a series of activities to learn about social belonging. A strong sense of belonging (feeling accepted and valued by others) has been linked to many aspects of success in school and in life, including physical health, mental health, and academic success. Evidence suggests this is particularly critical for children who are likely to question their belongings, such as youth of color or children from economically disadvantaged families. We will invite attendees to share how they utilize culturally responsive practices, and introduce actionable strategies to promote belonging in early learning settings.	Dr. Shannon Davidson, Researcher Education Northwest Portland, Oregon shannon.davidson@educationnorthwest.org	50	Birch
			Pre-K & Pre-Elementary Meeting	Facilitators: Megan Johnson Anji Gallanos	18	Prince William
Teaching	Valuable to All	All	The HANDLE Perspective on Behavior HANDLE is a systems approach that views all behavior as communication, rather than symptoms that need to be masked or controlled. HANDLE treats presentations of ADD, Autism, dyslexia, learning differences, balance and many more issues. This introduction will give you tools you can use to help students, parents, staff and yourself to function more efficiently, enhance weak systems, and understand how your brain and body work together. We'll do fun and easy activities you can use with students of all ages and abilities.	Raissa D'Antonio Teacher, St. Mary's Creative Playschool Anchorage, Alaska mhenrie1@cs.comc	60	Willow
Teaching	Emerging Professionals	3-5	Classroom Success with Song! This workshop will explore various songs and interactive fingerplays to help teachers with: Behavior Management and transitions; Circle Time Fun; and Physical activity. It will include take-away materials for you to apply in your classroom when you return and time to share your personal favorite songs with your peers. Limited to 25 This session is repeated on Friday, 1:30-3:00 in the Denali	Emily Urlacher, Center Director Natye Briggs, Center Director Kids' Corps Inc. Anchorage, Alaska eurlacher@kcialaska.org Nbriggs2kcialaska.org	25	Fireweed
Thursday, January 26th 1:30-4:45						
Teaching	Emerging Professionals	3-5	Introduction to the CLASS Tool During this interactive program, you will gain an understanding of the Classroom Assessment Scoring System (CLASS), its various uses, and the teacher-child interactions that support children's learning. You will understand what the CLASS Tool measures; The link between effective teacher-child interactions and children's learning gains; Identify the teacher-child interactions associated with each CLASS dimension.	Rebecca Berlin, PhD Chief Strategy Officer, Teachstone Charlottesville, VA rebecca.berlin@teachstone.org	80	King Salmon



THURSDAY: SESSIONS-AT-A-GLANCE

NAEYC STANDARD	LEVEL	AGE GROUP	WORKSHOP TITLE & DESCRIPTION	PRESENTER(S)	CAPACITY	ROOM
Thursday, January 26th 3:15-4:45						
Teaching	Emerging Professionals	All	Practice Play1 Sounds—Stories—Movements Perfect for Life Changes in Growing Kids! Our goals are healthy children in families, schools, cultures and communities. Our mission is to help young ones use sounds, stories and movements to develop their potential with play to act in our world. Music, dance and storytelling helps kids connect to parents/teachers with life lessons to share. Play begins at home and education begins with family activities. We use percussion instruments and performing arts techniques to engage children in collaborative skits. These have lessons about taking care of ourselves, friends and family. Ideas, topics and themes are woven into a tale that has movement and music/sound components. The story concludes with a group resolution to the plot situation. We spark the hearts and minds of little ones and they return that creative energy tenfold! No experience necessary! Your heartbeat and smile is all we need! Join us to share common ground that nurtures amazing kids! This is an active, hands-on workshop and your age may change from preschool to where you are now! Good humor is an integral part of what we do. Laughter is FUNdamental and included for free!	Eddie Wood, Performing Artist Education Consultant Homer, Alaska rumbalaska@yahoo.com	100	Aleutian
Leadership & Management	Valuable to All	Adults	Building a Resilient Workforce Managers and Supervisors often serve as “change agents” for their organizations and, just as much, are met with resistance. Too often change is perceived as “forced” upon the individual and bouncing back or recovering from such force is difficult. Resiliency becomes the distinguishing competency between employees who can positively move forward and those who cannot. A leader’s role is to recognize the difference, and take steps to close the gap. This 90 minute session pairs nicely with Heather Kinzie’s general session in that it drills down into specific ways a leader can develop his/her employee’s resilience. In addition, Heather will present her insights about how we can foster a continuous learning and improvement culture which ultimately, will enable our future success.	Heather Kinzie, Director Consulting Services The Strive Group Anchorage, Alaska Heather.kinzie@thestrivegroup.com	100	Denali
Leadership & Management	Valuable to All	Adults	Increase Access to Quality Program Administrators & staff are invited to join State of Alaska, Child Care Program Office for an overview of the Programs available to assist families and child care providers. An overview of the State of Alaska Child Care Assistance, Alaska Inclusive Child Care and Child Care Grant Programs and how they are interconnected will be presented along with a round table discussion to gather input and honest feedback from child care providers about what is working well and where improvements are needed.	Matt Bockhorst, Eligibility Technician II, Child Care Program Office, Anchorage, Alaska Matt.bockhorst@alaska.gov	50	Iliamna
Teaching	Emerging Professionals	3-5	Construction Zone: Building a Concrete Classroom Community Put on your hard hat! This workshop will give you everything you need to draw up the plans for building a strong community. Together we will break the caution tape with tips and tricks to lay the foundation for your classroom. This workshop is repeated on Friday, Jan. 27th, 3:15-4:45, in the Birch room.	Michelle Cook, Family Partnership Coordinator Tabatha Peterson, Center Coordinator CCS Early Learning Wasilla, Alaska mcook@ccsalaska.org tpeterson@ccsalaska.org	60	Aspen



THURSDAY: SESSIONS-AT-A-GLANCE

NAEYC STANDARD	LEVEL	AGE GROUP	WORKSHOP TITLE & DESCRIPTION	PRESENTER(S)	CAPACITY	ROOM
Thursday, January 26th 3:15-4:45						
Curriculum	Established Professionals	All	Northern Journeys: Arts Rich and Culturally Diverse Curriculum for Early Childhood Teachers and Children Northern Journeys is a collaborative project between the university, the school district and local art organizations including local artists and culture bearers. We are developing culturally responsive curriculum and arts integration models to honor the diversity of the community.	Hilary Seitz, Professor of Early Childhood, Jaime Whitney, UAA Student University of Alaska, Anchorage Anchorage, Alaska hjseitz@alaska.edu jmwhitney@alaska.edu	50	Birch
			Pre-K & Pre-Elementary Meeting	Facilitators: Megan Johnson Anji Gallanos	18	Prince William
Teaching	Established Professional	3-5	Beyond "Wheels on the Bus": Music Literacy in the Preschool Classroom This presentation will cover the importance of music literacy in the general education classroom. One need not be a musician to teach preschool aged children the fundamentals of music. Elements of music literacy as they relate to 3 to 6 year olds will be presented and demonstrated how to incorporate accessible music activities in the classroom. Activities include Echo singing and clapping, rhythm building, and circle dances.	Cecelia Pullen, Music Teacher Anchorage Montessori School Anchorage, Alaska ceceliapullen@gmail.com	50	Fireweed

Fundraising for Anchorage AEYC

THE PERFECT FUND RAISER!

Come Join the Fun!
Special Fundraiser for
Anchorage AEYC—A Painting Party
Friday, Jan. 27th 5:00-7:00
\$30 Chart Room



Join Anchorage AEYC on Friday night, upstairs in the Chart Room, of the conference for a fun, fun, time at a Painting Party! Cost is \$30— to be paid at the conference. Trunk sale will also take place of previous paintings. Funds raised by these events will go towards the Anchorage AEYC Early Childhood Education Scholarships.

Invite your friends too! You do not have to be registered at the conference to attend. Visit the Registration Desk to register or for more info contact Anna at handsoff73@hotmail.com



FredMeyer

Do you shop regularly at Amazon or Fred Meyer? You can help raise funds for Anchorage AEYC with every purchase you make!

Please follow the directions below:

Amazon: Go to <http://smile.amazon.com/> to start your Amazon Shopping process. Enter "Anchorage Association for the Education of Young Children" in the "pick your own charitable organization" space to choose our school.

Fred Meyer Community Rewards: Sign up to link your Rewards Card to Anchorage AEYC by visiting: <https://www.fredmeyer.com/topic/community-rewards-4>



There has never been a better time to join NAEYC.

Be a part of your professional association.

Learn about all of our member benefits and join today.

[NAEYC.org/Membership](https://naeyc.org/Membership)

NAEYC members enjoy a **20 percent discount** on all items in our store. They also have access to frequent **member-only sales, offering discounts of 50 percent or more.**

But that's just the beginning. NAEYC is committed to serving our members better than we ever have before.



Visit [NAEYC.org/Membership](https://naeyc.org/Membership) and join today!

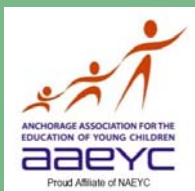

Anchorage Association for the Education of Young Children



Since 1971, Anchorage AEYC has worked to:



Promote Public Support & Policies

- Advocacy
- Outreach
- Public Awareness

Support Excellent Early Education

- Accreditation
- Position Statements
- Professional Development



Build a Profession

- Inclusive
- Leadership Development
- Standards
- Equitable Compensation



Improve Teaching & Learning

- Professional Preparation
- Research
- Resources



*You may not know it, but if you are a member of Anchorage AEYC
you are a member of NAEYC & Anchorage AEYC*

National

National Association for the Education of Young Children (NAEYC)

PO Box 97156

Washington, DC 20090

Website: www.naeyc.org

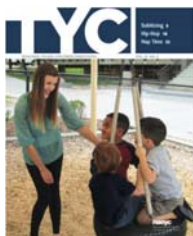

Local Alaskan Affiliates

Anchorage AEYC

E-mail: anchorageaeyc@mtaonline.net

Website: www.anchorageaeyc.org



AEYC Southeast

E-mail: info@aeyc-sea.org

Website: www.aeyc-sea.org



Northern Interior Alaska AEYC (NIA-AEYC)

Website: www.niaaeyc.org

Email: niaaeyc@gmail.com





June 11-14, 2017 San Francisco, CA

Join us again next fall!

2017 NAEYC
Annual Conference
November 15-18 | Atlanta, Georgia



AEYC-SEA Early Childhood Symposium

March 17-18, 2017

Register Now!

Explore, Engage, Energize: Learning through the Senses

Join us for lively workshops and captivating speakers, focusing on effective strategies for engagement that involve sensory exploration and are responsive to the skill and developmental level of each child. Guest Speakers: Carol Stock Kranowitz, M.A., Amanda Morgan, MS, & Tom Bedard, Med

Registration online is now open at:
www.aeyc-conference.org.

Questions? Interested in presenting?
Please contact AEYC,
info@aeyc-sea.org or 1-888-785-1235.

Conference Events



NAEYC/Local Alaska Affiliates Members Lounge Dillingham Room—Thursday-Friday-Saturday

This year's conference features a brand new-perk for NAEYC members—their very own member lounge! Members are able to grab snacks, have access to special giveaways, and chat with Anchorage AEYC Board & Committee Members. We look forward to seeing you there!



Silent Auction Thursday-Saturday 9:00 a.m.—3:00 p.m.

The Anchorage AEYC annual Silent Auction supports funds for Anchorage AEYC Early Childhood Education Scholarships. 100% of funds go toward the scholarships. New items each day.



Come Join the Fun! Special Fundraiser for Anchorage AEYC—A Painting Party 5:00-7:00 Chart Room \$30



Join Anchorage AEYC on Friday night, upstairs in the Chart Room, of the conference for a fun, fun, time at a Painting Party! Cost is \$30— to be paid at the conference. Trunk sale will also take place of previous paintings. Funds raised by this event will go towards the Anchorage AEYC Early Childhood Education Scholarships.

Invite your friends too! You do not have to be registered at the conference to attend. Visit the Registration Desk to register or for more info contact Anna at handsoff73@hotmail.com



Northern Interior AEYC Conference October 20-21, 2017

Anchorage AEYC EC Conference Big or Small Success for ALL: Supporting the Leaders of Tomorrow January 24-27, 2018



naeyc
WEEK of the YOUNG CHILD™
April 24-28, 2017

The Week of the Young Child is an annual celebration hosted by the National Association for the Education of Young Children (NAEYC) celebrating early learning, young children, their teachers and families.



Music Monday! April 24, 2017

Sing, dance, celebrate, and learn

Through music, children develop math, language, and literacy skills—and of course, have fun while being active! This year's song is "One Love," as performed by Aaron Nigel Smith and the One World Chorus. Visit www.naeyc.org to download once available.

Try this: Find the beat to connect music, movement and math. Practice clapping, drumming, or stomping to the beat of the music while counting.



Taco Tuesday April 25, 2017

Healthy eating and fitness at home and school

This fun, food-themed day is more than just cheese and crackers. Cooking together connects math with literacy skills, science, and more. With the rise in childhood obesity, you can encourage healthy nutrition and fitness habits at home and in the classroom by creating your own healthy snacks.

Try this: Measure your ingredients while making your snacks! Ask children if they'd like the same or different amount of each ingredient.



Work Together Wednesday April 26, 2017

Work together, build together, learn together

When children build together they explore math and science concepts and develop their social and early literacy skills. Children can use any building materials — from a fort of branches on the playground to a block city in the classroom, or a hideaway made from couch pillows at home.

Try this: Practice organizing blocks by size! Try building a block tower with large blocks on the bottom and little blocks on top!



Artsy Thursday April 27, 2017

Think, problem solve, create

Children develop creativity, social skills and fine muscles with open-ended art projects where they can make choices, use their imaginations and create with their hands. On Artsy Thursday celebrate the joy and learning children experience when engaged in creative art making. Use any materials—from crayons to paint, clay to crafts!

Try this: Bring art outdoors! Offer dark and light paper, chalk and pastels, and suggest children create their own versions of the day and night sky.



Family Friday April 28, 2017

Sharing family stories

Engaging and celebrating families is at the heart of supporting of youngest learners. NAEYC applauds family members' role as young children's first and most important teachers.

Try this: Invite parents for a Family Friday breakfast, where children can prepare and share breakfast treats with their families!

Post your fun activities & events to the NAEYC's Facebook page or post to Twitter using the hashtag "woyc17".

Friday, January 27, 2017

AGENDA IN DETAIL

7:30-4:30	REGISTRATION/CHECK IN/INFORMATION DESK OPEN	Promenade
9:30-5:30	NAEYC/LOCAL ALASKA AFFILIATES MEMBER LOUNGE	Dillingham
	This year's conference features a brand-new perk for NAEYC members—their very own member lounge! Members are able to grab a snack, relax & network, have access to special giveaways and speak with Anchorage AEYC board & conference members. Convince a friend to become a member and receive an extra door prize ticket!	
7:30-2:55	SILENT AUCTION.....	Lobby down from Registration
	Participate in the silent auction. Not only will you come away with terrific items, you will be giving someone else the opportunity to attend the conference in the future. Proceeds support Anchorage AEYC scholarships fund.	
7:30-8:00	CONTINENTAL BREAKFAST	Alaska
	Menu: Muffins, fruit, juice, coffee, tea & hot chocolate	
8:00-9:30	OPENING GENERAL SESSION	Aleutian/Alaska
	KEYNOTE: Holly Elissa Bruno	Keynote Address: Partnering with change: We have to do what!
	When you share a new idea to change things for the better, how thrilled are the people around you about making a change? Resistance, in any form, undermines constructive change. Find out how courage and savvy usage of change strategies can turn nay-sayers into hooray-sayers. Are you ready?	
9:45-11:45	SEMINAR SESSIONS	
11:45-1:15	LUNCH ON YOUR OWN	
1:30-3:00	WORKSHOP SESSIONS	
3:15-4:45	WORKSHOP SESSIONS	
5:00-7:00	SPECIAL EVENT: ANCHORAGE AEYC PAINTING PARTY.....	Chart Room
	Join us for a painting party. Cost is \$30 which includes all painting materials and canvas. A portion of the proceeds will go towards Anchorage AEYC Scholarship Fund. RSVP and pay at the Registration Desk.	
5:00-7:00	CONTINUING EDUCATION CREDIT CLASS WRAPUP.....	Prince William Board Room

JOIN NAEYC TODAY!

NAEYC promotes high-quality early learning for all children, birth through age 8, by connecting practice, policy and research. We advance a diverse, dynamic early childhood profession and support all who care for, educate, and work on behalf of young children.



www.naeyc.org/membership

No other association gives you access to the same amount of information from leading early childhood experts in the field. NAEYC membership ensures you will have all of the tools needed to excel in your job, grow in your career, and stay connected to a professional network of educators across the country. Visit the Membership Lounge (Dillingham room) to learn more!

FRIDAY: SESSIONS-AT-A-GLANCE

NAEYC STANDARD	LEVEL	AGE GROUP	WORKSHOP TITLE & DESCRIPTION	PRESENTER(S)	CAPACITY	ROOM
Friday, January 27th 8:00-4:00						
Leadership & Management	Experienced Professionals	Adults	Alaska Pre-Elementary Grantees Meeting Alaska Pre-Elementary Grantees from 16 districts will meet to participate in a shared learning community. The Department of Education and Early Development is sponsoring this opportunity to better support the development of program administrators and district leaders providing pre-school in their home districts. District leaders will meet to learn and share regarding foundational knowledge and competencies needed to support high-quality practices in the early years. This event is limited to only those district leaders who are receiving Alaska Pre-Elementary grant funds. For more information please contact: Anji Gallanos anji.gallanos@alaska.gov	Anji Gallanos Early Learning Administrator Alaska Department of Education and Early Development Anji.gallanos@alaska.gov	50	Katmai

FRIDAY: SESSIONS-AT-A-GLANCE

NAEYC STANDARD	LEVEL	AGE GROUP	WORKSHOP TITLE & DESCRIPTION	PRESENTER(S)	CAPACITY	ROOM
Friday, January 27th 9:45-11:45						
Leadership & Management	Valuable to All	All	Managing Legal Risks in Early Childhood Programs: Case Studies in Prevention & Problem Solving Early childhood educators make decisions with legal ramifications daily. Few of us are trained as attorneys and not many of us can afford a lawyer on retainer. Learn how to prevent and address legal issues (hiring, firing, ADA, staff babysitting, privacy in cyberspace) in the workplace. Let's address those legal hotspots through an engaging, true-to-life case study approach.	Holly Elissa Bruno, Educator, International Keynote Speaker Fitchburg, Massachusetts www.hollyelissabruno.com	100	Aleutian
Teaching	Valuable to All	All	Maximizing Learning Through Music Do you want to maximize student learning and help them have fun while learning? If you do, then join us as we sing, chant, and make music while learning important information and concepts! Children of all ages really respond to music, to body movement, and to the use of musical instruments while they sing and chant content and concepts. If you think you are not very musical, come and find out that you are more musical than you ever believed and that you will be able to help children enjoy learning, too, through the medium of MUSIC. We will be using songs, chants, various tonal and rhythm instruments and show how the body movements and repetition help children develop language and concepts in various content areas.	Alice Wright Belden, Author & Musician LaVon Bridges, ELL Program Specialist, Musician, Anchorage Education Ctr, ASD Anchorage, Alaska Alice9_19_39@yahoo.com Bridges_LaVon@asdk12.org	100	Denali
Relationships	Emerging Professionals	All	What I Do Today will Change the Future of Tomorrow Educators will discover and develop ways in which to engage children and families in building positive relationships. The importance of parent to teacher and child to teacher relationships will be the basis for each topic in this workshop. Educators will connect with one another and share ideas as well as engage in meaningful activities that promote an understanding of why relationships are so important. Strong relationships pave the way for all future learning to take place. Every child needs that one person who is crazy about them; sometimes YOU are that only person for them.	Kellie Dere, Lead Teacher I Kayla Hayes, Lead Teacher III & Associate Administrator Credit Union 1 Anchorage, Alaska derek@cu1.org kmilles@arctic.net	50	Iliamna
Teachers	Valuable to All	Adults	Lowering Stress and Maintaining Motivation Developing effective stress management skills can go a long way toward improving the work environment and can also have a significant positive impact on maintaining staff motivation. Working with Aesop's fable "The Goose with the Golden Eggs", you'll learn techniques staff can implement to lower stress and maintain both physical and mental health.	Cathy Cole, National Early Childhood Specialist for Kaplan Early Learning Company Riddle, Oregon www.kaplanco.com	100	Aspen Spruce
Teaching	Established Professionals	3-5	Using Social Stories to Support Children's Social-Emotional Development In this workshop, participants will learn how to use and create social stories to support children's social-emotional development. Participants will learn about the key strategies teachers can use while preparing a social story, while reading the story (e.g., children as readers, repeated reading), and after the story is read (e.g., role playing). Social stories are ways to help children understand social situations, and can be individualized to meet the unique needs of individual or groups of children. Participants will also gain access to a variety of resources for developing their own social stories.	Dr. Hattie Harve, Assistant Professor, Early Childhood, UAA, College of Education Callie Akins, Student EC Education, UAA Bethany Lee, Student EC Education, UAA haharvey@alaska.edu callieakins@gmail.com bjlee@alaska.edu	60	Birch

FRIDAY: SESSIONS-AT-A-GLANCE

NAEYC STANDARD	LEVEL	AGE GROUP	WORKSHOP TITLE & DESCRIPTION	PRESENTER(S)	CAPACITY	ROOM
Friday, January 27th 9:45-11:45						
Physical Environment 	Valuable to All	3-5	Setting the Stage for Learning: Room Arrangement as a Teaching Strategy <i>This training explores how the classroom environment effects young children's learning. As we set up our programs we can convey positive messages about learning. Room Arrangement as a Teaching Strategy offers specific strategies teachers can use to create positive and supportive environments for children. Participants will see how poorly organized environments can work against children and providers, and how a well-organized one can work for them, making both learning and teaching more creative, rewarding and enjoyable.</i>	Sarah Wright, Professional Development Specialist thread Anchorage, Alaska swright@theadalaska.org	50	Willow
			Networking Room		18	Prince William

Preschool

Ages 3-5

4 hr & 6.5 hr classes

No fees

Positions Available:

Family Advocates

Teachers

Assistant Teachers

Substitutes



Child Care

Ages 4 months—5 years

Monday—Friday

7am-5:30pm

9 Locations

4 in ASD schools

-Resources for the families

-Nutritious meals & snacks

-Volunteers welcome!

For more Information Call 272-0133

Or visit www.kcialaska.org

"We provide a Head Start to families with children who need it most"

QUALITY
IS TIED TO
compensation

Voters agree: Early childhood educators are paid too little and their wages should be raised.

naeyc

www.naeyc.org/profession

EDUCATORS
ARE
heroes!

Nearly **90%** of voters say early childhood educators are important members of their communities, on par with **firefighters and nurses**.

naeyc

www.naeyc.org/profession

INVEST
IN
early childhood

83% of voters would support a public investment in early childhood education that is used to **increase educators' wages**.

naeyc

www.naeyc.org/profession

FRIDAY: SESSIONS-AT-A-GLANCE

NAEYC STANDARD	LEVEL	AGE GROUP	WORKSHOP TITLE & DESCRIPTION	PRESENTER(S)	CAPACITY	ROOM
Friday, January 27th 1:30-4:45						
Relationships	Valuable to All	3-5	Positive Guidance Guidance is used in the classroom to help children understand limits, to make positive choices and to learn how to set inner self-controls. Appropriate guidance allows children to respect themselves and others. This workshop is designed to provide participants with an understanding of brain functions in relation to behavior; and how effective, positive guidance promotes permanent behavior change and assists children to cultivate respect for each other and the environment within a classroom setting. (The information shared during this workshop aligns with Conscious Discipline)	Cathy Cole, National Early Childhood Specialist for Kaplan Early Learning Company Riddle, Oregon www.kaplanco.com	100	Aspen/Spruce
Friday, January 27th 1:30-3:00						
Leadership & Management	Valuable to All	All	If You See Crazy Coming Down the Street, What Do You Do? Research On the Adult Brain Can Help You Stay Cool (and even happy) in Difficult Situations Negative forces can push an educator's buttons as we aim to stay upbeat: whining, gossip, disrespect, dishonesty, condescension or demands that feel overwhelmingly. What if you could prevent your buttons from being pushed, or at least quickly regain professional perspective when they do? Good news: Your brain has the capacity to help you step away from drama, face conflict with confidence, and find underlying solutions to difficult problems. By practicing bounce-back strategies one step at a time, you can triumph over negativity. Work is a joy again when you know how to use your brain to stay cool under pressure.	Holly Elissa Bruno, Educator, International Keynote Speaker Fitchburg, Massachusetts www.hollyelissabruno.com	100	Aleutian
Teaching	Emerging Professionals	3-5	Classroom Success with Song! This workshop will explore various songs and interactive fingerplays to help teachers with: Behavior Management and transitions; Circle Time Fun; and Physical activity. It will include take-away materials for you to apply in your classroom when you return and time to share your personal favorite songs with your peers. Limited to 25 This session is a repeat of Thursday's 3:15-4:45 session which was held in the Chart Room.	Emily Urlacher, Center Director Natye Briggs, Center Director Kids' Corps Inc. Anchorage, Alaska eurlacher@kcialaska.org Nbriggs2kcialaska.org	25	Denali
Teaching	Beginning/ Emerging	Birth-5	Early Literacy Begins at Birth: Building Pre-reading Skills in the Young Child Parents, caregivers and teachers can develop early literacy skills in children from birth. You will learn what early literacy is and how it is shaped by brain development in early childhood. You will learn developmentally appropriate strategies to cultivate five essential early literacy skills in the young child using five recognized practices. You will be able to apply these practices in the classroom and at home. I will highlight the positive impact of shared reading time on children from birth to age 3 and how to engage children in dialogic reading for a meaningful reading experience. I will also share with you what you need to know to borrow completely free resources that support early literacy from the Ready to Read Resource Center at Anchorage Public Library.	Samantha Blanquart Early Literacy Outreach Librarian Ready to Read Resource Center Anchorage Public Library Anchorage, Alaska BlanquartSR@ci.anchorage.ak.us	80	King Salmon
Teachers	Emerging Professionals	All	The Future of the World is in Our Classroom Each Day Teachers will reflect on current practices, build on strengths and grow from interactions with one another. Best practices throughout the classroom will be a strong presence. Teachers will gain perspective and knowledge through group conversations centered on relationship building, fundamentals for future learning and intentional teaching. A strong foundation for children's future learning is essential for educators to understand and have a working knowledge of. With these skills teachers will promote the best possible outcomes for our future communities.	Kellie Dere, Lead Teacher I Kayla Hayes, Lead Teacher III & Associate Administrator Credit Union 1 Anchorage, Alaska derek@cu1.org kmilles@arctic.net	50	Iliamna

FRIDAY: SESSIONS-AT-A-GLANCE

NAEYC STANDARD	LEVEL	AGE GROUP	WORKSHOP TITLE & DESCRIPTION	PRESENTER(S)	CAPACITY	ROOM
Friday, January 27th 1:30-3:00						
Assessment Of Child Progress	Experienced Professionals	5-8	Using Authentic Assessment in the Early Childhood Classroom Authentic assessment describes a process of gathering information that is then used to help teachers make instructional decisions. It is ongoing, occurs in a naturalistic setting, emphasizes what children know, keeps the whole child in mind, and helps teachers plan, measure progress, work with families, and differentiate curriculum. In this session, learners will reflect on what their assessment practices look like now, review practices related to good authentic assessment, and practice linking authentic assessment practices to their instructional planning. This approach can help guide decision making that will lead to more inclusive, engaging, and developmentally appropriate classroom practices. This session is a repeat of Thursday's presentation, 1:30-3:00, in the Aspen room.	Kathryn Ohle, Assistant Professor of Early Childhood, UAA & Hattie Harvey, Assistant Professor of Early Childhood, UAA Anchorage, Alaska kohle@alaska.edu haharvey@alaska.edu	60	Birch
Health	Emerging Professionals	3-5	Health Heroes to the Rescue! Come learn child-friendly nutrition, oral and physical health activities to do in a classroom or on home visits. Resources will be provided to take home and introduce to others. We will show you how to connect health with many other areas including science, math and literature to create lasting, healthy behaviors. We will make a fun snack so be ready to come and get active! This session is repeated on Saturday, 3:15-4:45, Birch room.	Kelsey Beecher, Health & Nutrition Coordinator & Ayla Richardson, Health Assistant Kids' Corps, Inc. Anchorage, Alaska Kelsey@kcialaska.org	50	Lupine
Assessment of Child Progress 	Emerging & Established Professionals	All	Observing with a Purpose Observing children to document development and behavior isn't just a "check the box" task which needs done to satisfy the administrator. Observation is an ongoing cycle which can influence classroom planning and activities, be a tool to communicate with families, and document a child's development over time. This session will review the benefits of documenting observations, various strategies to accomplish formal observations, and how to use this information to design classroom curriculum	Cassie Hulse, Director of Professional Development thread Anchorage, Alaska chulse@threadalaska.org	50	Willow
			Networking Room		18	Prince William
Teaching	Emerging Professionals	3-5	Teaching the Future in the 21st Century What is all this talk about 21st Century skills? How has the world changed and how do you as a teacher need to respond? Join us as we study the changing trends for learning and education and explore techniques for helping children and youth reach their full potential in an ever-changing world!	Heather Oleary, Program Manager II RuralCap Head Start Anchorage, Alaska heathero2269@yahoo.com	70	Fireweed

Please Be Courteous

**It's wonderful to catch up with colleagues
but please not while
speakers are addressing the group.**



FRIDAY: SESSIONS-AT-A-GLANCE

NAEYC STANDARD	LEVEL	AGE GROUP	WORKSHOP TITLE & DESCRIPTION	PRESENTER(S)	CAPACITY	ROOM
Friday, January 27th 3:15-4:45						
Teaching	Valuable to All	3-5	Up, Up, and Away with Parachute Play New and seasoned educators will learn how to incorporate parachute play into their classrooms daily routine. The parachute is a limitless tool that can encourage and build a plethora of skills. This session is repeated on Saturday, 3:15-4:45 in the Denali Rm.	Paige Chase, Associate Educator, Bridget Kelly, Family Educator, CCS Early Learning, Chugiak, AK pchase@ccsalaska.org bkelly@ccsalaska.org	100	Denali
Curriculum	Emerging Professionals	Birth-3	Active Infants, Enjoying the Senses through Play In this hands-on workshop we will explore various ways to safely incorporate art and sensory play into the infant's day. There will be a hands-on activity to try, with examples of how to differentiate the activity for the many ages and levels in an infant classroom. This session is repeated on Saturday, 3:15-4:45, Katmai room	Rebecca Larson, Child Development Assistant, Kids' Corps, Inc. Anchorage, Alaska rebecca.larson@kcialaska.org	80	King Salmon
Teachers	Emerging Professionals	3-5	Taking the Story One Step Further Our focus will be to read preschool books and taking it one step further. Come discuss how to further engage children with add-ons such as: finger plays, physical movement, songs, reflections and simple props.	Julie Vang, Center Director Donna Reisinger, Center Director Kids' Corps, Inc. Anchorage, Alaska JVang@kcialaska.org Donna.reisinger@kcialaska.org	50	Iliamna
Teaching	Emerging Professionals	3-5	Construction Zone: Building a Concrete Classroom Community Put on your hard hat! This workshop will give you everything you need to draw up the plans for building a strong community. Together we will break the caution tape with tips and tricks to lay the foundation for your classroom. This workshop is repeated on Saturday, Jan. 28th, 3:15-4:45, Denali room.	Michelle Cook, Family Partnership Coordinator Tabatha Peterson, Center Coordinator CCS Early Learning Wasilla, Alaska mcook@ccsalaska.org tpeterson@ccsalaska.org	50	Birch
Families 	Valuable to All	All	Building Productive Relationships with Families Based on the national Strengthening Families framework aimed at preventing child abuse by supporting the parenting role, this training will introduce the five protective factors every family needs along with strategies to build relationships between the family and the early educator to improve communication and decrease conflicts.	Reanne Queja, Professional Development Specialist thread Anchorage, Alaska rqueja@threadalaska.org	50	Willow
Teaching	Established Professional	3-5	What Does It Mean to Be "Kindergarten-Ready" in Alaska? In this workshop, participants will explore what it means to be "kindergarten-ready" in Alaska. Participants will learn about perceptions of kindergarten-readiness represented in the literature and hear the perspectives of Alaskan educators from around the state whom were interviewed as part of an undergraduate research project. Participants will consider their own perceptions of what it means for students to be "kindergarten-ready" as they discuss evidence-based instructional approaches and developmentally-appropriate assessment strategies to support our Alaskan kindergarten who enter school systems with a diversity of early experiences.	Sophie Leshan, College of Education Research Assistant University of Alaska Anchorage Anchorage, Alaska saleshan@alaska.edu	70	Fireweed



Conference Evaluation Questionnaire
 Please remember to complete the
2017 Conference Evaluation Questionnaire
 which will be sent to you
ELECTRONICALLY
 immediately following the conference.

Anchorage AEYC
VALUES your feedback
 which is used to
 evaluate the conference
 and to plan for 2018!
Thanks!

KAPLAN[®]

EARLY LEARNING COMPANY

1-800-334-2014 • www.kaplanco.com

Your Best Source for Early Childhood Products & Services!



Classroom Materials



Technology



Easy Online Ordering



Classroom Set-up



Professional Development



Playgrounds

For more information, contact:

Pam Tester

Territory Manager, Alaska
1-800-334-2014, ext. 6122
ptester@kaplanco.com

Saturday, January 28, 2017

AGENDA IN DETAIL

7:30-1:00	REGISTRATION/INFORMATION DESK OPEN	Promenade
7:30-5:00	NAEYC/LOCAL ALASKA AFFILIATES MEMBER LOUNGE	Dillingham
	This year's conference features a brand-new perk for NAEYC members—their very own member lounge! Members are able to grab a snack, relax & network, have access to special giveaways and speak with Anchorage AEYC board & conference members. Convince a friend to become a member and receive an extra door prize ticket!	
7:30-2:55	SILENT AUCTION	Lobby down from Registration
	Participate in the silent auction. Not only will you come away with terrific items, you will be giving someone else the opportunity to attend the conference in the future. Proceeds support Anchorage AEYC scholarships fund.	
7:30-8:00	CONTINENTAL BREAKFAST	Alaska
	Assorted muffins, juice, coffee and teas	
8:00-9:30	OPENING GENERAL SESSION	Aleutian/Alaska
	KEYNOTE: Holly Elissa Bruno Learning from the Bumps in the Road: Turning potholes into grand possibilities	
	We all hit bumps in our road. As we choose "the path less traveled by", we can't always see what lies ahead. When we trip, what matters is how we pick ourselves up, learn, grow and make things right. Bumps can be painful; failure can be devastating. But, without trying and failing, how can we learn? Let's practice strategies to help us regain our footing, reclaim our confidence, rekindle our joy and humor, and turn potholes into grand opportunities.	
8:45-11:45	SEMINAR SESSION	
9:45-11:45	SEMINAR SESSION	
11:45-1:15	LUNCH ON SITE	Aleutian/Alaska
	Lunch included in Conference Registration Fee Menu: Beef Taco Bar, chicken fajitas, three cheese quesadilla, Mexican rice & three bean Cowboy beans, cheeses, desserts, coffee/tea	
1:15-3:00	WORKSHOP SESSIONS	
3:15-4:45	WORKSHOP SESSIONS	

Saturday: SESSIONS-AT-A-GLANCE

NAEYC STANDARD	LEVEL	AGE GROUP	WORKSHOP TITLE & DESCRIPTION	PRESENTER(S)	CAPACITY	ROOM
Saturday, January 28th 9:45-3:00						
			Anchorage AEYC, AEYC-Southeast & Northern Interior AEYC Meeting	Anna Castillo, Facilitator	18	Prince William
Saturday, January 28th 9:45-11:45						
Leadership & Management	Valuable to All	All	Managing power dynamics when women work with women In predominantly female organizations, marvelous dynamics evolve: support, humor, and creativity. However, our research shows that 68% of early childhood professionals also experience gossip, negativity, back-biting and sabotage at work. Children mimic our behavior. For their sake and ours, we need proven strategies and policies to lead an uplifting transformation at work. Let's replace indirect manipulation with respectful communication.	Holly Elissa Bruno, Educator, International Keynote Speaker Fitchburg, Massachusetts www.hollyelissabruno.com	100	Denali
Teaching	Established Professionals	Birth-3, 3-5	In the Face of Change: When Parents are Concerned about Emerging Pre-Reading Skills, Knowing a Little Brain Science can Help. Learn a little reading science to answer parent's questions about pre-reading and literacy skill development. Learn why there are reasons when parents ask these questions. The goal is to provide teachers and caregivers important updates about the scientific building blocks of pre-reading skills, including sounds, print awareness, letter writing and identification. Let's identify reading science to support your answers. How can you offer effective strategies to promote pre-reading skills to maximize children's learning and minimize the risk of reading failure? Do learning styles matter? Is good pre-reading instruction good pre-reading instruction? We hope to share some scientific answers with you.	Posie Boggs, Dyslexia Specialist, Connections that Work, LLC Anchorage, Alaska connectionsthatwork@gci.net	50	Katmai



Saturday: SESSIONS-AT-A-GLANCE

NAEYC STANDARD	LEVEL	AGE GROUP	WORKSHOP TITLE & DESCRIPTION	PRESENTER(S)	CAPACITY	ROOM
Saturday, January 28th 9:45-11:45						
Families	Experienced Professionals	Birth-3, 3-5, Adults	Flourishing Families: Exploring Service Components for Children Exposed to Intimate Partner Violence See Description on page 14. This session is a repeat of Thursday's presentation, 9:45-11:45, King Salmon Room	Randy R. Ashford, MS, LPC Clinician/Consultant Alaska Child Trauma Center Anchorage, Alaska rashford@acmhs.com	80	King Salmon
Health	Valuable to All	3-5	Cultivating Mathematical Thinking in Young Children Cultivating Mathematical thinking in preschool children allows them to explore and understand the components of mathematics; geometry and spatial awareness, numbers and operations, measurement, data collection and analysis, and patterns. In this hands on workshop participants become familiar with each of the components of Math and while interacting with Mathematical materials, learn how to intentionally and purposefully plan for children's mathematical learning. (The information shared during this workshop aligns with the Early Head Start and Head Start "High Five Mathematics" Resource Guide)	Cathy Cole, National Early Childhood Specialist for Kaplan Early Learning Company Riddle, Oregon www.kaplanco.com	50	Aspen
Physical Environment	Established Professional	All	Introduction to Environment Rating Scales This training is Part I of a 3 part series. Part I is designed to provide you with an overview of the Environmental Rating Scale tools, their purpose and a brief description of their scoring procedures. Part II of this training will be offered in the afternoon sessions where providers can gain hands on experience working with the tool specific to the age group you work with. Part I, II, & III are required for programs working on Level 2 of Learn & Grow. Part III is a self-assessment and providers can obtain additional CDA hours if self-assessment is completed and turned in within 2 weeks of the conference.	Donna J. Wade, Director of Outreach & Program Expansion, thread Anchorage, Alaska dwade@threadalaska.org	50	Spruce
Curriculum	Emerging Professionals	5-8	Village Math & Science Activities for the Early Childhood Classroom (K-3) Join us as we examine and create five (5) take home Village Math and Science Activities for the Early Childhood Classroom. There will be "mini-lesson plans" for each activity. This is a hands-on workshop for emerging professionals. All activities have been derived from Alaskan Native Students in the Paraprofessional Program at Alaska Christian College. This workshop will aim to satisfy many of the objectives of the Alaskan Early Childhood Guidelines Domain 3, 4, and 5 along with Alaska State Content Standards for K-3 Math.	Katie Olson, Assistant Professor, Chair of Paraprofessional Ed Alaskan Christian College Soldotna, Alaska kolson@alaskacc.edu	50	Birch
Teaching 	Established Professional	3-5	Guiding Children through Play We will explore the intentional practice of incorporating play in early childhood classrooms to support children develop self-regulation, promote language skills, cognition, and social competence. Play helps children develop life long skills and if it is absent can result in incomplete development. When children explore their physical and social world through play they naturally gather information, discover and become a part of the creative process.	Vanessa Plourde-Smith, Professional Development Specialist thread Anchorage, Alaska vsmith@threadalaska.org	50	Willow

Shhhhhh!

Please Be Courteous
It's wonderful to catch up with colleagues
but please not while
speakers are addressing the group.



Saturday: SESSIONS-AT-A-GLANCE

NAEYC STANDARD	LEVEL	AGE GROUP	WORKSHOP TITLE & DESCRIPTION	PRESENTER(S)	CAPACITY	ROOM
Saturday, January 28th 9:45-11:45 (continued)						
Leadership & Management	Established Professionals	All	Introduction to Learn & Grow: Alaska's Quality Recognition & Improvement System (QRIS) Learn & Grow is Alaska's Quality Recognition & Improvement System. This Level 1 Training is a requirement of Level 1 Quality standards. This session will provide you with an overview of Learn & Grow; Program Requirements; Personnel Requirements; What supports and other resources are available for programs to stay actively engaged in continuous quality improvement. This session is a repeat of Thursdays, 9:45-11:45 presentation, Birch Room	Meghan Johnson, QRIS Director thread Anchorage, Alaska mjohnson@threadalaska.org	70	Fireweed
Teachers	Established Professionals	All	Introduction to Alaska Early Care and Learning Core Knowledge and Competencies Come learn the purpose of the Early Care and Learning Core Knowledge and Competencies; How they are structured and how they can be used to support your ongoing professional development. This training is required of lead teachers and administrators who are working on achieving Level 2 requirements of Learn & Grow. This session is a repeat of Thursdays, 9:45-11:45 presentation, Willow room.	Pili Queja, Professional Development Specialist thread Anchorage, Alaska pqueja@threadalaska.org	60	Lupine

There is No Such Thing as Bad Weather

"In my native country of Sweden, people live by the old Scandinavian saying, "There's no such thing as bad weather, only bad clothes," and dressing for the weather is akin to a national sport. This is especially true when it comes to children, who are expected and encouraged to play outside regardless of the weather. Although Sweden is spared from tornadoes, hurricanes and extreme heat, winters can be brutally long and the rainfall epic. Rather than waiting for the weather to improve (which could potentially lead to long-term hibernation), harsh or unfavorable conditions usually mean business as usual in Sweden. And yes, kids still play outside — spring, summer, fall, winter," writes Linda McGurk, aka the **Rain or Shine Mamma**.



McGurk believes that children who spend time outdoors year round.....

- Become resilient
- Experience the uniqueness of each session
- Are physically active
- Are prepared for challenging conditions
- Learn to find joy in nature



Saturday: SESSIONS-AT-A-GLANCE

NAEYC STANDARD	LEVEL	AGE GROUP	WORKSHOP TITLE & DESCRIPTION	PRESENTER(S)	CAPACITY	ROOM
Saturday, January 28th 1:30-4:45						
Teaching	Emerging & Established Professional	All	Maximizing Learning Through Music Do you want to maximize student learning and help them have fun while learning? If you do, then join us as we sing, chant, and make music while learning important information and concepts! Children of all ages really respond to music, to body movement, and to the use of musical instruments while they sing and chant content and concepts. If you think you are not very musical, come and find out that you are more musical than you ever believed and that you will be able to help children enjoy learning, too, through the medium of MUSIC. We will be using songs, chants, various tonal and rhythm instruments and show how the body movements and repetition help children develop language and concepts in various content areas.	Alice Wright Belden, Author & Musician LaVon Bridges, ELL Program Specialist, Musician, Anchorage Education Ctr, ASD Anchorage, Alaska Alice9_19_39@yahoo.com Bridges_LaVon@asdk12.org	100	Aleutian
Teaching	Emerging Professionals	All	Tots in Nature: Understanding and Coping with Change This session demonstrates how teaching with nature based curriculum can help children understand change and develop coping skills in the face of life's changes and challenges.	Brenda Duty, Project WILD & Youth Ed Coordinator Valene Ziegler, ADFG Facilitator Alaska Dept. of Fish & Game, Anchorage, Alaska Brenda.duty@alaska.gov	60	King Salmon
Relationships	All	3-5	Promoting Learning through Healthy Minds & Bodies Exercise has many positive effects on both young children's minds and bodies. As a child exercises, the flow of blood to the brain increases which heightens a child's alertness and mental focus as well as increases a child's strength, flexibility and endurance. In this interactive workshop working with materials such as exercise balls, music, streamers, participants discover how to provide activity based learning to support and complement any nutrition and fitness curriculum; and understand how to extend such activities for math, science and literacy	Cathy Cole, National Early Childhood Specialist for Kaplan Early Learning Company Riddle, Oregon www.kaplanco.com	50	Aspen
Physical Environment	Established Professional	All	Using the Environment Rating Scales (FCCERS) Part II This training is Part II of a 3 part series specifically for use of the FCCERS tool. Part I: Introduction to the ERS was designed to provide you with an overview of the Environmental Rating Scale tools, their purpose and a brief description of their scoring procedures. Part II of this training provides teachers with hands on experience working with the tool specific to the age group you work with. There will be 3 separate rooms for Part II of this training (ITERS, FCCERS and ECERS-3). Part I, II, & III are required for programs working on Level 2 of Learn & Grow. Part III is a self-assessment and providers can obtain additional CDA hours if self-assessment is completed and turned in within 2 weeks of the conference.	Donna J. Wade, Director of Outreach & Program Expansion, thread Anchorage, Alaska dwade@threadalaska.org	50	Spruce



Help Anchorage AEYC Earn Donations Just By Shopping with Your Fred Meyer rewards Card!

Fred Meyer is once again in 2017 donating \$2.5 million per year to non-profits in Alaska based on where their customers tell them to give. Here's how the program works:

1. Sign up for the Community Rewards program by linking your Fred Meyer Rewards Card to **Anchorage Assn. for the Education of Young Children** at www.fredmeyer.com/communityrewards. You can search for us by our name or by our non-profit number #92524.
2. Then, every time you shop and use your Rewards Card, you are helping Anchorage AEYC earn a donation!
3. You still earn your Rewards Points, Fuel Points, and Rebates, just as you do today.
4. If you do not have an Rewards Card, they are available at the Customer Service Desk at any Fred Meyers Store.
5. For additional information visit: www.fredmeyer.com/communityrewards

Thanks for supporting Anchorage AEYC!

Saturday: SESSIONS-AT-A-GLANCE

NAEYC STANDARD	LEVEL	AGE GROUP	WORKSHOP TITLE & DESCRIPTION	PRESENTER(S)	CAPACITY	ROOM
Saturday, January 28th 1:30-4:45						
Physical Environment	Established Professional	All	Using the Environment Rating Scales (ITERS) Part II This training is Part II of a 3 part series specifically for use of the ITERS tool. Part I: Introduction to the ERS was designed to provide you with an overview of the Environmental Rating Scale tools, their purpose and a brief description of their scoring procedures. Part II of this training provides teachers with hands on experience working with the tool specific to the age group you work with. There will be 3 separate rooms for Part II of this training (ITERS, FCCERS and ECERS-3). Part I, II, & III are required for programs working on Level 2 of Learn & Grow. Part III is a self-assessment and providers can obtain additional CDA hours if self-assessment is completed and turned in within 2 weeks of the conference.	Tracey Adams, Professional Development Specialist, thread Anchorage, Alaska tadams@thrivealaska.org	50	Fireweed
Physical Environment	Established Professional	All	Using the Environment Rating Scale (ECERS) Part II This training is Part II of a 3 part series specifically for use of the ECERS-3 tool. Part I: Introduction to the ERS was designed to provide you with an overview of the Environmental Rating Scale tools, their purpose and a brief description of their scoring procedures. Part II of this training provides teachers with hands on experience working with the tool specific to the age group you work with. There will be 3 separate rooms for Part II of this training (ITERS, FCCERS and ECERS-3). Part I, II, & III are required for programs working on Level 2 of Learn & Grow. Part III is a self-assessment and providers can obtain additional CDA hours if self-assessment is completed and turned in within 2 weeks of the conference.	Reanne Queja Professional Development Specialist, thread Anchorage, Alaska rqueja@threadalaska.org	50	Lupine



for families



NAEYC For Families

Research-based tips and ideas on children's learning & development families can trust and much, much more. The source for your family engagement needs.



Photo credit: Inesme/Fulvia Farasino

families.naeyc.org

Families Today



Learning & Development

The meaning behind young children's

Saturday: SESSIONS-AT-A-GLANCE

NAEYC STANDARD	LEVEL	AGE GROUP	WORKSHOP TITLE & DESCRIPTION	PRESENTER(S)	CAPACITY	ROOM
Saturday, January 28th 1:30-3:00						
	Valuable to All	All	Underdog or top dog: How do you define and measure your own success? What will your signature legacy be? How can you triumph over the limited understanding many have of our profession? Will you be underdog or top dog in having a professional impact? How much of your success will be measured from the outside in versus the inside out? Prepare to stake a claim to how you will make a signature difference regardless of restrictive views by others of our profession.	Holly Elissa Bruno, Educator, International Keynote Speaker Fitchburg, Massachusetts www.hollyelissabruno.com	100	Denali
Teaching	Emerging Professionals	Birth-3	Discipline for Babies? Really? Yes! Developmental discipline is about teaching, not punishing. This session gives specific strategies for newborns, non-mobile and mobile babies as well as toddlers. Handout includes guidance ideas for every age and how to work with babies who are biting. Patty Meritt is co-author of Constructive Guidance & Discipline and Professor of Early Childhood Education at UAF.	Patty Meritt, Author Professor of Early Childhood, UAF Fairbanks, Alaska pameritt@alaska.edu	80	Katmai
Teaching	Emerging Professionals	3-5	Literacy in Early Years: How to Help Foster a Love of Reading When reading a book, is there no interest from the children? Do the books go untouched for days? Is there a child struggling with communication? Are you trying to find ways to incorporate books with activities? There is an answer and it revolves around literacy. Literacy is a developmental building block. It helps with verbal communication, written language, and the ability to understand others. As educators and parents, we can help build up a child's language and foster a love of reading. Come learn about the importance of literacy for young children and some new techniques and ideas for incorporating books at home and in the classroom. This session is a repeat of Thursdays, 1:30-3:00 presentation in the Katmai room.	Heather Plumb, Home Visitor CCS Early Learning Wasilla, Alaska hplumb@ccsalaska.org	50	Iliamna
Teachers	Established Professionals	5-8	Using Shared Reading Practices to Support Multilingual and Diverse Learners This presentation will enhance participant's understanding of shared reading practices with a focus on how repeated shared book readings can have a powerful impact on children's early literacy skills, particularly for those from multilingual and diverse backgrounds. Join us in learning how to enrich classroom conversations, expand vocabulary, and enhance comprehension skills using diverse and multilingual texts both in the classroom and in the home as we answer questions around why shared reading is good for children; why we should use repeated book readings in the classrooms, and how families can incorporate shared reading into their daily lives.	Nina Lee, Research Assistant, UAA Cambria Houtte, Research Assistant, UAA Dr. Kathryn Ohle, Assistant Professor of Early Education, UAA Anchorage, Alaska njlee@alaska.edu choutte@alaska.edu kohle@alaska.edu	50	Birch
Teaching 	Emerging Professionals	3-5 5-8	I Didn't Know These Could be Fun (Transitions) Come learn fun and exciting ways to navigate the various transitions that children experience in program. Transitioning from one activity to another or going outside does not have to be a strenuous task. They can be fun, exciting and a teacher's favorite part of the day.	Pili Queja Professional Development Specialist, thread Anchorage, Alaska pqueja@threadalaska.org	50	Willow



Many thanks
 to
Starbright Early Learning Center Children
 &
Debbie Houseman
 for the very creative table decorations!

Saturday: SESSIONS-AT-A-GLANCE

NAEYC STANDARD	LEVEL	AGE GROUP	WORKSHOP TITLE & DESCRIPTION	PRESENTER(S)	CAPACITY	ROOM
Saturday, January 28th 3:15-4:45						
Teaching	Valuable to All	3-5	Up, Up, and Away with Parachute Play New and seasoned educators will learn how to incorporate parachute play into their classrooms daily routine. The parachute is a limitless tool that can encourage and build a plethora of skills. This session a repeat of the Friday session, 3:15-4:45 in the Denali room.	Paige Chase, Associate Educator, Bridget Kelly, Family Educator, CCS Early Learning, Chugiak, AK pchase@ccsalaska.org bkelly@ccsalaska.org	100	Denali
Curriculum	Emerging Professionals	Birth-3	Active Infants, Enjoying the Senses through Play In this hands-on workshop we will explore various ways to safely incorporate art and sensory play into the infant's day. There will be a hands-on activity to try, with examples of how to differentiate the activity for the many ages and levels in an infant classroom. This session is a repeat of Friday's session, 3:15-4:45, King Salmon room.	Rebecca Larson, Child Development Assistant, Kids' Corps, Inc. Anchorage, Alaska rebecca.larson@kcialaska.org	80	Katmai
Assessment of Child Progress	Established Professional	All	The JournEy Portfolio: Using Authentic Assessment Systems UAA Students and Faculty have been partnering with K-1 classrooms at Polaris to document children's learning. Come learn about the process of collecting items for an ePortfolio and the JournEy.	Hilary Seitz, Professor of Early Childhood Jaime Whitney, UAA Early Childhood Student, Marissa Ridgley, UAA Early Childhood Student, Noel Bowe, UAA Early Childhood Student, University of Alaska, Anchorage hseitz@alaska.edu jmwhitney@alaska.edu nmbowe@alaska.edu msridgley@alaska.edu	50	Iliamna
Health	Emerging Professionals	3-5	Health Heroes to the Rescue! Come learn child-friendly nutrition, oral and physical health activities to do in a classroom or on home visits. Resources will be provided to take home and introduce to others. We will show you how to connect health with many other areas including science, math and literature to create lasting, healthy behaviors. We will make a fun snack so be ready to come and get active! This session is a repeat of Friday's session, 1:30-3:00, Birch room.	Kelsey Beecher, Health & Nutrition Coordinator & Ayla Richardson, Health Assistant Kids' Corps, Inc. Anchorage, Alaska Kelsey@kcialaska.org	50	Birch
Relationships 	Valuable to All	Birth-3, 3-5, 5-8, 8-12	Positive Ways to Support Social and Emotional Development: Effectively Guiding Children's Behavior While there is no magic wand to make challenging behaviors disappear, this session will explore the meaning behind challenging behaviors; and reflect on approaches we can use to cultivate a place in which young children flourish emotionally and intellectually through the use of positive behavior supports.	Lisa Marie McCutcheon Professional Development Specialist, thread Anchorage, Alaska lmccutcheon@threadalaska.org	50	Willow

Tell us what you think!



Conference Evaluation Questionnaire

Please remember to complete the
2017 Conference Evaluation Questionnaire
 which will be sent to you
ELECTRONICALLY
 the week following the conference.

Thanks!

Exclusive Materials Designed by Teachers for Teachers!



Rigorous safety standards

that exceed the requirements of U.S. law

In stock & ready to ship

direct from Lakeshore

Lifetime warranty

on all furniture lines



Free resources at LakeshoreLearning.com

lesson plans, printables, crafts & more!

Lakeshore®



LakeshoreLearning.com

Exhibitors

Exhibit Hours:

Thursday 7:30 am-4:45 pm
Friday 7:30 am-4:45 pm
Saturday 7:30 am-4:45 pm

Anchorage AEYC

Wade Bertrand & Jessica Gardner, Co-Presidents
 Phone: (907) 696-5884
 Email: anchorageaeyc@mtaonline.net
 Web Site: www.anchorageaeyc.org



Arctic Mermaids Studios

Melody Beachem
 Phone: (913) 704-9784
 Email: arcticmermaidsstudio@gmail.com



Denali Parent Coaching, LLC

Alice Hanscam
 Phone: (907) 868-6933
 Email: denaliparentcoaching@gmail.com
 Web Site: www.denaliparentcoachig.com

Eddie Wood

Eddie Wood
 Phone: (907) 235-6160
 E-mail: rumbalaska@yahoo.com

Kaplan

Pam Tester
 Phone: (800) 334-2014, ext 6122
 E-mail: ptester@kaplanco.com
 Web Site: www.kaplanco.com



Kids' Corps, Inc.

Katrina Ahfield
 Phone: (907) 279-2021
 Email: info@kcialaska.org
 Web Site: www.kcialaska.org



Lakeshore

Brian Kenneweg
 Phone: 1-800-421-5354
 Email: bkenneweg@lakeshorelearning.com
 Web Site: www.lakeshorelearning.com



thread

Stephanie Berglund, CEO
 Phone: (907) 265-3100
 Email: info@threadalaska.org
 Web Site: www.threadalaska.org



UAF Community & Technical College—Early Childhood Education

Kelly Jo Peissner
 Phone: (907) 455-2842
 E-mail: Kjpessner@alaska.edu
 Website: www.ctc.uaf.edu

UAA College of Education

Carrie Ziokowski
 Phone: (907) 786-4516
 E-mail: cbziolkowski@alaska.edu
 Web Site: www.uaa.alaska.edu/COE

Waitlist Transparency

Kyndall Carey
 Phone: (907) 830-1409
 E-mail: Info@waitlistTransparency.com
 Website: www.WaitlistTransparency.com

Conference bags provided by:

THE UNIVERSITY OF
ALASKA
 COLLEGE
 SAVINGS PLAN

Stylus pens provided by:



Flowers provided by:



Notes



Name: _____

Hilton Anchorage—Main Level



**Don't leave home
without this program &
your name badge!**

**Your name badge
allows you into sessions and
lunch!**

LOBBY LEVEL

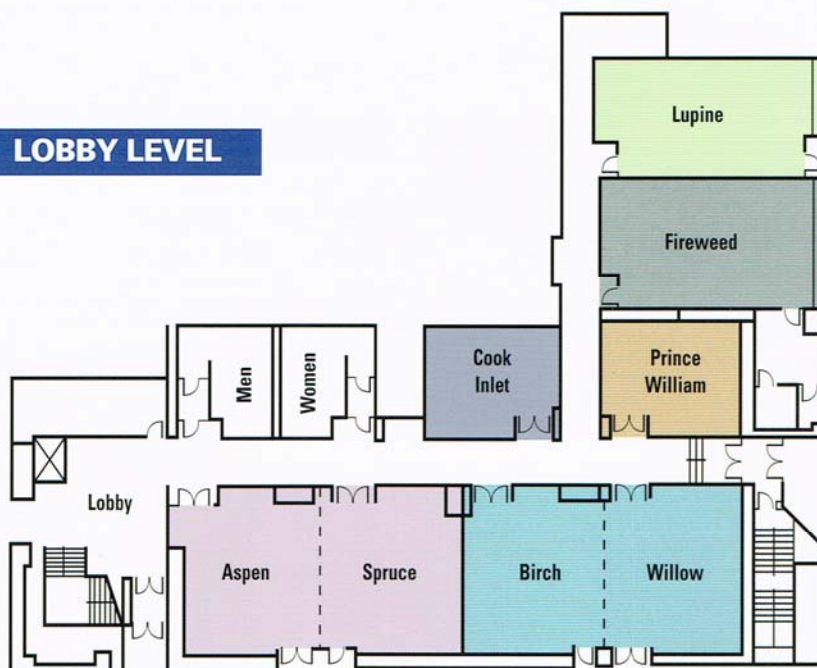

West Tower

SECOND FLOOR

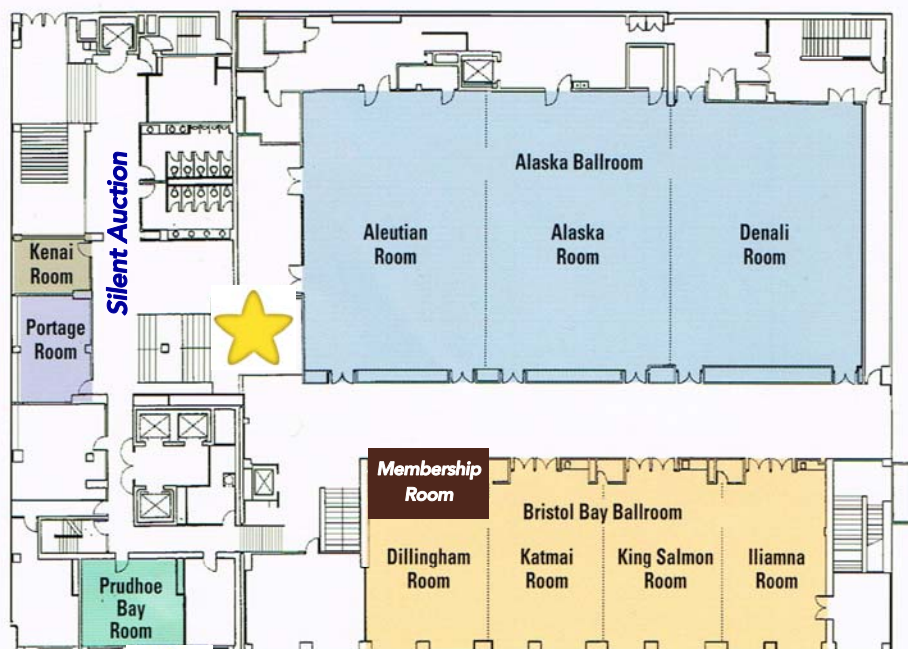

FIFTEENTH FLOOR



Registration Desk

Printing by Alaska Laser Printing and Mailing Services (907) 561-8000